

DRURYS RUN LOT N^o 59
 RENOVO BORO. - CLINTON COUNTY - PA.
 SOLD TO
 FRED W. SORGEN

REFERENCE DATA

NORTH AMERICAN REFRACTORIES CO.
 1012 NATIONAL CITY BANK BUILDING
 CLEVELAND, OHIO

ENV. No.

SHEET No.

40-3-42

SCALE 1" = 50 FT.

JUNE 8, 1939.

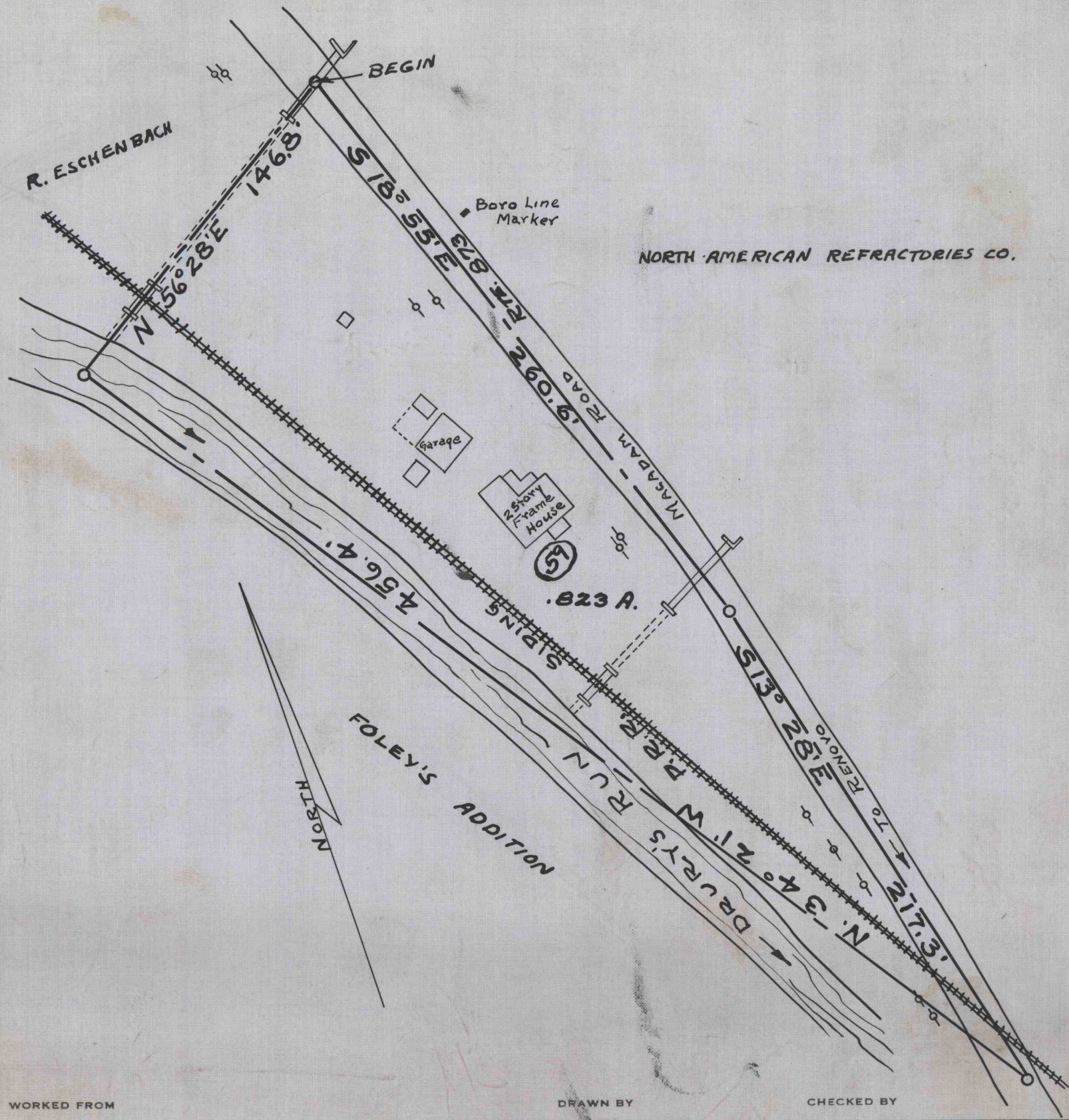

WORKED FROM

DRAWN BY

CHECKED BY