

MAP
 SHOWING PROPERTY LINES AND BUILDINGS OF
QUEENS RUN FIRE BRICK Co.

ON WEST WATER ST. LOCK HAVEN Pa.
 SCALE SURVEYED OCT. 16, 1912.
 30 FT To 1 Inch. CHAS. E. BALL
 Civil Engineer

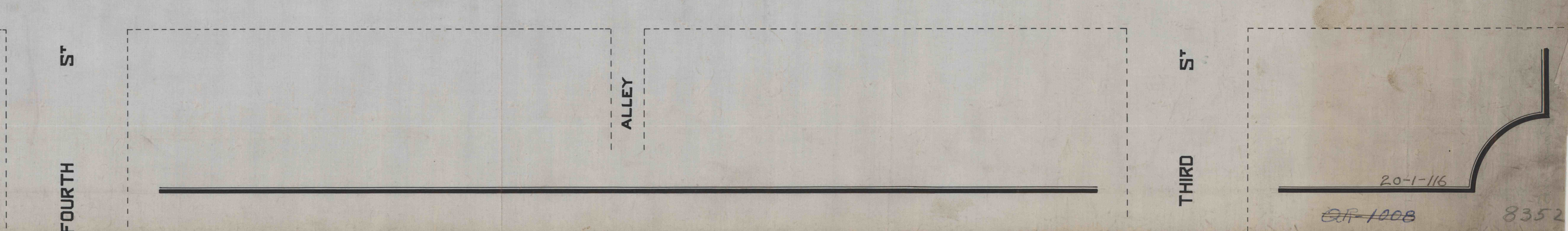
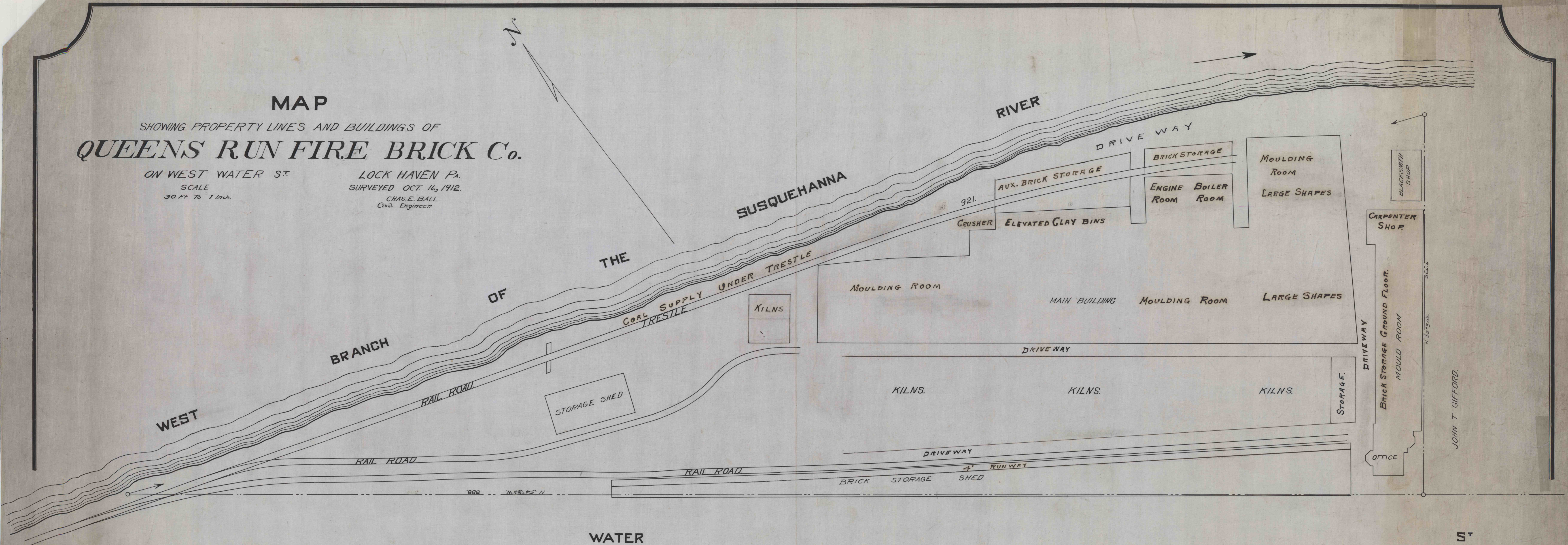

JOHN T. GIFFORD.