

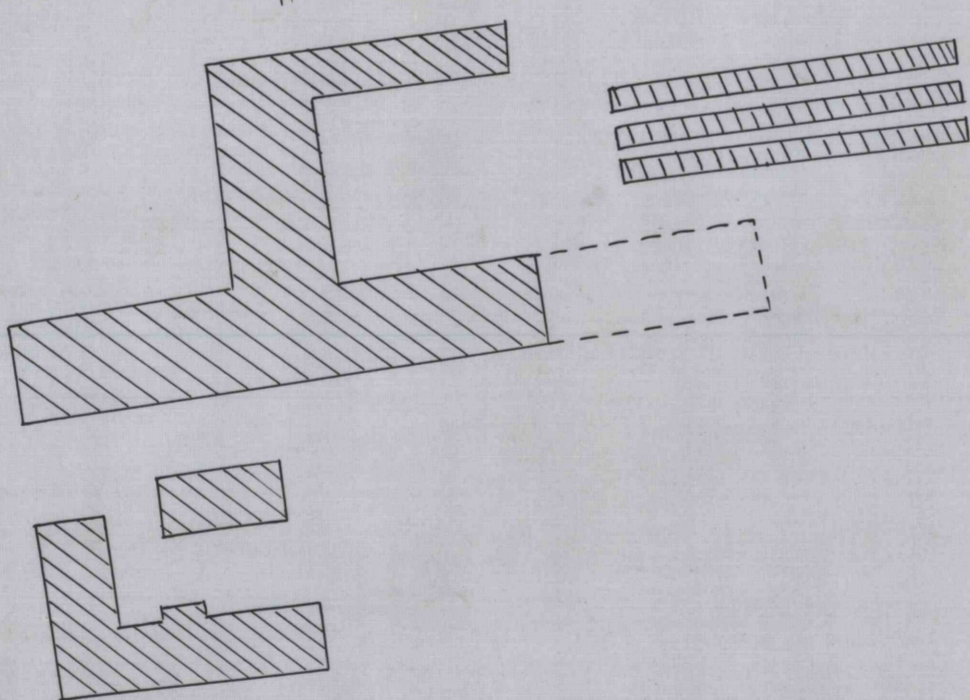

PLAT OF  
**EASTVU**  
 CURWENSVILLE BORO, PA.  
 PROPERTY OF  
 S.D. Griffith AND C.C. McGee  
 Scale 1 in. = 200 ft. May 1911  
 C.C. McGee C.E.



NORTH AMERICAN REFRACTORIES CO.  
 1012 NATIONAL CITY BANK BUILDING  
 CLEVELAND, OHIO

PLAT OF  
**EASTVU**  
 CURWENSVILLE BORO, PA.  
 CLEVERFIELD CO., PA.

SCALE 1" = 200'  
 DATE 5-5-11  
 DRAWN BY G.A.  
 CHECKED BY G.A.  
 REFERENCE 50-3-1230

20-3-1530

20-3-1530

20-3-1530