

41-2-57
9002

MAP OF THE REED ADDITION

BELONGING TO
G. L. REED,
CLEARFIELD, PA.

SCALE 1"=200' 1901
J. J. Miller, E.M.
Clearfield, Pa.

Revised by E.W. Hess, JUNE 1903.
COPIED AND ADDED TO - E.W.H. MAR 1908.

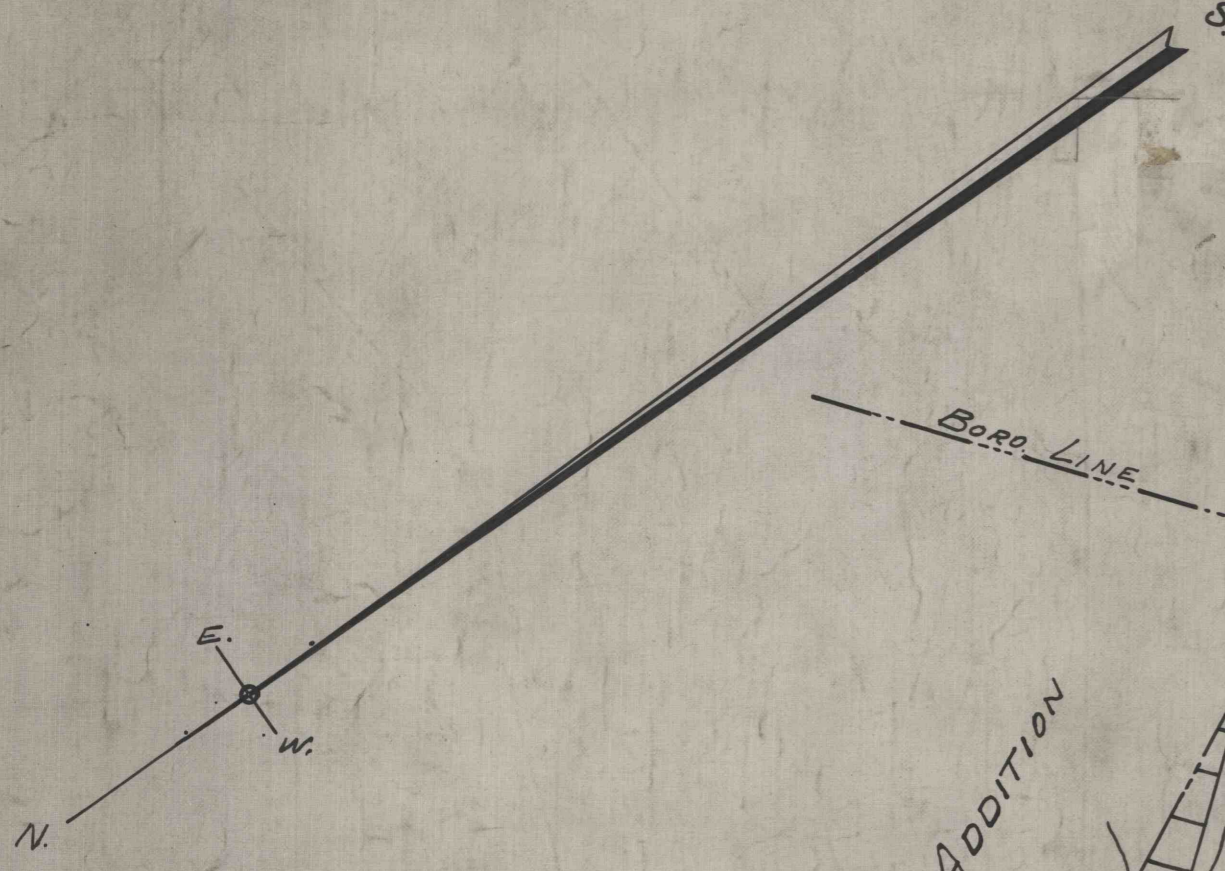

SCALE 1"=200 FT.

TOTAL AREA 111.9 A.S.
IN BOROUGH 15.8
IN TOWNSHIP 96.1

NORTH AMERICAN REFRACTORIES CO.
TOTAL AREA 22.75 A.S.

NORTH AMERICAN REFRACTORIES CO.
6.28 A.S.

NORTH AMERICAN REFRACTORIES CO.
13.0 A.S.

12 ACRES
LEASED TO THE
STANDARD BRICK
& TILE CO.

CLEARFIELD BRICK
MFG CO.

IRON
BRIDGE

STATE HIGHWAY 15 322

Clearfield River

RIVERVIEW
STATION

MINING RIGHTS
RELEASED TO REEDS

CLEARFIELD BOROUGH
LAWRENCE TOWNSHIP

J. MILLER SR.

W. POTTER

CLAWICH

ASCANICH J.M. MARSHALL

BLANCH

ST. CLAY

ST. CLAY

ST. CLAY

ST. CLAY

ST. CLAY

ST. CLAY

ST. CLAY

ST. CLAY

ST. CLAY

ST. CLAY

ST. CLAY

ST. CLAY

ST. CLAY

ST. CLAY

Betts Addition

Mitchell

Reed

JAMES MITCHELL

JAMES MITCHELL

CLEARFIELD BRICK
MFG CO.

IRON
BRIDGE

STATE HIGHWAY 15 322

Clearfield River

RIVERVIEW
STATION

IRON
BRIDGE