

PLAN OF PROPOSED RETAINING WALLS AND SIDE-WALK  
ALONG GRAMPIAN ROAD  
BORO. OF CURWENSVILLE PENNA.

SCALE - 1" = 50 FT Nov. 28, 1934.

DRAWING No 1.

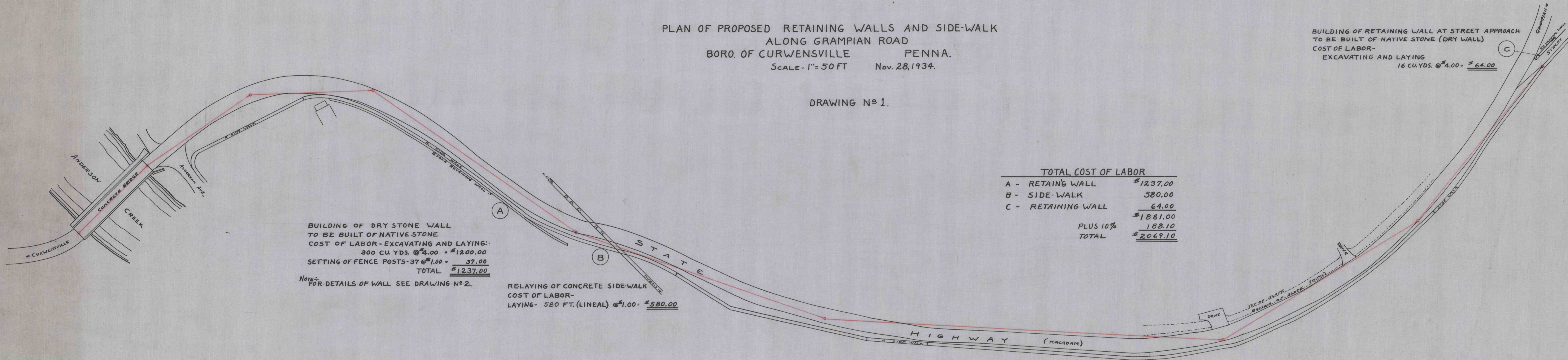

BUILDING OF DRY STONE WALL  
TO BE BUILT OF NATIVE STONE  
COST OF LABOR - EXCAVATING AND LAYING:-  
300 CU. YDS. @ \$4.00 = \$1200.00  
SETTING OF FENCE POSTS - 37 @ \$1.00 = 37.00  
TOTAL \$1237.00

Notes:-  
FOR DETAILS OF WALL SEE DRAWING No 2.

RELAYING OF CONCRETE SIDE-WALK  
COST OF LABOR -  
LAYING - 580 FT. (LINEAL) @ \$1.00 = \$580.00

TOTAL COST OF LABOR	
A - RETAINING WALL	\$1237.00
B - SIDE-WALK	580.00
C - RETAINING WALL	64.00
	<u>\$1881.00</u>
PLUS 10%	188.10
TOTAL	<u>\$2069.10</u>

BUILDING OF RETAINING WALL AT STREET APPROACH  
TO BE BUILT OF NATIVE STONE (DRY WALL)  
COST OF LABOR -  
EXCAVATING AND LAYING  
16 CU. YDS. @ \$4.00 = \$64.00