

Note - Approximate 4' Cut Present Ground to Sub-grade of tracks

+100% Proposed 24" Gauge Tracks

18" Brick Wall

15" Plant Wall

98.03
98.50 TR. #101st Track

(Level)
Proposed 2 Car Transfer

18" Brick Wall

Proposed 1 Car Transfer

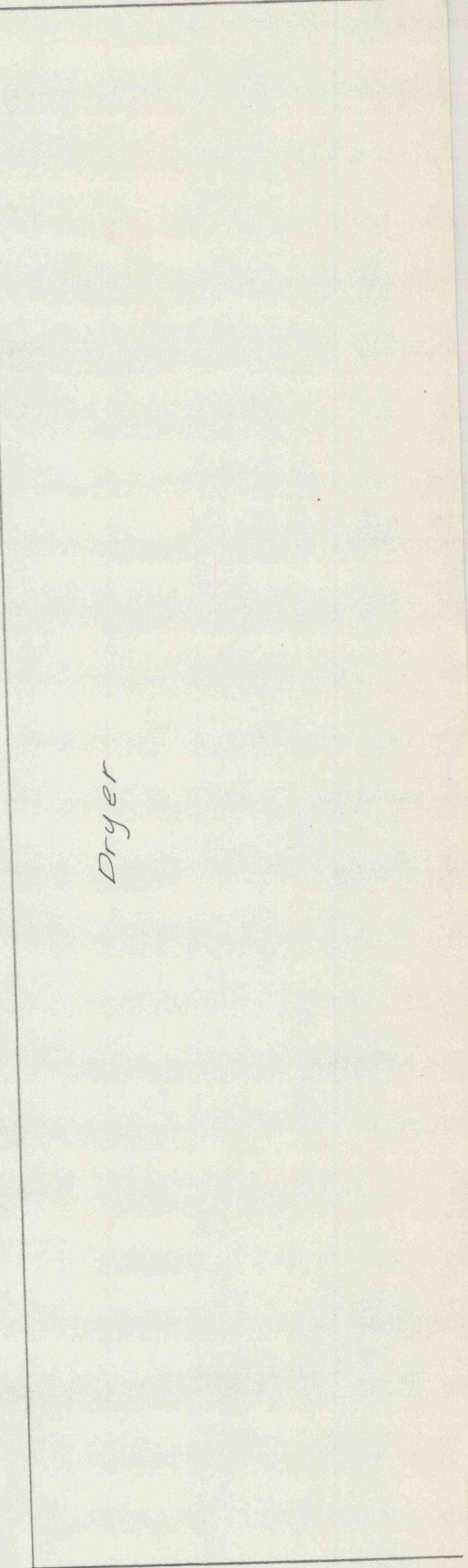
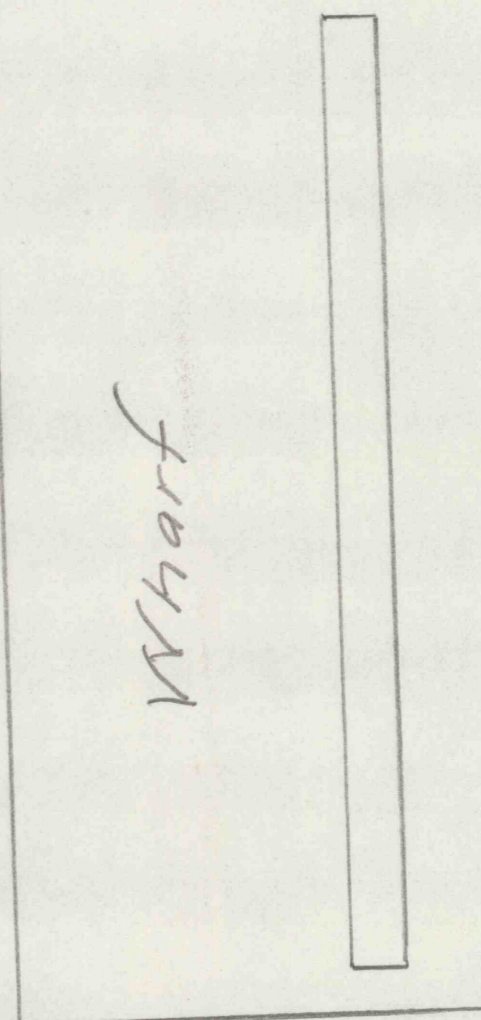
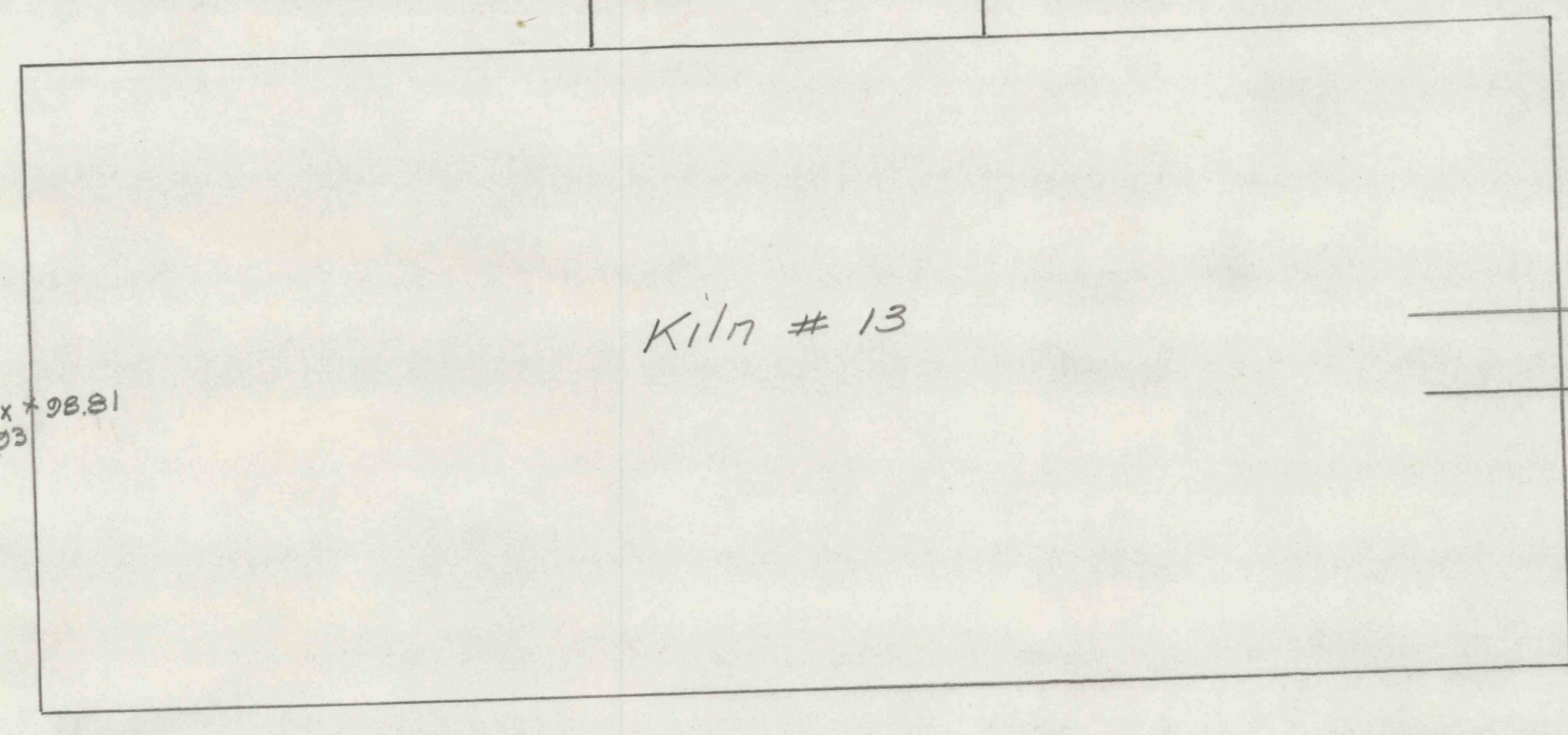
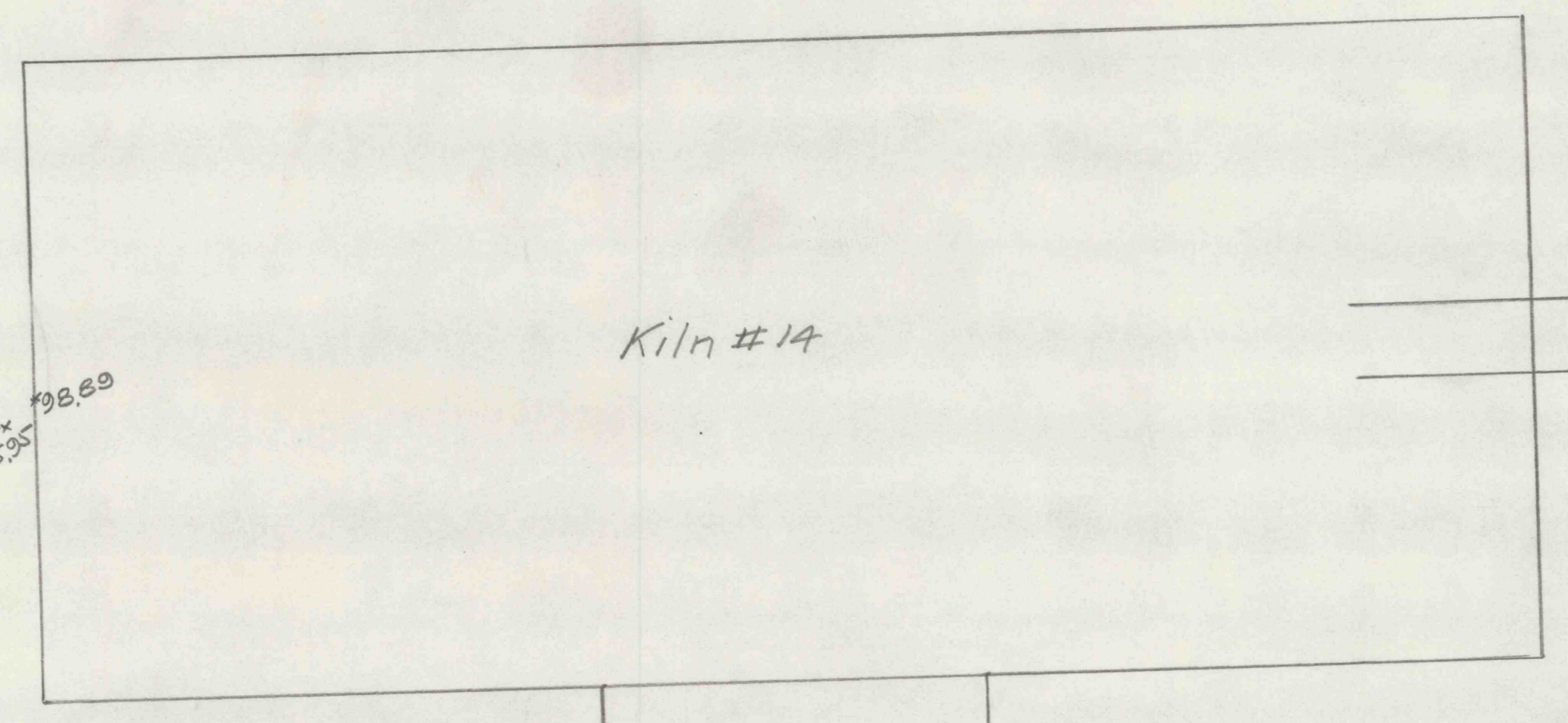
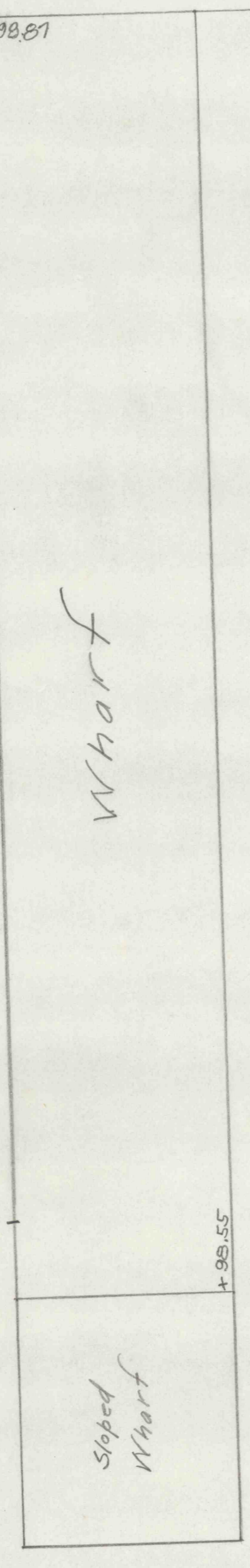
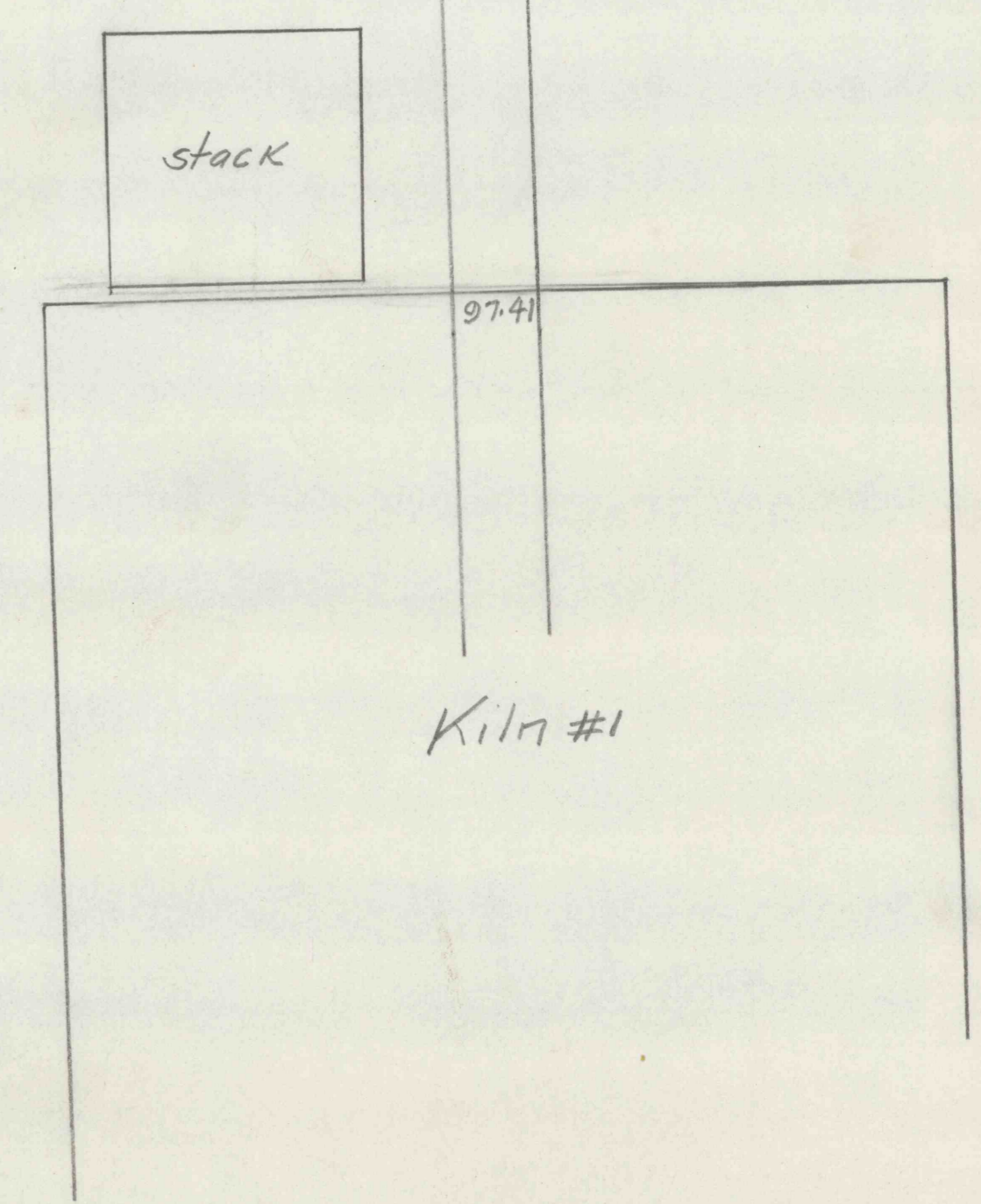
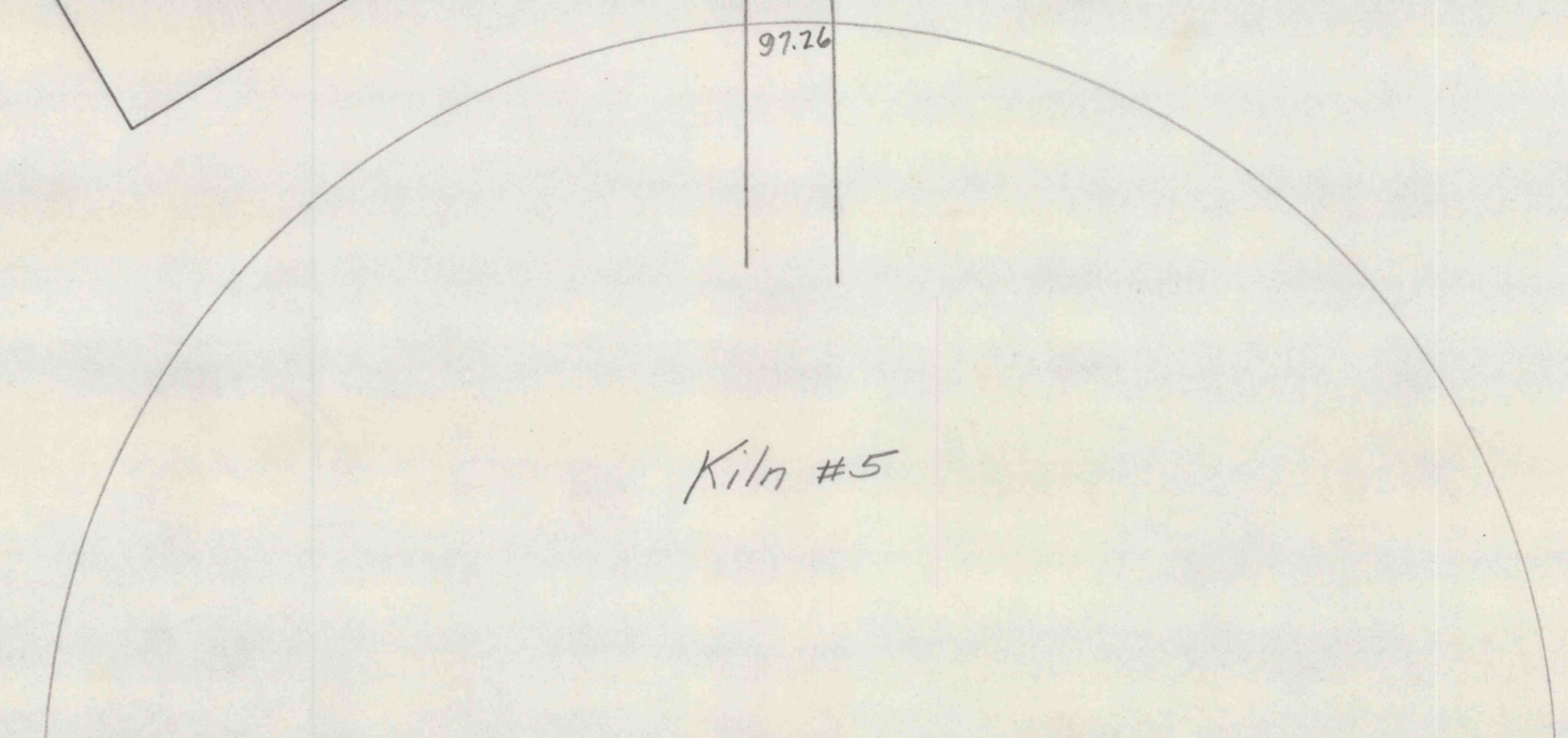
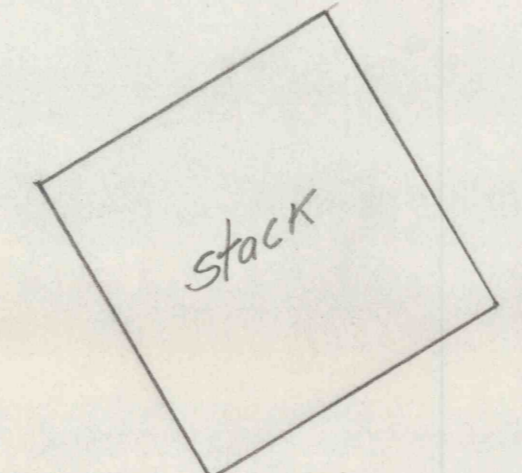
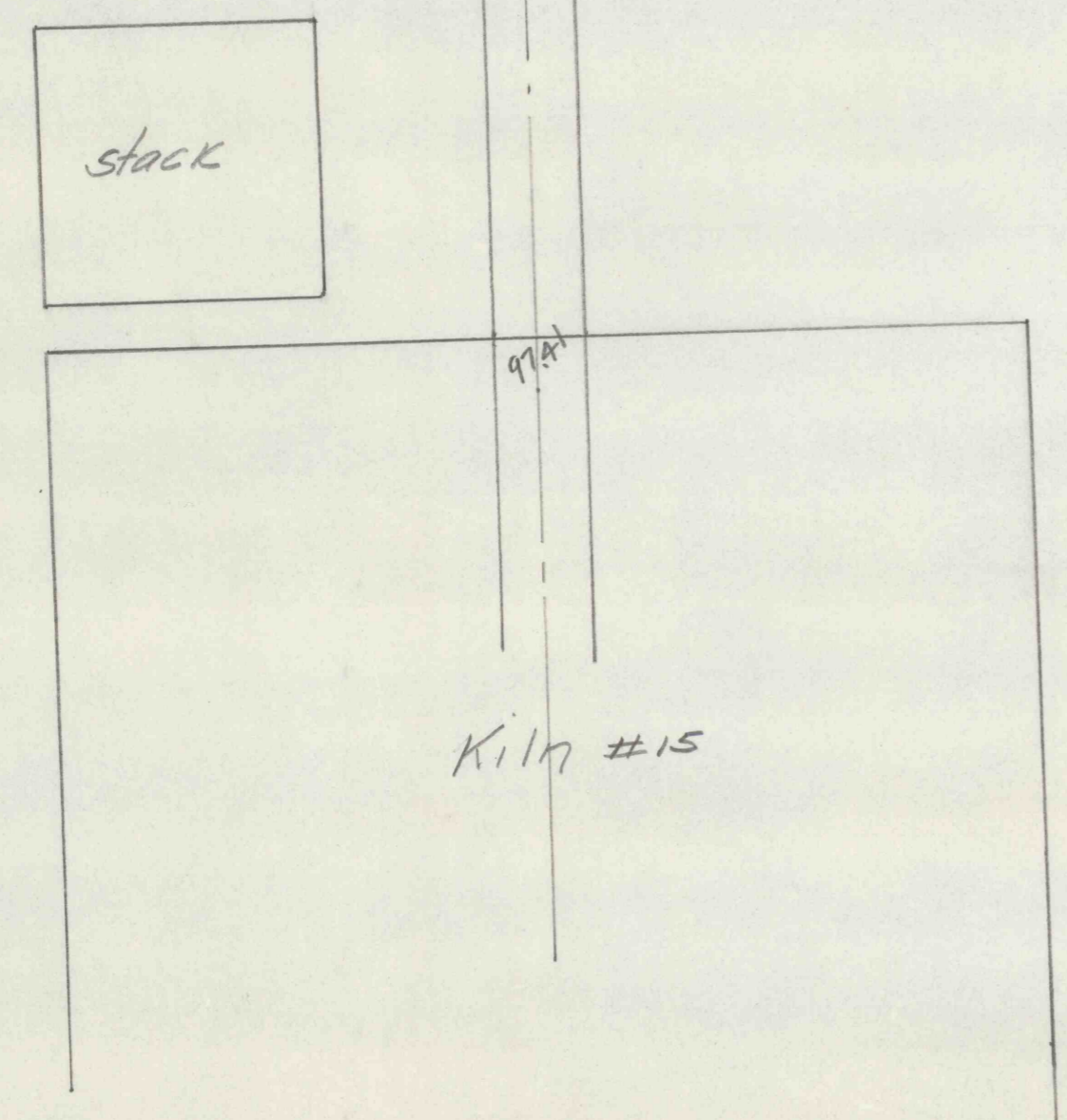
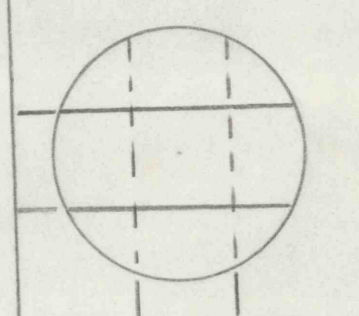
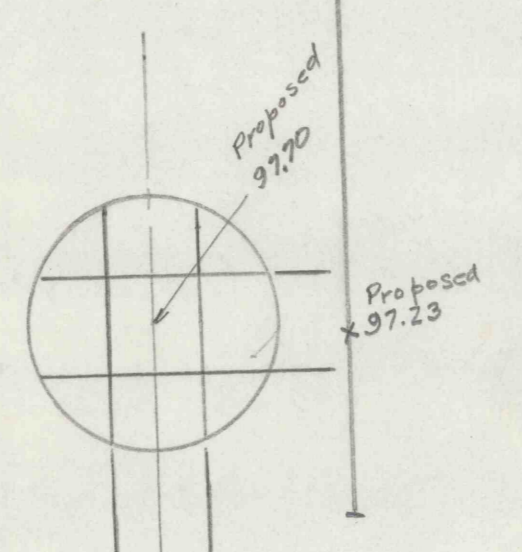
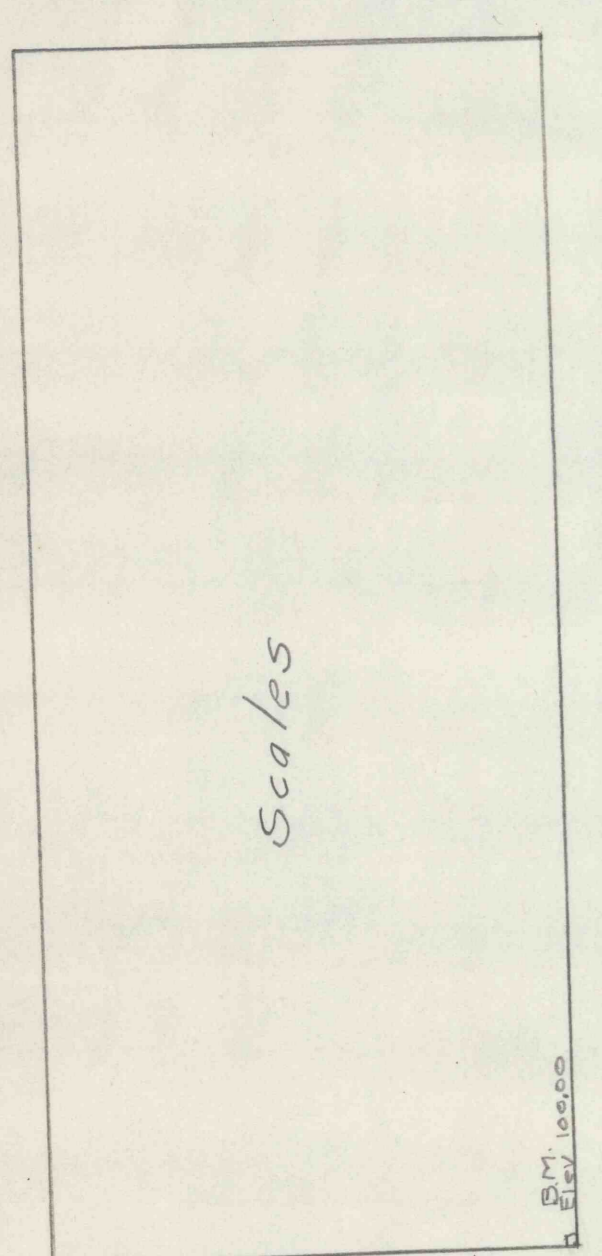

8" Plant Wall

1150' N

Plan #5 of
Service to New (#15) Kiln
Lumber City Plant
Scale 1" = 4'
INDEX No 55-1-480
Date - 3-23-48
Drawn - AEH Traced AEH
Checked - JKH