

NOTE: ELEVATION OF HOT FLOOR AT CENTER OF COLUMNS AT NO. 2 PAN - 1167.58
ELEVATION, FLOOR OF STOCK BINS - 1173.06

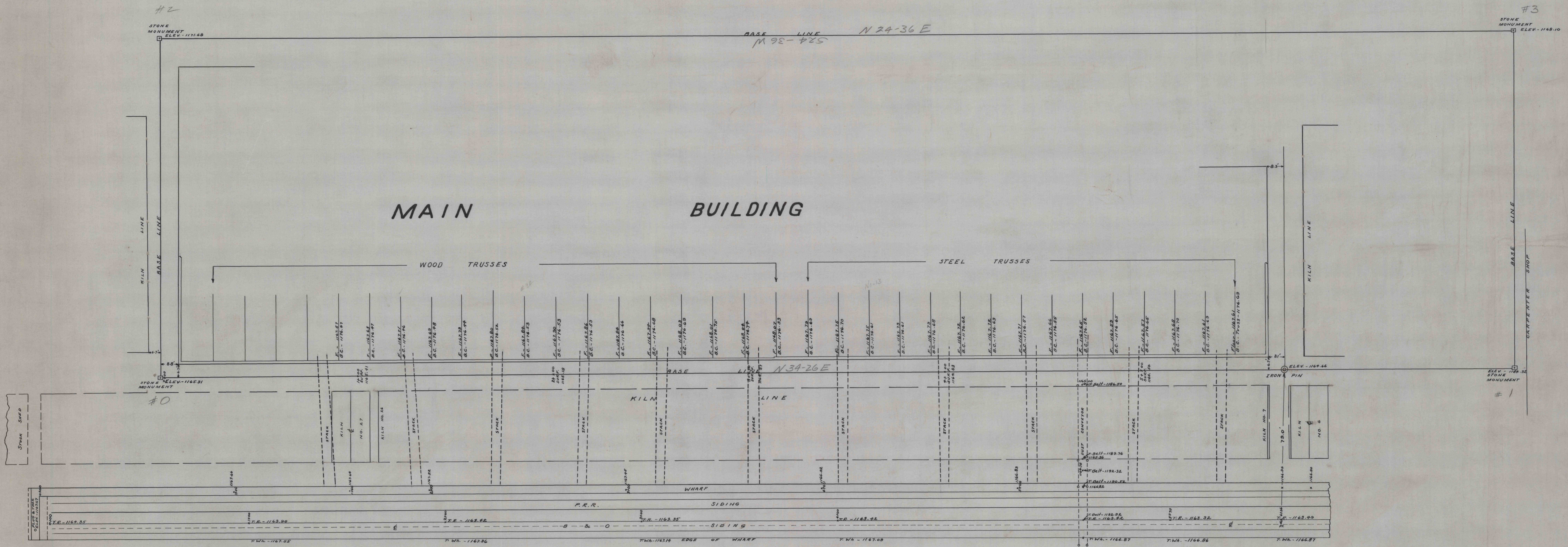

NOTE: ALL ELEVATIONS ARE FROM U.S.G.S. DATUM.

NORTH AMERICAN REFRACTORIES CO.
1012 NATIONAL CITY BANK BUILDING
CLEVELAND, OHIO

BASE LINES AND ELEVATIONS
TUNNEL KILN LAY-OUT
CURWENSVILLE PLANT

DRAWN V.R.H. SCALE 1" = 20'
CHECKED J.M.H. DATE 3-2-51
REFERENCE TRACED BY V.R.H. 50-3-1437