

30-3-62

30-3-62

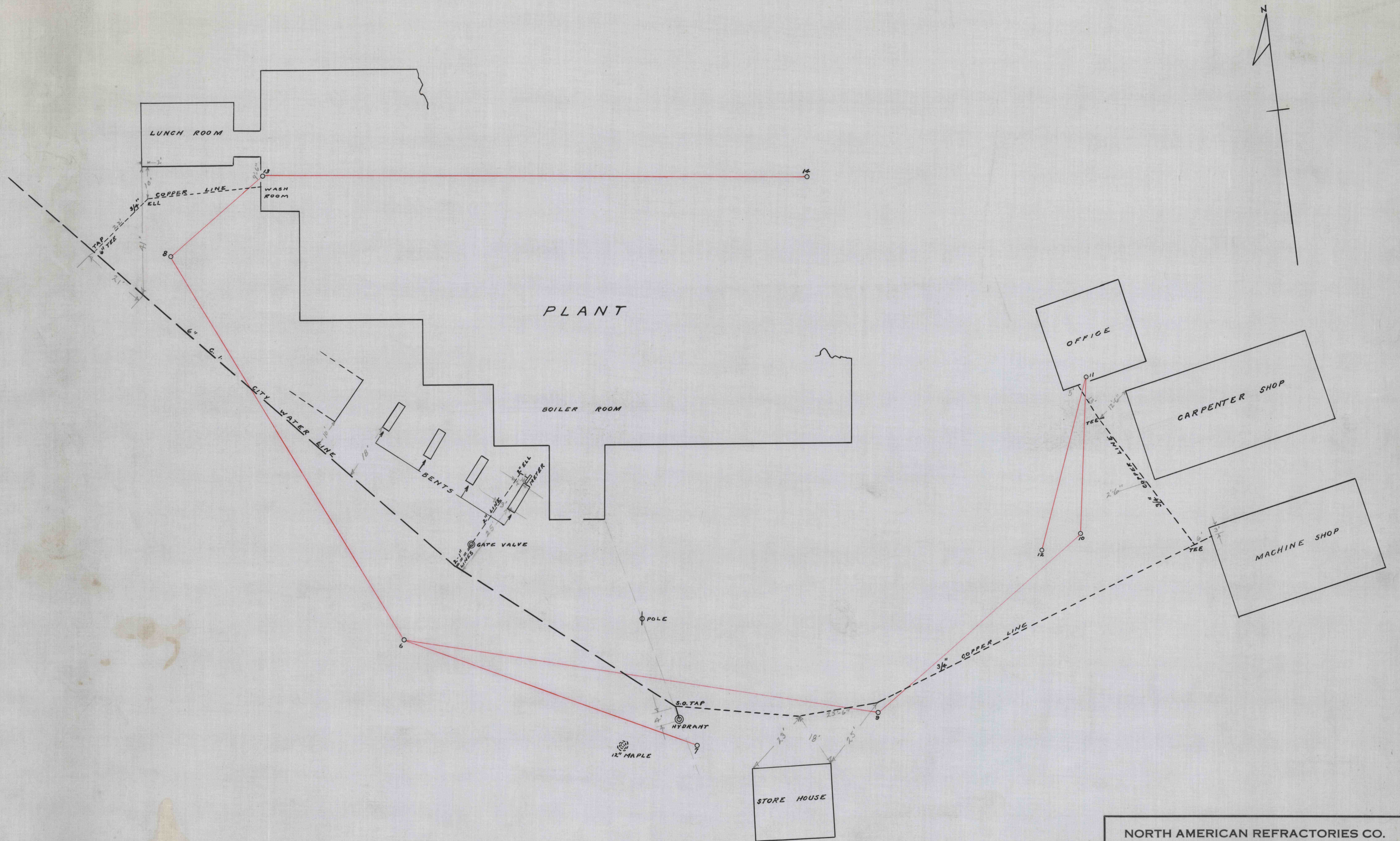

NORTH AMERICAN REFRACTORIES CO. 1012 NATIONAL CITY BANK BUILDING CLEVELAND, OHIO	
MAP SHOWING 6" CITY WATER LINE AND OTHER LINES SERVING ST. MARYS PLANT	
DRAWN J.R.H.JR. CHECKED J.R.H.JR. REFERENCE SURVEY	SCALE 1" = 20' DATE 12-18-51 TRACED BY J.R.H.JR.
30-3-62	

30-3-62