

REFERENCE DATA

CRESCENT REFRACTORIES CO.

CURWENSVILLE, CLEARFIELD COUNTY, PA.
ENGINEERING DEPARTMENT

ENV. NO. L1

SHEET NO. 144

50-3-340

Smith Soft Clay - Mine Buildings.

SCALE 1" = 100'

DATE Feb., 19, 1920

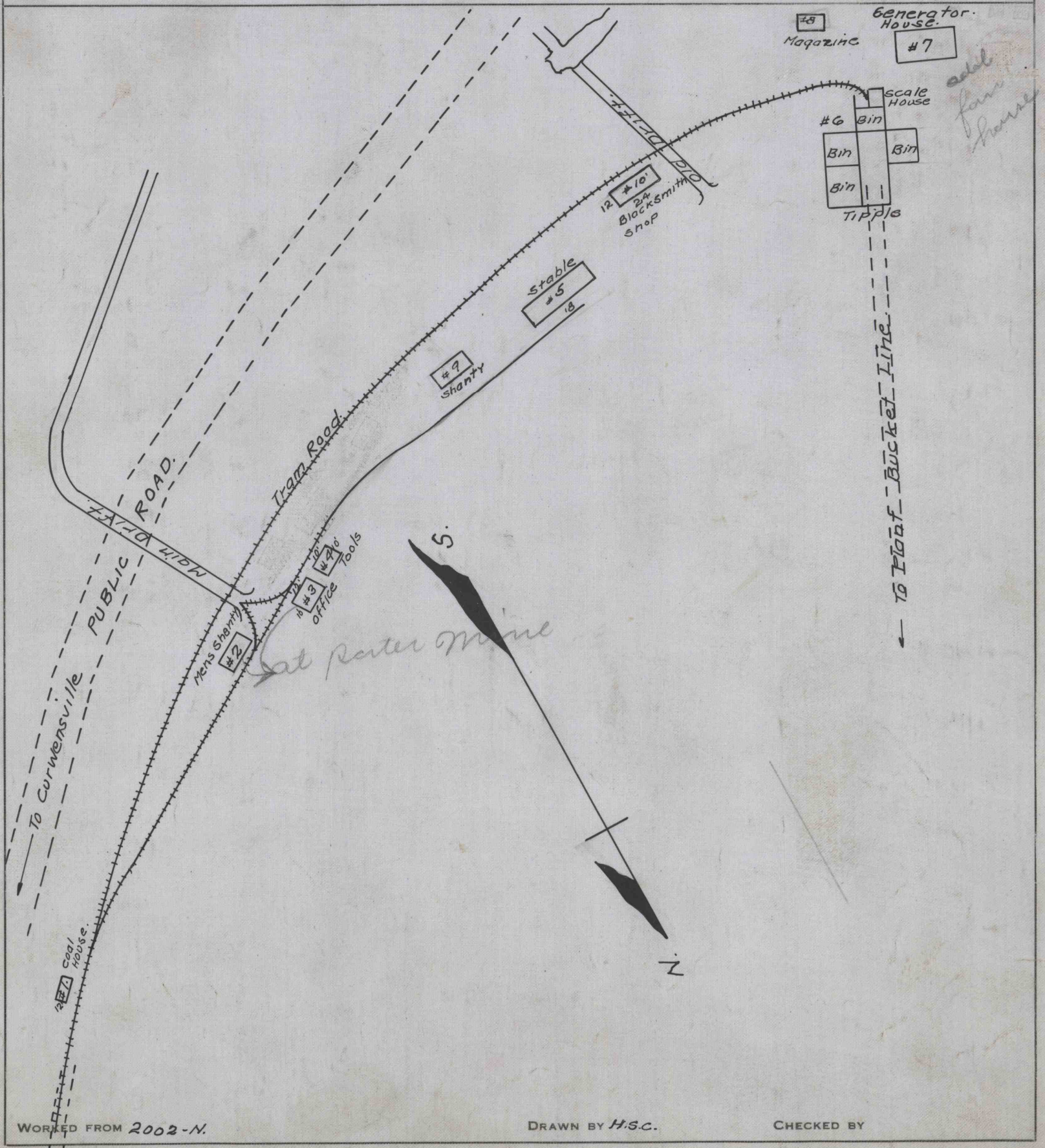

WORKED FROM 2002-N.

DRAWN BY H.S.C.

CHECKED BY