

50-3-1524

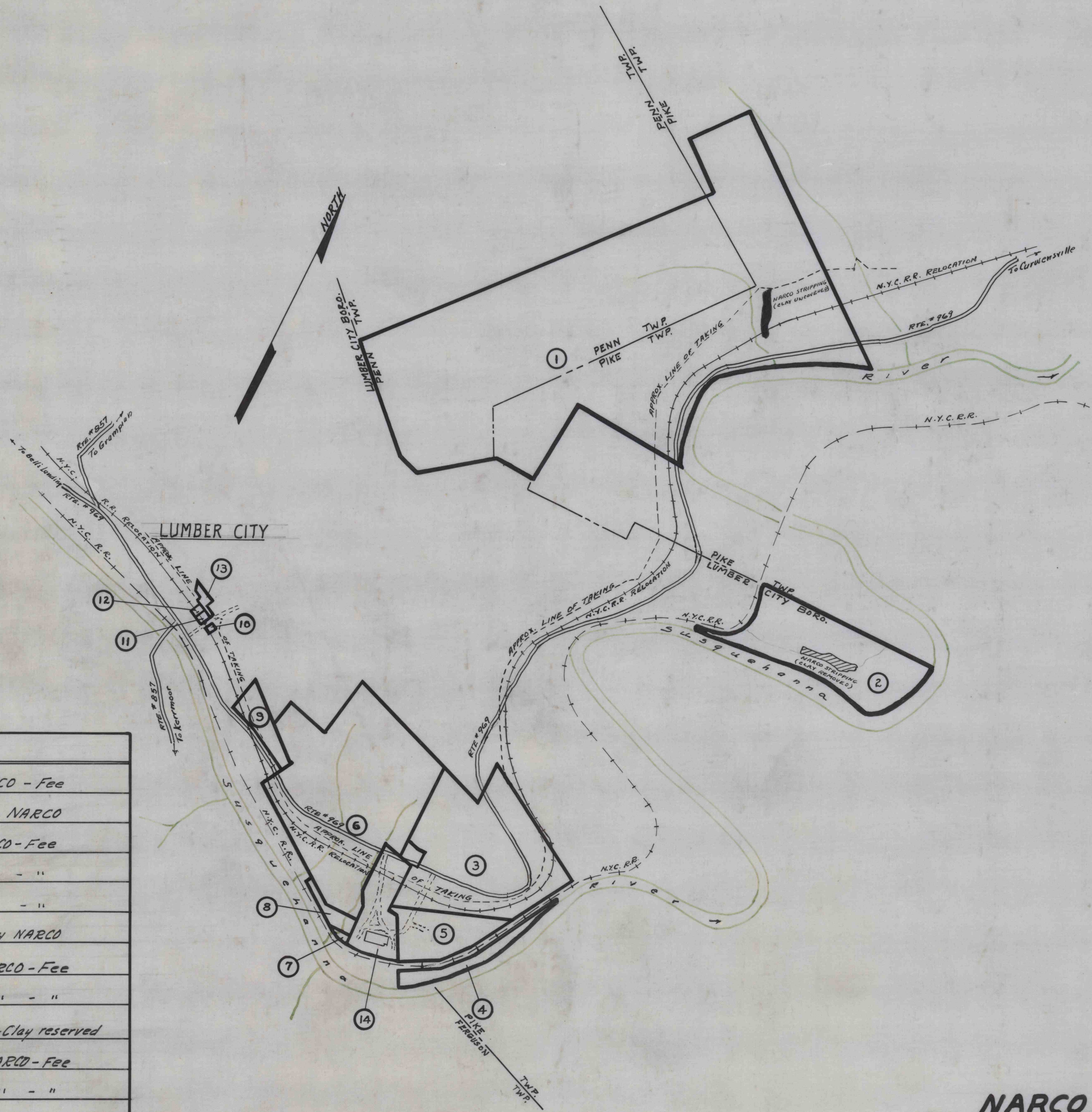

NO	NAME	FILE NO	AREA	DEED REFERENCE	REMARKS
1	McGee	M-301	387A, 101P.	D.B. 152/18	Owned by NARCO - Fee
2	Kreps	K-12	50 A.	Misc. 111/164	Clay leased to NARCO
3	Kirk	K-15	82.6A.	D.B. 468/455	Owned by NARCO - Fee
4	Kirk	K-15	11.5 A.	D.B. 468/455	" " " - "
5	Kirk	K-306	15A.31R	D.B. 166/41	" " " - "
6	Kirk	K-308	112 A.	D.B. 161/215	Clay owned by NARCO
7	Kirk	K-310	.75 A.	D.B. 220/277	Owned by NARCO - Fee
8	Kirk	K-301 K-302	4.84 A.	D.B. 226/501-502	" " " - "
9	McQuown	M-304	11.5 A.	D.B. 225/103	Owned by NARCO - Clay reserved
10	Edwards		2 Lots	D.B. 183/546	Owned by NARCO - Fee
11	Rorabaugh		2 Lots	D.B. 176/13	" " " - "
12	Hile		1 Lot	D.B. 179/202	" " " - "
13	Hile		5 Lots	D.B. 176/42	" " " - "
14	Kirk	K-308	18 A.	D.B. 161/215	" " " - "

NARCO LANDS
IN
PIKE & PENN TWP. AND LUMBER CITY BORO.
CLEARFIELD COUNTY - PA.

January 4, 1962
 John D. Haines, Jr.

SCALE: 1"=1200'