

NORTH AMERICAN REFRACTORIES CO.

CLEVELAND, OHIO

MAP SHOWING A CONNECTED DRAFT OF SEVERAL TRACTS IN MIFFLIN & HUNTINGDON COS.

DRAWN - AFRICA, J.M. Co.

TRACED - J.E.H. Jr.

CHECKED - J.G. MURRAY

SCALE 1" = 60 RODS

INDEX No. - 60-3-292-50

JANUARY 17, 1927

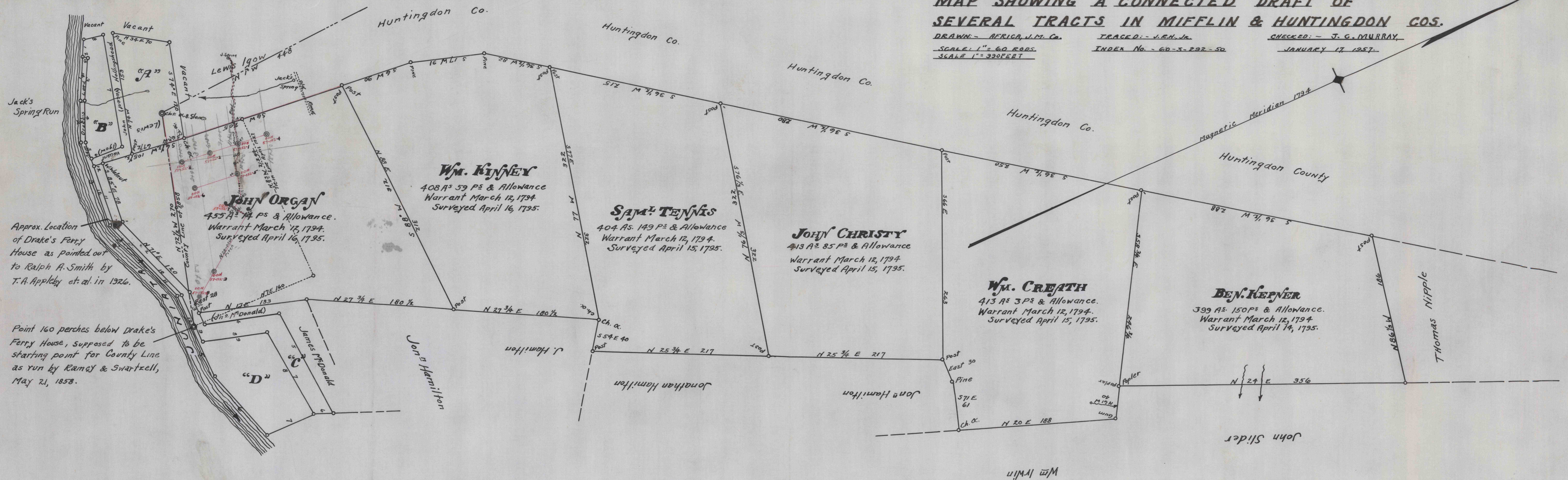

Approx. Location of Drake's Ferry House as pointed out to Ralph A. Smith by T.A. Appleby et al. in 1926.

Point 160 perches below Drake's Ferry House, supposed to be starting point for County Line as run by Ramey & Swartzell, May 21, 1858.

"A"
LEWIS IGO
54 A² 24 P² & Allowance
Warrant dated May 22, 1794.
Surveyed January 6, 1795.

"C"
SAMUEL DRAKE
42 A² 8 P² & Allowance.
Warrant dated June 11, 1793.
Surveyed April 13, 1795.

"D"
FRANCIS HAMILTON
69 1/4 Acres & Allowance.
Warrant dated March 9, 1787.
Surveyed July 7, 1789.

"B"
ANDREW BELL
32 A² 90 P² & Allowance.
Warrant dated January 19, 1793.
Surveyed July 6, 1794.

- 1 - S 62 E 22 to Hick.
- 2 - N 8 E 6 - Post
- 3 - S 63 E 54 - Post
- 4 - S 68 E 52 - Post
- 5 - S 85 E 22 - Post
- 6 - N 2 E 41 - Birch
- 7 - N 73 W 141 - Post
- 8 - S 9 W 32 - Sugar tree.

- 1 - S 85 E 78 to Stone
- 2 - N 71 E 120 " Stones
- 3 - East 44 "
- 4 - N 16 E 93 " Post
- 5 - N 86 1/2 E 141 1/2 " Post
- 6 - S 21 W 23 " Ch. α.
- 7 - S 85 W 118 " Hick.
- 8 - S 16 W 80 " Post
- 9 - West 64 " Post
- 10 - S 71 W 120 " Post
- 11 - N 85 W 78 " Hick.
- 12 - N 5 E 10 " White Walnut.

Down Juniatta
Beginning at Hickory:

- 1 - S 62 E 54 "
- 2 - S 67 E 52 "
- 3 - S 84 E 110 "
- 4 - N 71 E 120 "
- 5 - S 89 E 112 "
- 6 - N 73 E 98 "
- 7 - North 63 to Ch. α.
- 8 - S 86 W 118 " Hick.
- 9 - S 17 W 80 "
- 10 - N 89 W 64 " Po.
- 11 - S 71 W 120 "
- 12 - N 84 W 110 "
- 13 - N 67 W 52 " Hick.
- 14 - N 62 W 54 " Hick.
- 15 - S 8 W 6 " Hick.

DRAFT of several tracts of land situated on Jack's Mountain in Mifflin and Huntingdon Counties, Pennsylvania. This connection is an enlargement of an official connected draft, certified September 27, 1916, in possession of Ralph A. Smith. The original bearings are unchanged. The starting point for the County Line was located by measuring 160 rds. down the River from the site of Drake's Ferry House as shown us by Ralph A. Smith (see note above). The bearings and distances given are those shown on a copy, certified August 15, 1884, of the map and report of Jno. F. Ramey and John Swartzell dated December 15, 1858. The dotted tie-in line was run in April - bearings given of that date.

Constructed May 5, 1927
By
The J. Murray Africa Co., Huntingdon, Penna.

Scale - 60 Rds. to 1 In.