

N. 3° 00' E. 4458.0 FT.

ALEXANDER D. DEEMER II & FRANK C. DEEMER JR.

F. C. DEEMER - SURFACE
NARCO - CLAY
363.5 ACRES

AREA No. 1

AREA TO BE AFFECTED 17.63 AC. ±
AREA OF GOOD CLAY 14.71 AC. ±

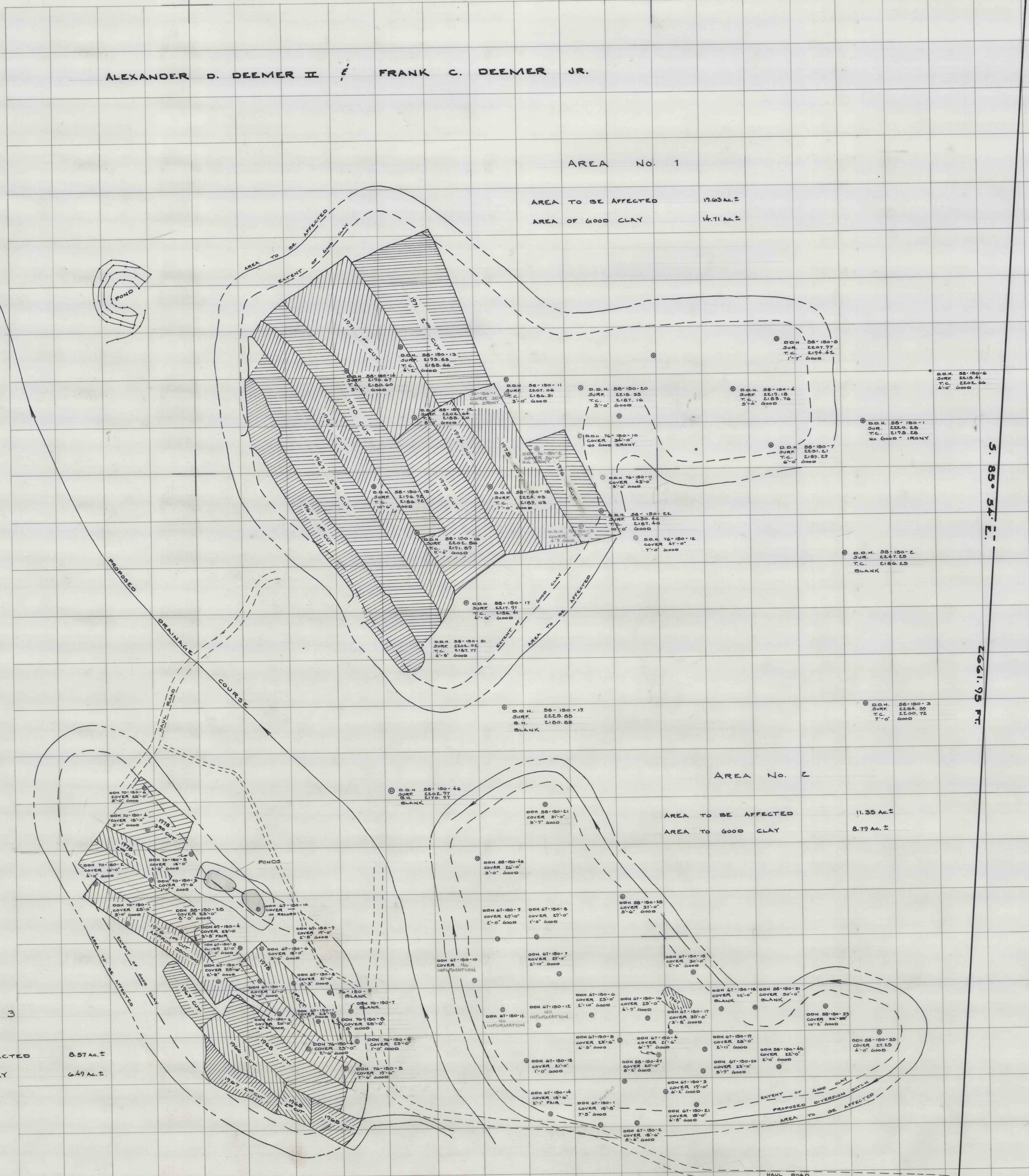

NARCO

AREA No. 3

AREA TO BE AFFECTED 8.87 AC. ±
AREA OF GOOD CLAY 6.49 AC. ±

AREA No. 2

AREA TO BE AFFECTED 11.35 AC. ±
AREA TO GOOD CLAY 8.79 AC. ±

PIKE
TOWNSHIP
MUNICIPAL
AUTHORITY

H. K. PORTER CO. INC. & W. M. WRIGLEY

NOTE: DIAMOND DRILL HOLES 76-150-3 THRU 76-150-3 ARE PLACED ON MAP IN APPROXIMATE LOCATION.

NORTH AMERICAN REFRACTORIES CO.
MAP SHOWING PROSPECTING ON
F. C. DEEMER TRACT

SITUATED IN
BLOOM TOWNSHIP CLEARFIELD COUNTY PA.

SCALE 1" = 100' DRAWN BY CHECKED BY
PLOTTED FROM SURVEYS - N/S NOS. 272 AND 276
DATE 3-30-61 INDEX NO. 50-3-1662

9-26-78
9-27-77
12-28-76
REVISED 7-30-62