

# RECORD OF EXISTING ROAD TYPES

PUB. RDS. DIV. NO.	STATE	FEDERAL PROJECT	FISCAL YEAR	DISTRICT	COUNTY	ROUTE	SECT.	SHEET
2	PENNSYLVANIA			8-0	YORK	1070	1	2 of 4

WEST MANCHESTER TWP.

**L.R. 126** - LIMIT OF WORK  
 Adjacent to Constr. & S.L.D. Sta. 524 + 38  
 36' - ID-2 & FJ-1 on Flex. Base, 10' Conc. Rt. & Lt. & 3' C.A.B. Widening Rt. & Lt. (1962)

Constr. & S.L.D. Sta. 524 + 38 to Constr. & S.L.D. Sta. 584 + 50  
 36' - ID-2 & FJ-1 on Flex. Base, 10' Conc. Rt. & Lt. & 3' C.A.B. Widening Rt. & Lt. (1962).

LIMIT OF WORK  
 Adjacent to Constr. & S.L.D. Sta. 584 + 50  
 36' - ID-2 & FJ-1 on Flex. Base, 10' Conc. Rt. & Lt. & 3' C.A.B. Widening Rt. & Lt. (1962).

**L.R. 66203** - LIMIT OF WORK  
 Adjacent to S.L.D. Sta. 304 + 00 - L.R. 492 (Const. Sta. 0 + 11)  
 22' - ID-2' on 16' Conc. Pav't & Bit. Base Course Widening Lt. & Rt. (1965).

LIMIT OF WORK  
 Adjacent to S.L.D. Sta. 6 + 30 (Const. Sta. 20 + 00) 11' Oil Bound Macadam

**L.R. 66005** - LIMIT OF WORK  
 Adjacent to Constr. & S.L.D. Sta. 482 + 25  
 20' - FJ-1 on HE-1 & C.A.B. (1962)

Constr. & S.L.D. Sta. 482 + 25 to Constr. & S.L.D. Sta. 511 + 30  
 20' - FJ-1 on HE-1 & C.A.B. (1962)

LIMIT OF WORK  
 Adjacent to S.L.D. Sta. 510 + 88 (Constr. Sta. 511 + 30)  
 20' - FJ-1 on HE-1 & C.A.B. (1962)

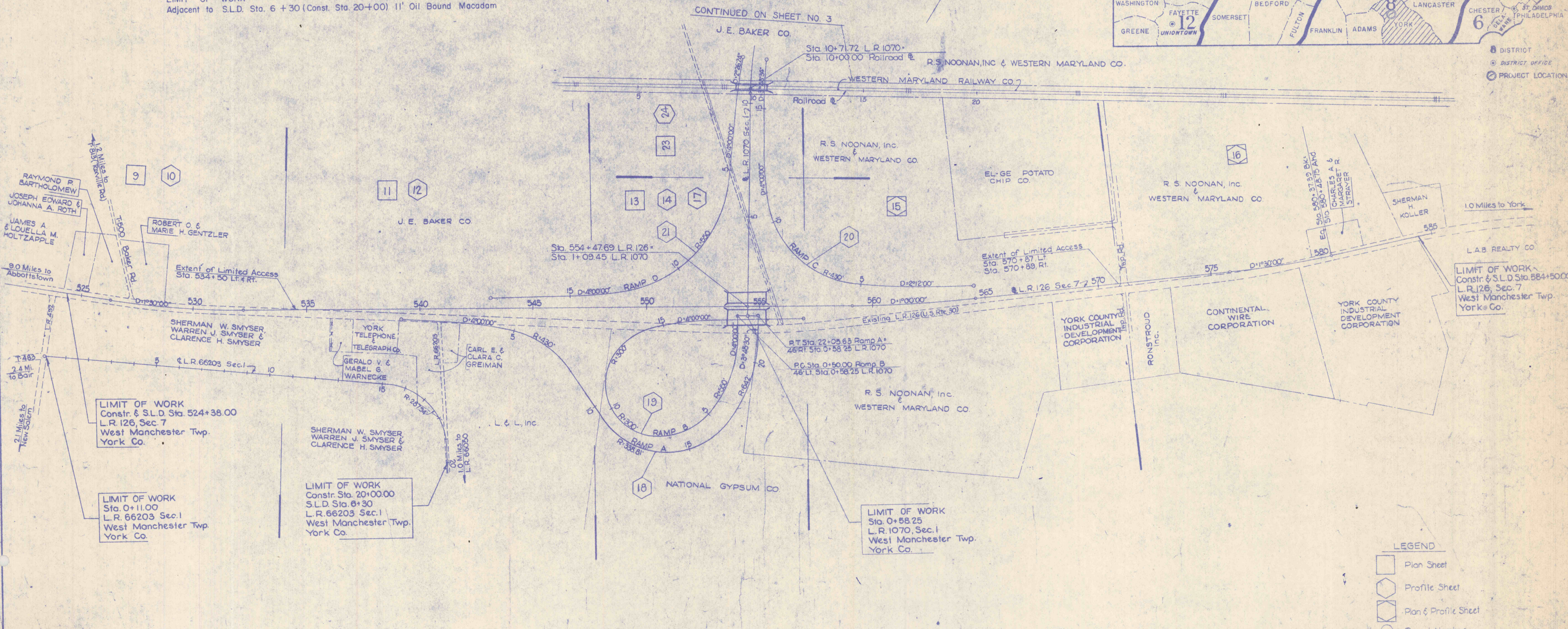
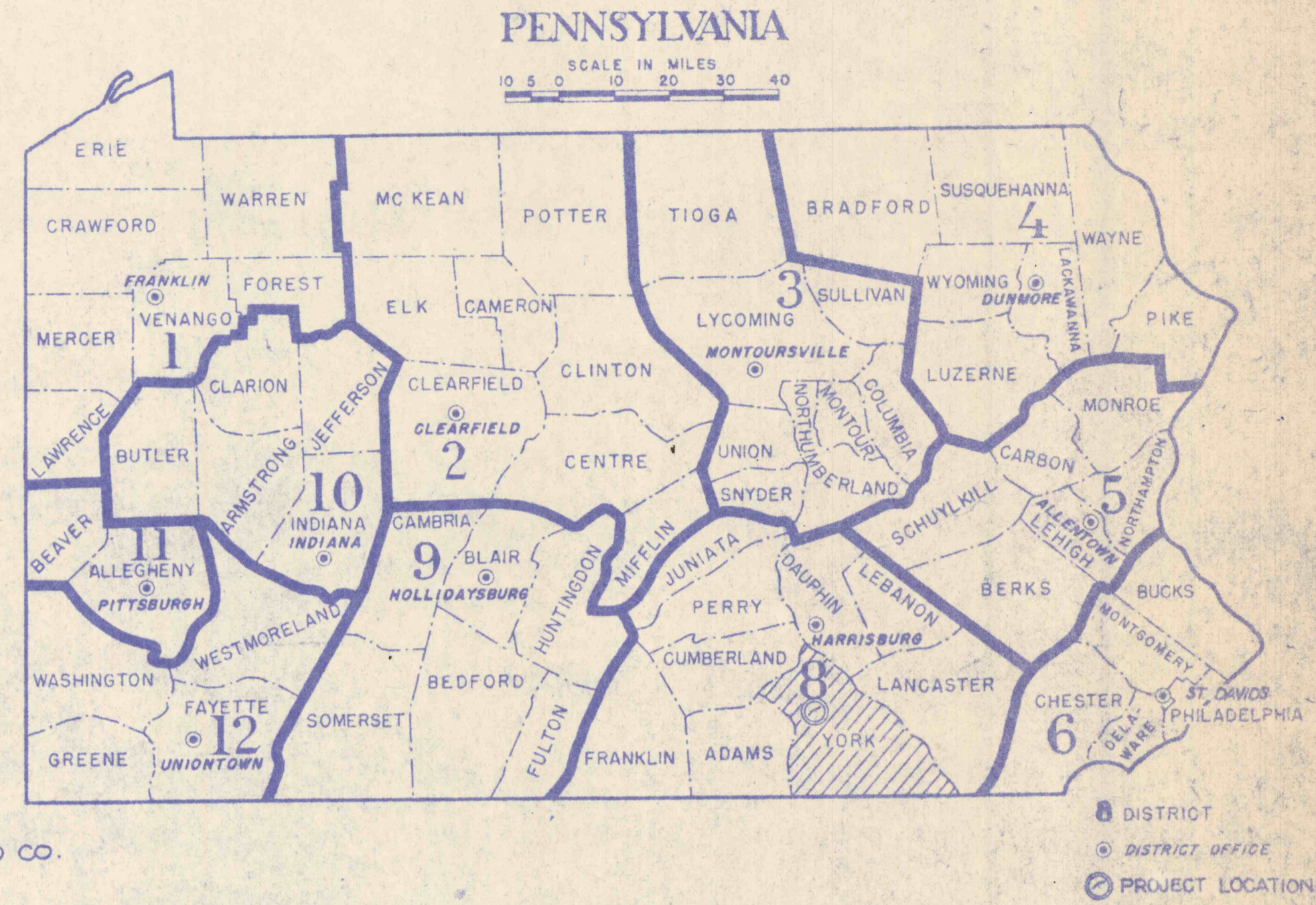

INDEX MAP  
 SCALE: 1" = 200'