

N16,000
N14,000
N12,000
N10,000
N8,000
N6,000

W2000
E000
E2000
E4000

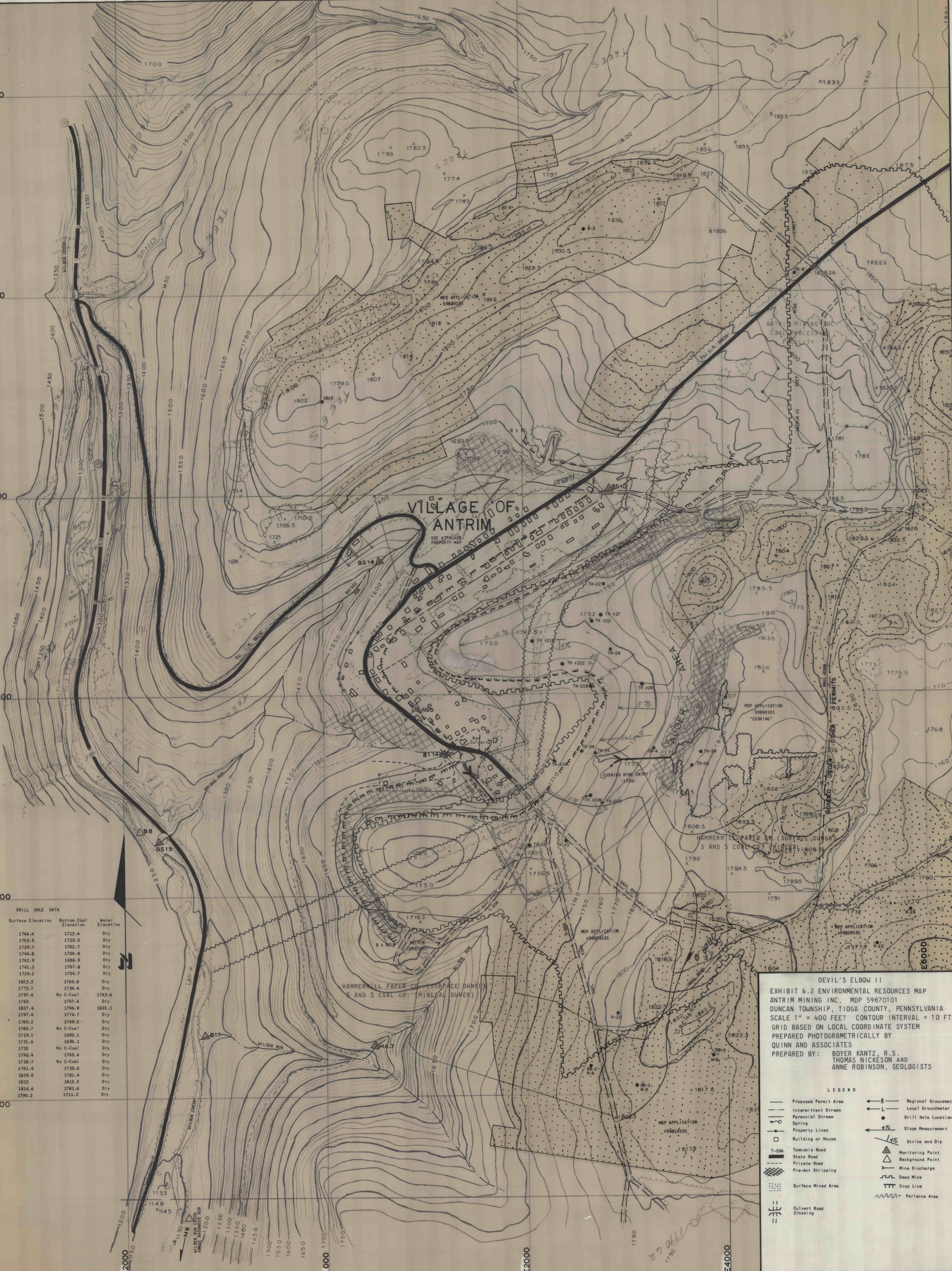

DRILL HOLE DATA

Hole	Surface Elevation	Bottom Coal Elevation	Water Elevation
219	1744.4	1713.4	Dry
23	1753.5	1720.5	Dry
222	1729.7	1702.7	Dry
29	1744.8	1704.8	Dry
209	1742.9	1696.9	Dry
3	1741.3	1707.8	Dry
5	1729.2	1704.7	Dry
H10	1823.3	1760.8	Dry
H24	1773.7	1734.4	Dry
0B-2	1797.4	No C-Coal	1743.6
0B-4	1760	1707.4	Dry
0B-1	1827.4	1796.9	1801.1
0B1R	1797.4	1774.7	Dry
H22	1780.2	1749.2	Dry
38	1785.7	No C-Coal	Dry
31	1729.1	1693.1	Dry
34	1721.6	1694.1	Dry
214	1710	No C-Coal	Dry
28	1746.4	1705.4	Dry
218	1718.7	No C-Coal	Dry
210	1781.4	1735.6	Dry
0B-8	1829.6	1781.4	Dry
8-3	1835	1813.5	Dry
0B-3	1816.6	1781.6	Dry
39	1790.2	1711.2	Dry

DEVIL'S ELBOW II
EXHIBIT 6.2 ENVIRONMENTAL RESOURCES MAP
ANTRIM MINING INC. MDP 59870101
 DUNCAN TOWNSHIP, TIOGA COUNTY, PENNSYLVANIA
 SCALE 1" = 400 FEET CONTOUR INTERVAL = 10 FT.
 GRID BASED ON LOCAL COORDINATE SYSTEM
 PREPARED PHOTOGRAMMETRICALLY BY
 QUINN AND ASSOCIATES
 PREPARED BY: BOYER KANTZ, R.S.
 THOMAS NICKESON AND
 ANNE ROBINSON, GEOLOGISTS

- LEGEND**
- Proposed Permit Area
 - Intermittent Stream
 - Perennial Stream
 - Spring
 - Property Lines
 - Building or House
 - T-50+ Township Road
 - State Road
 - Private Road
 - Pre-Act Stripping
 - Surface Mined Area
 - Culvert Road Crossing
 - Regional Groundwater
 - Local Groundwater
 - Drill Hole Location
 - Slope Measurement
 - Strike and Dip
 - Monitoring Point
 - Background Point
 - Mine Discharge
 - Deep Mine
 - Crop Line
 - Variance Area