

C Coal
Cushins
Fallbrook

0-12
24.35
17.05
41.40

5.7 12"
2.0 24"

Assumed
cut out

90.8 Ac

31.9 Ac

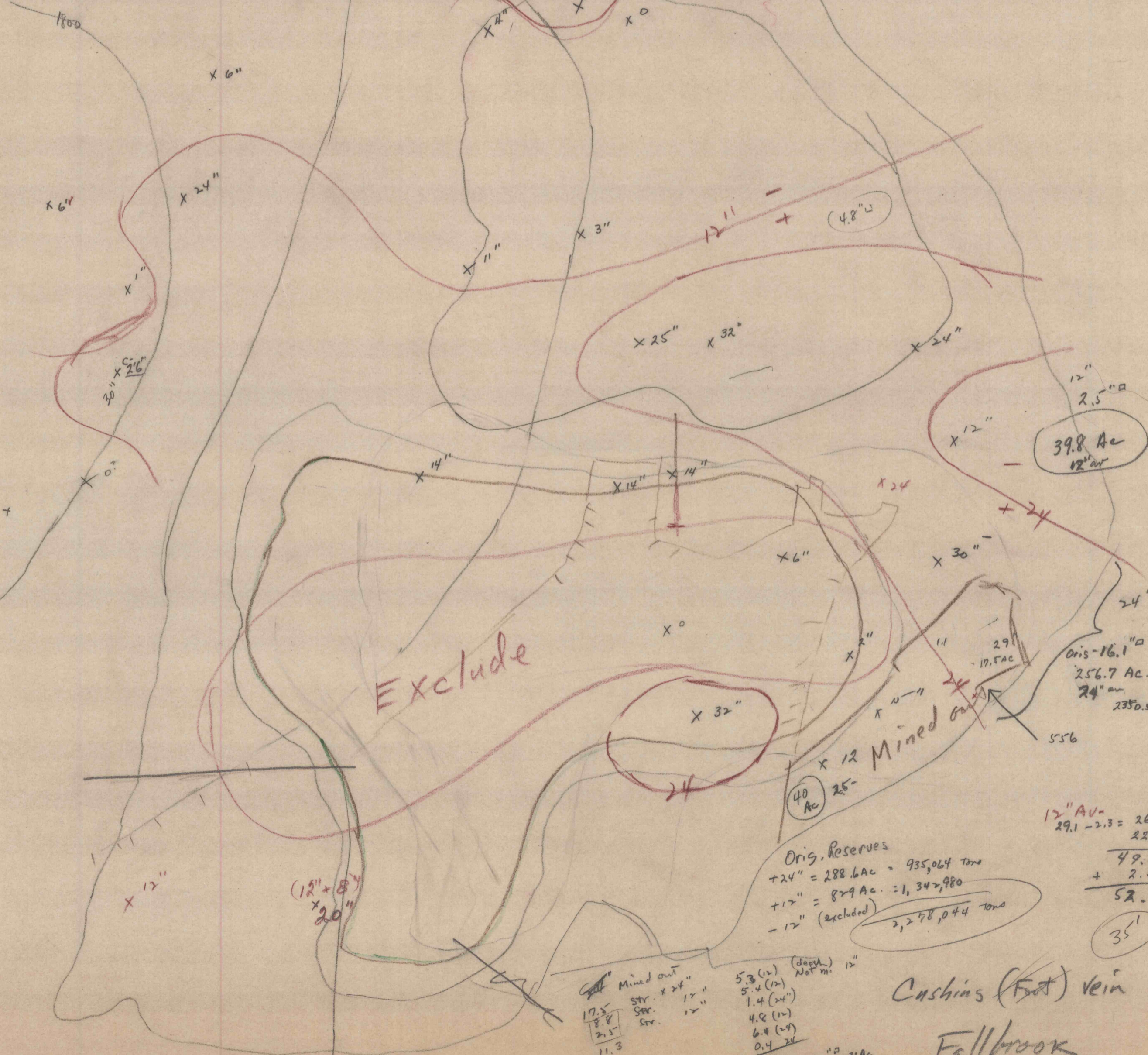

Exclude

39.8 Ac
12" av

Orig - 16.1
256.7 Ac.
24" av
2350.5

Orig. Reserves
+24" = 288.6 Ac = 935,064 tons
+12" = 829 Ac. = 1,342,980
-12" (excluded)
2,278,044 tons

12" Av = 26.8
29.1 - 2.3 = 26.8
22.7

49.5
+ 2.5
52.0

35'

Mined out
Str. x 24"
Str. 12"
Str. 12"
17.5
8.8
2.5
11.3

(depth) 12"
Not m.
5.3 (12)
5.4 (12)
1.4 (24)
4.8 (12)
6.4 (24)
0.4 24

24" - 8.2 = 131 Ac
43
12" - 15.5 = 247.1 Ac
400,110

Cushins (Foot) vein
Fallbrook