

Warrant No 1582.

North

Location.	Geological Section.
On Line H going south Station 7, 90.	Top Covering (9' 11")
	Brown State 15' 11"
	Gray Rock 36' 6 inches
	Dark State 4-6" CUSHI VEIN 2 1/2' coal
On Line D going south, Sta. 39+53, thence east 166 feet.	Conglomerate 76 Feet.
	Light colored slate 1 Foot
	Light colored rocky slate 2 1/2'
	Black Slate 4-6" 6' coal
	White Fire Clay 3-6" 2' coal
	Black Slate 1-4" 5 1/2' coal
	BLOSS VEIN
On north 15-35, thence west 200'	Fire Clay 3-6"
	Light colored Slate 13 Feet
	Loam Conglomerate

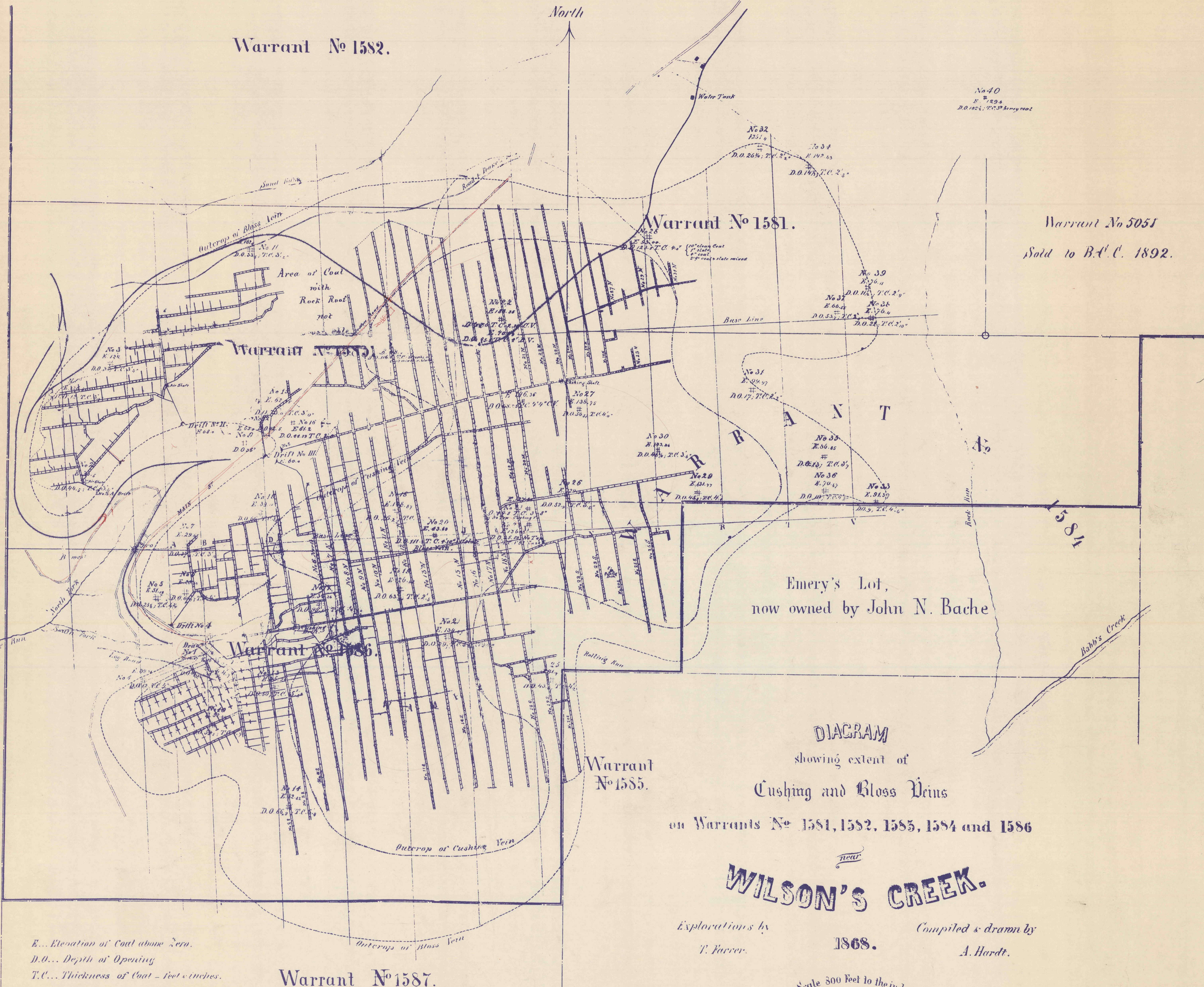

No 40
E. 29.4
D.O. 102.1, T.C. 2 1/2'

Warrant No 5051
Sold to B.A.C. 1892.

Emery's Lot,
now owned by John N. Bache

DIAGRAM
showing extent of
Cushing and Bloss Veins
on Warrants No 1581, 1582, 1585, 1584 and 1586

near
WILSON'S CREEK.

Explorations by T. Farrer. 1868. Compiled & drawn by A. Hardt.

Scale 800 Feet to the inch.

E... Elevation of Coal above Zero.
D.O... Depth of Opening
T.C... Thickness of Coal - feet & inches.

Warrant No 1587.

Scale of Section
101" to inch