

Location	Geological Section.
	Top Covering 91'
On Line H going south Station 7100.	Brown State State
	Gray Rock 36 Ft 6 inches.
On Line D going south Sta. 39185, thence east 100 feet.	Dark State 2'-6" CUSHI VEIN 2'8" coal
	Conglomerate 76 Feet.
On Line D going south Sta. 39185, thence east 100 feet.	Light colored slate 1 foot
	Light colored rocky slate 2'4"
	Black Slate 4'-6" 6" coal
	White Fire Clay 3'-6" 2" coal
	Black Slate 1'-2" 5'4" coal
On Line D going south Sta. 39185, thence east 200'	BLOSS VEIN
	Fire Clay 3'-0"
	Light colored Slate 13 feet
	Lower Conglomerate

Scale of Section
101" to inch

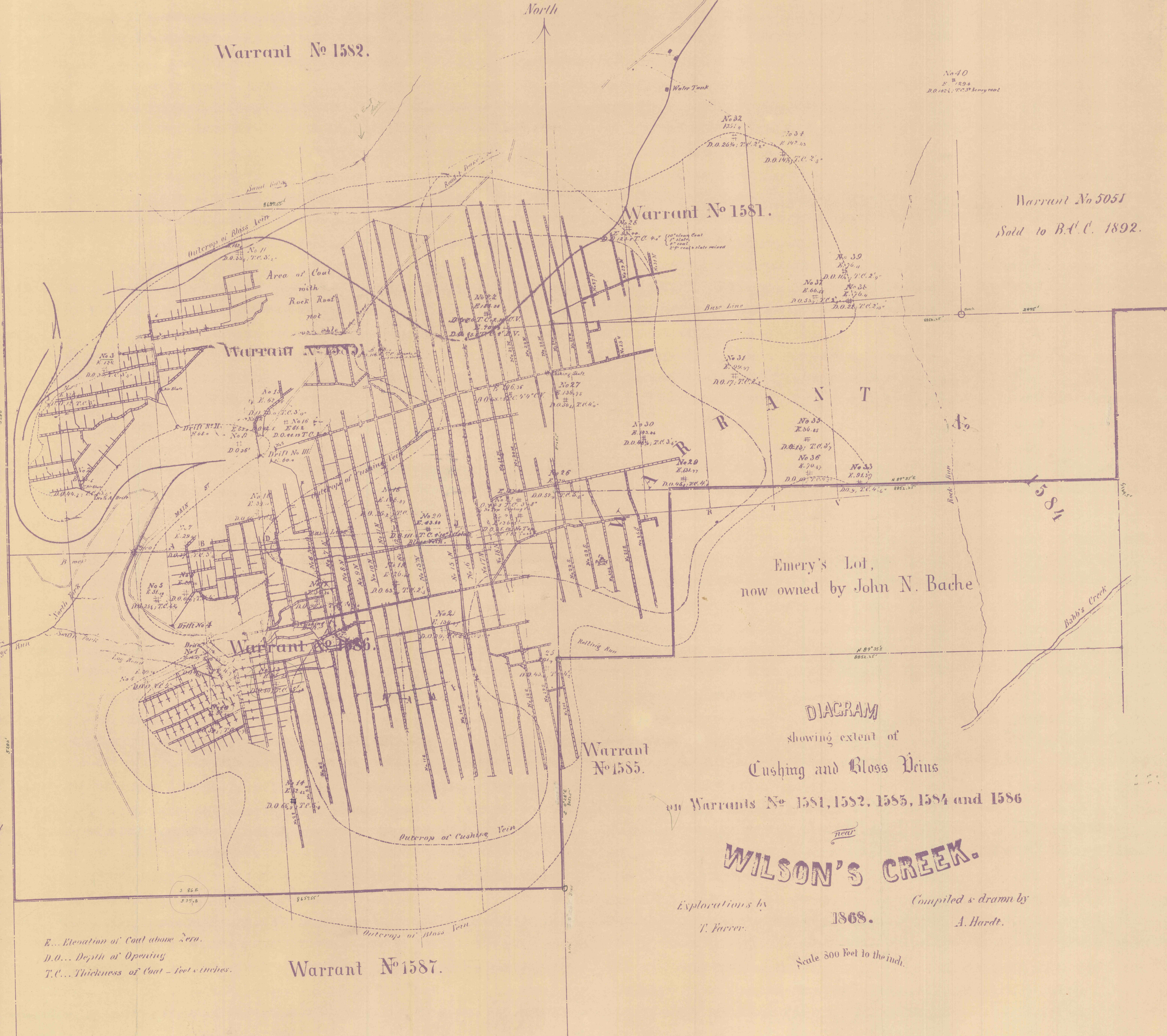

Warrant No 1582.

Warrant No 1581.

Warrant No 1586.

Warrant No 1587.

Warrant No 5051
Sold to B.A.C. 1892.

Emery's Lot,
now owned by John N. Bache

DIAGRAM
showing extent of
Cushing and Bloss Veins
on Warrants No 1581, 1582, 1585, 1584 and 1586
near
WILSON'S CREEK.

Explorations by
T. Farrer.
1868.
Compiled & drawn by
A. Hardt.

Scale 800 Feet to the inch.

E... Elevation of Coal above Zero.
D.O... Depth of Opening
T.C... Thickness of Coal - Feet & inches.