

NAU COAL CO.
FORMERLY
(Jasahill Coal Mining Co.)

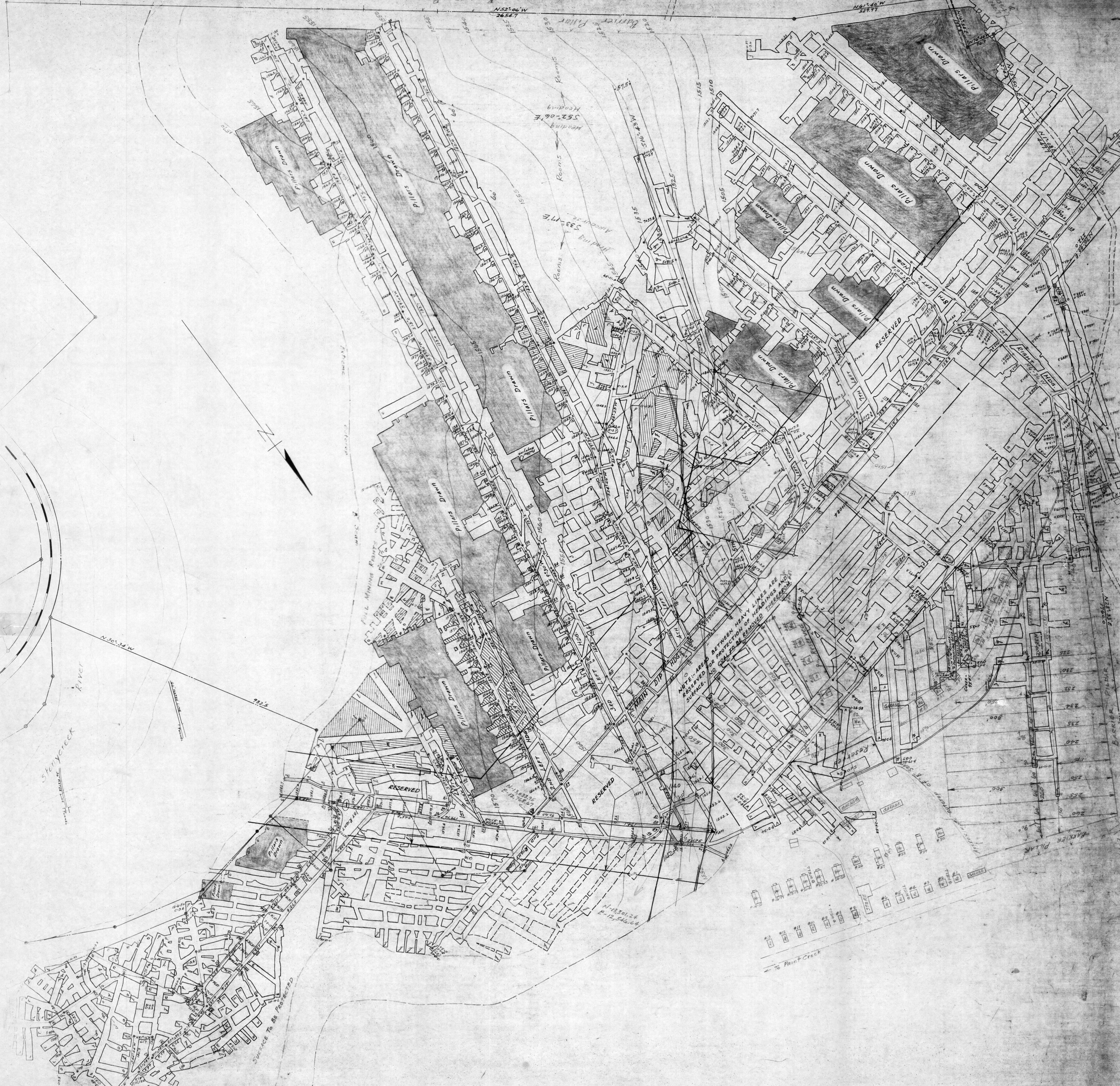

MAP SHOWING 'B' SEAM MINING OPERATIONS
OF
PAINT CREEK COLLIERIES
(Formerly CAMBRIA FUEL CO. No. 1 MINE)
OPERATED BY TOTHS BROS.
SITUATE IN
CONEMAUGH TWP., SOMERSET CO., PA.
SCALE: 1"=100' DEC. 20, 1948
A. CALVIN GALBRAITH
MINING ENGINEER
JOHNSTOWN, PA.

STEVE TOTHS COAL CO.

INDEX TO SURVEYS			
LETTER	DATE	LETTER	DATE
M	DEC. 18, 1948		
P	JULY 26, 1949		
O	DEC. 16, 1949		
Q	MAY 15, 1950		
R	DEC. 6, 1950		
S	JUNE 10, 1951		
T	DEC. 18, 1951		
U	JAN. 16, 1952		
V	AUG. 20, 1952		
W	MAR. 17, 1953		
X	AUG. 24, 1954		
Y	JAN. 24, 1954		
Z	APRIL 11, 1954		
	DEC. 11, 1954		