

DRILL HOLE RECORD									
No.	Surface Elevation	Upper Freeport	Thk.	Upper Kittanning	Thk.	Brush Creek	Thk.	S.W.L.	
DM4	2042	1941	60'	1875	VOID	---	---	---	1939
DM19	1979	1963	16'	1875	VOID	---	---	---	DRY
DM42	1914	BELOW CROP	---	1878	60'	---	---	---	DRY
DM45	1989	1937	42'	---	---	---	---	---	DRY
DMC	2067	1963	24'	---	---	---	---	---	1963
DM1A	2119.1	1906.1	46'	---	---	---	---	---	2004
DM2	2100.3	1906.3	39'	---	---	---	---	---	2046
DM3	2053.9	1901.9	46'	---	---	2024.4	18'	---	2046
DM4	2092.1	1926.6	41'	---	---	---	---	---	2054
DM4A	2091.6	1927.6	36'	---	---	2045.6	14'	---	2054
DM5	2105.2	1913.7	44'	---	---	---	---	---	2013
DM6	2074.5	1831.5	48'	---	---	1974.5	18'	---	2014
DM7	2044.5	1813.5	50'	---	---	---	---	---	1798
DM8	2035.7	1853.8	50'	---	---	---	---	---	1801
DM9	2007.4	1754.4	51'	1654.4	VOID	1853.9	16'	---	1801
DM10	1906.7	1727.7	VOID	---	---	1859.7	15'	---	1801
DMA	2040.0	1952.0	48'	---	---	---	---	---	1882
DM2	1996.0	1951.0	30'	---	---	---	---	---	1854.9
DM5	1998.5	1955.5	36'	---	---	---	---	---	---

NOTE: PROPERTIES ARE DEPICTED FROM TAX MAPS AND DEED DESCRIPTIONS AND DO NOT NECESSARILY REPRESENT SURVEYED LOCATIONS. UTILITY LOCATIONS ARE DEPICTED THROUGH FIELD RECONNAISSANCE AND MAY NOT REPRESENT ACTUAL OR SURVEYED LOCATIONS. PRIOR TO ANY MINING OR EXCAVATION THE OPERATOR IS REQUIRED TO NOTIFY THE PA ONE CALL SYSTEM, INC. TO HAVE ALL UTILITY LINES LOCATED.

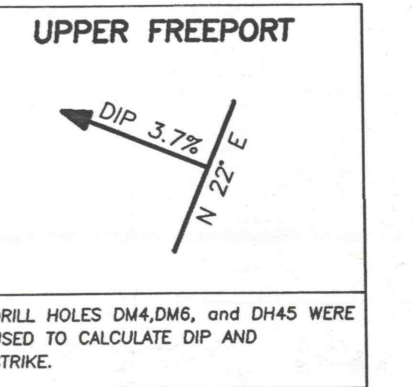

- COAL OWNERSHIP**
- (1) WJM COAL CO., INC.
 - (2) FRIEDLINE INVESTMENT, CO.
 - (3) KMK, INC.
 - (4) M.F. LAND CO., INC.
 - (5) SENATE COAL MINES, INC.
 - (6) UNKNOWN

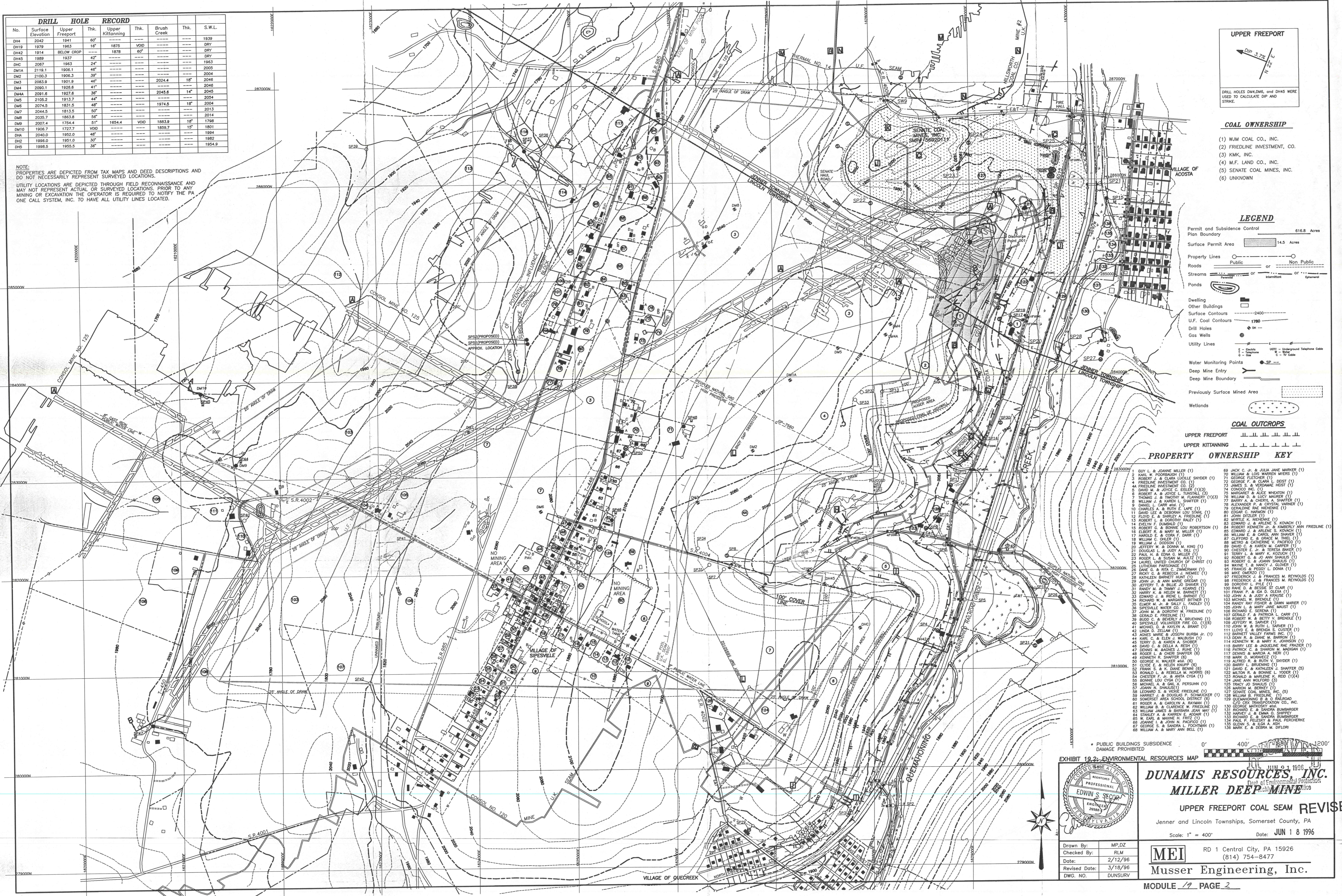
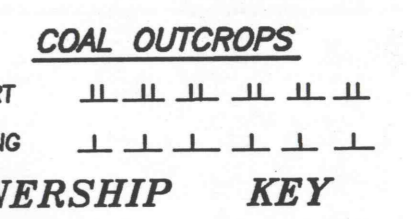
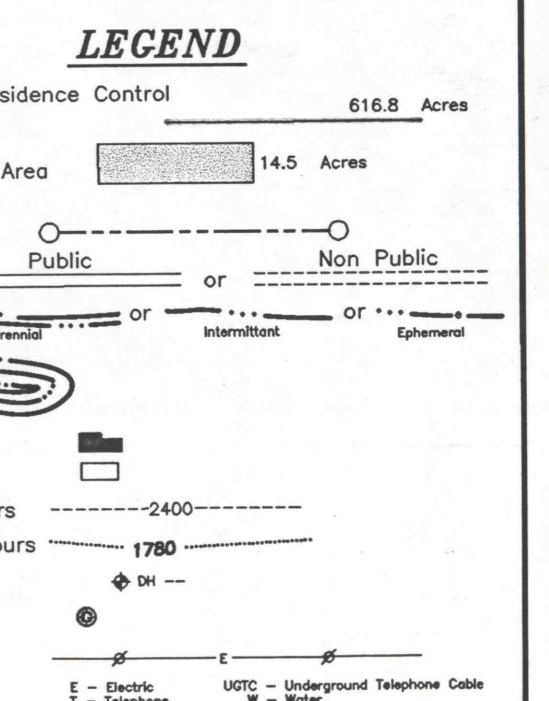

- 1 GUY L. & JOANNE MILLER (1)
- 2 KIM G. POORBAUGH (1)
- 3 ROBERT J. & CLARA LUCKLE SNYDER (1)
- 4 FRIEDLINE INVESTMENT CO. (2)
- 5 DAVID M. & JOYCE C. EHLER (1)(3)
- 6 ROBERT A. & JOYCE L. TUNSTALL (3)
- 7 WILLIAM D. & THERESA W. FLANNERY (1)
- 8 WILLIAM J. & KAREN L. SHAFER (1)(13)
- 9 WILLIAM J. & KAREN L. SHAFER (1)
- 10 CHARLES A. & RUTH E. LAPE (1)
- 11 FLOYD E. & DEBORAH LOU STONE (1)
- 12 FLOYD E. & SHARLEY A. RALEY (1)
- 13 ROBERT L. & NEENEKE (1)
- 14 EVELYN F. DUMGALD (1)
- 15 EDWARD J. & DONNA J. ROBERTSON (1)
- 16 ELBERT R. & MARY M. MILLER (1)
- 17 WILLIAM E. & DONNA F. BARR (1)
- 18 WILLIAM C. DYLER (1)
- 19 ROSSON (1)
- 20 JEFFERY W. & DONNA M. KING (1)
- 21 DONALD L. & JUDY A. DILL (1)
- 22 PAUL H. & EDNA G. MILLER (1)
- 23 ROBERT L. & MARY J. GLENN (1)
- 24 LAUREL UNITED CHURCH OF CHRIST (1)
- 25 LUTHERAN PROVISIONS (1)
- 26 RITA C. ZIMMERMAN (1)
- 27 RICHARD E. & REBECCA J. HENNES (1)
- 28 KATHLEEN BARRETT HUNT (1)
- 29 JOHN J. & ANNI MARIE GRIFFIN (1)
- 30 JEFFERY T. & BELLE JO SHAFER (1)
- 31 RANDY M. & TAMMY J. KEARNS (1)
- 32 HARRY J. & HELEN M. BARNETT (1)
- 33 EDWARD J. & RENE L. BARNOT (1)
- 34 RICHARD W. & MARGARET BITTNER (1)
- 35 ELMER M. & SALLY L. FADLEY (1)
- 36 SPSCHALLE WATER CO. (1)
- 37 JOHN W. & DOROTHY M. FRIEDLINE (1)
- 38 GERALD E. FRIEDLINE (1)
- 39 BUDD C. & BEVERLY A. BRENNING (1)
- 40 SPSCHALLE VOLUNTEER FIRE CO. (1)(6)
- 41 MICHAEL D. & KAYLYN A. BRANT (1)
- 42 SPSCHALLE WATER CO. (1)
- 43 AGNES MARIE & JOSEPH BURBA JR. (1)
- 44 DEAN R. & EILEEN J. WALSH (1)
- 45 TERRY D. & KAREN A. SHOFER (1)
- 46 DAVID R. & CELIA A. RISH (1)
- 47 DENNIS M. & MARGARET R. RINE (1)
- 48 RICHARD L. & CHERRI SHAFER (6)
- 49 KENNETH R. SHAFER (6)
- 50 GEORGE H. WALKER (6)
- 51 CLYDE E. & HELEN KUNIPF (6)
- 52 FRANK S. & K. DANIE BENVA (6)
- 53 RONALD L. & REBECCA M. NORRIS (6)
- 54 CHESTER F. & ANVA CYGA (1)
- 55 BONNIE LOU CYGA (1)
- 56 MONA E. & GAIL A. PERSLUH (1)
- 57 JOANN N. SHALUSIS (1)
- 58 SENATE COAL MINES, INC. (1)
- 59 HARRIS J. & DOUGLAS P. SCHAUJCKER (1)
- 60 SOMERSET AREA SCHOOL DISTRICT (6)
- 61 ROGER A. & CAROLYN A. KAVAN (1)
- 62 GEORGE MATTHEW (4)
- 63 WILLIAM JAMES & BARBARA JEAN MAY (1)
- 64 HARRY A. & KAREN E. SHOFER (1)
- 65 W. EARL & MAXINE H. FRITZ (1)
- 66 JOANNE E. & JOHN H. PIERCE (1)
- 67 GEORGE S. & SANDRA L. FECHTMAN (1)
- 68 WILLIAM A. & MARY ANN BELL (1)
- 69 JACK C. JR. & JULIA JANE MARKER (1)
- 70 WILLIAM L. & CLARA L. SNYDER (1)
- 71 GEORGE FLETCHER (1)
- 72 GEORGE F. & CLARA L. DEST (1)
- 73 JAMES S. & VERDAMME HEST (1)
- 74 CONROD INC. (1)
- 75 MARGARET & ALICE WHEATON (1)
- 76 WILLIAM D. & THERESA W. FLANNERY (1)
- 77 BARRY A. & CHERRI A. SHAFER (1)
- 78 ALZANDER P. & COTY ANN SHAFER (1)
- 79 SERAELINE RAE NIENHKE (1)
- 80 ALBERT HARRISON (1)
- 81 JOHN DITZLER (1)
- 82 MARY E. & NEENEKE (1)
- 83 EDWARD J. & ARLENE S. KOVACH (1)
- 84 ROBERT KENNETH & MARGARET ANN FRIEDLINE (1)
- 85 EDWARD J. & ARLENE S. KOVACH (1)
- 86 WILLIAM E. & DONNA F. BARR (1)
- 87 CLIFFORD E. & GRACE M. THEL (1)
- 88 METRO & CATHERINE A. SHAFER (1)
- 89 DAVID C. & KAREN M. CARPER (1)
- 90 CHESTER L. & JOANNE M. SHAFER (1)
- 91 TERRY L. & MARY K. KOZLICH (1)
- 92 ALBERT E. & JO ANN SHAFER (1)
- 93 ROBERT G. & JOANN SHALUSIS (1)
- 94 WYNNE T. & MARY J. GLENN (1)
- 95 FRANCIS & PESSY L. DONNA (1)
- 96 FREDERICK J. & FRANCES M. REYNOLDS (1)
- 97 FREDERICK J. & FRANCES M. REYNOLDS (1)
- 98 DOROTHY L. PYLE (1)
- 99 DOROTHY L. PYLE (1)
- 100 JERRY L. & GESSIE M. CLAIR (1)
- 101 FRANK P. & DA D. OLEJA (1)
- 102 JERRY L. & GESSIE M. CLAIR (1)
- 103 MICHAEL W. BRENDEL (1)
- 104 RANDY RAY FISHER & JOANN MARSH (1)
- 105 JOHN W. & MARY JANE MAUST (1)
- 106 RICHARD E. SEBENA (1)
- 107 RICHARD E. SEBENA (1)
- 108 ROBERT W. & BETTY V. BRENDEL (1)
- 109 JOHN W. & RUTH L. SARVER (1)
- 110 JOHN W. & RUTH L. SARVER (1)
- 111 LUCIO D. & BRENDA M. BARBON (1)
- 112 DANNETT VALLEY FARMS INC. (1)
- 113 DEAN R. & EILEEN J. WALSH (1)
- 114 KENNETH W. & MARY K. JOHNSON (1)
- 115 BARRY LEE & JACQUELINE RAE FRANKER (1)
- 116 PATRICK C. & SHARON M. MADIGAN (1)
- 117 FRANK E. & MARGA A. NEH (1)
- 118 MARK D. MORAVCEZ (1)
- 119 ALFRED R. & RUTH V. SHOFER (1)
- 120 BARRY L. BRENNING (1)
- 121 DAVID E. & RUTH V. SHOFER (5)
- 122 MILTON R. & BONNIE L. YODER (1)
- 123 RONALD E. & MARLENE R. REID (1)(4)
- 124 JANE ANN WOLFORD (3)
- 125 TRACY JO SHALUSIS (1)
- 126 MARION M. BERKEY (1)
- 127 SENATE COAL MINES, INC. (1)
- 128 WILLIAM B. FRIEDLINE (1)
- 129 SENATE COAL MINES, INC. (1)
- 130 C/O CRK TRANSPORTATION CO., INC. (1)
- 131 GEORGE MATTHEW (4)
- 132 RICHARD E. & SANDRA BURMBARGER (1)
- 133 HARRY A. & KAREN E. SHOFER (1)
- 134 RICHARD E. & SANDRA BURMBARGER (1)
- 135 JAMES P. FLETCHER & PAUL FREDERICK (1)
- 136 GLENN S. & JUDY A. ASH (1)
- 137 MARK E. & GERDA M. DYLOR (1)

EXHIBIT 19.2- ENVIRONMENTAL RESOURCES MAP

DUNAMIS RESOURCES, INC.
MILLER DEEP MINE

UPPER FREEPORT COAL SEAM REVISED

Jenner and Lincoln Townships, Somerset County, PA

Scale: 1" = 400' Date: JUN 18 1996

Drawn By: MP,DZ
Checked By: RLM
Date: 2/12/96
Revised Date: 3/18/96
DWG. NO. DUNSURY

MEI
Musser Engineering, Inc.
RD 1 Central City, PA 15926
(814) 754-8477

MODULE 19 PAGE 2