

MEUSA  
1<sup>ST</sup> LEVEL

10/30/72

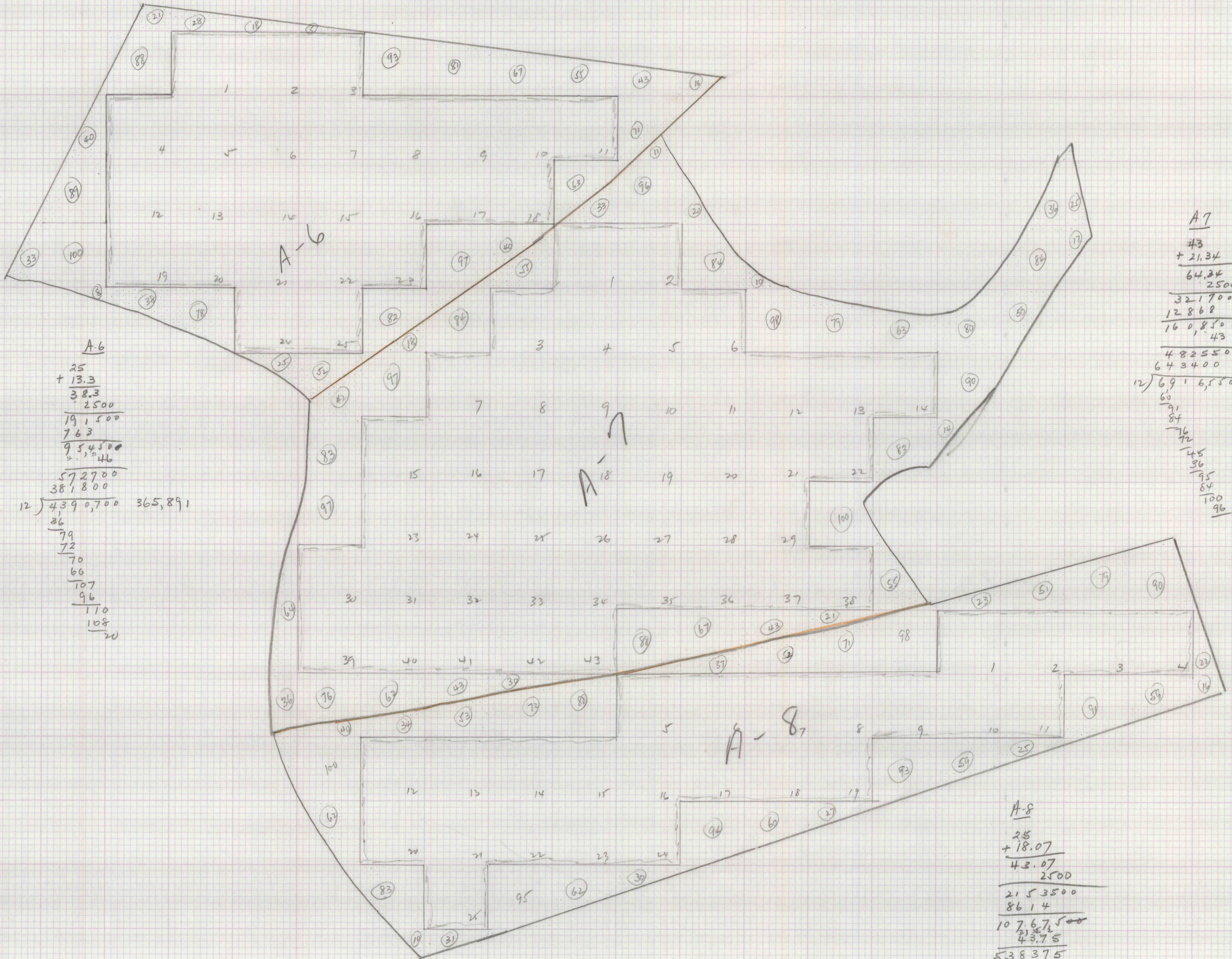

A-6  
 25  
 + 13.3  
 38.3  
 2500  
 19,500  
 763  
 95,450  
 5,146  
 57,270  
 38,800  
 12 ) 4390,700 365,891  
 36  
 79  
 72  
 70  
 66  
 107  
 96  
 110  
 108  
 20

A-7  
 43  
 + 21.34  
 64.34  
 2500  
 32,170.00  
 12,868  
 160,850  
 16,143  
 48,250  
 64,340  
 12 ) 691,650 57,637.8  
 60  
 91  
 84  
 76  
 72  
 45  
 36  
 95  
 84  
 100  
 96

A-8  
 25  
 + 18.07  
 43.07  
 2500  
 21,535.00  
 8614  
 107,675  
 2,250  
 43.75  
 53,837.5  
 7,537.25  
 3,230.25  
 43,070  
 12 ) 4710,781.25 384,231  
 36  
 101  
 96  
 50  
 48  
 27  
 24  
 38  
 36  
 21