

**NOTICE**

The information contained on this map should not be considered as exhaustive or conclusive as to the actual economic mineability of any particular site. The information displayed is drawn from mining maps, cross-sections, and aerial photographs which are believed to be reliable, but cannot be absolutely verified as such. Areas indicated as potential surface mining sites are recommended for further investigation and not warranted as having been proven to be economically viable.

Indicated coal resource tonnages are derived from such information as is currently available and should be considered to be approximate estimates. Coal thickness values are based upon the average of net coal thicknesses (not "vein" thicknesses) shown on available mining maps adjusted for average dip of the coal veins. Coal density is assumed to be 0.047 short tons per cubic foot. All coal areas are treated as having been previously mined underground with a net original average recovery of 60 percent. All figures are coal in-place and do not allow for potential operational mining losses.

Legal, environmental, marketability or other non-mining factors have not been considered.

**LEGEND**

- COAL OUTCROP
- SYNCLINE AXIS
- ANTICLINE AXIS
- THRUST FAULT TRACE (BARBS ON OVERTHRUST BLOCK)
- APPROXIMATE AREA OF PAST STRIP MINING
- ESTIMATED AREA OF CURRENTLY FEASIBLE STRIP MINING
- CROSS-SECTION LINE
- PROPERTY BOUNDARY
- CULLM BANK AND SETTLING POND OUTLINES

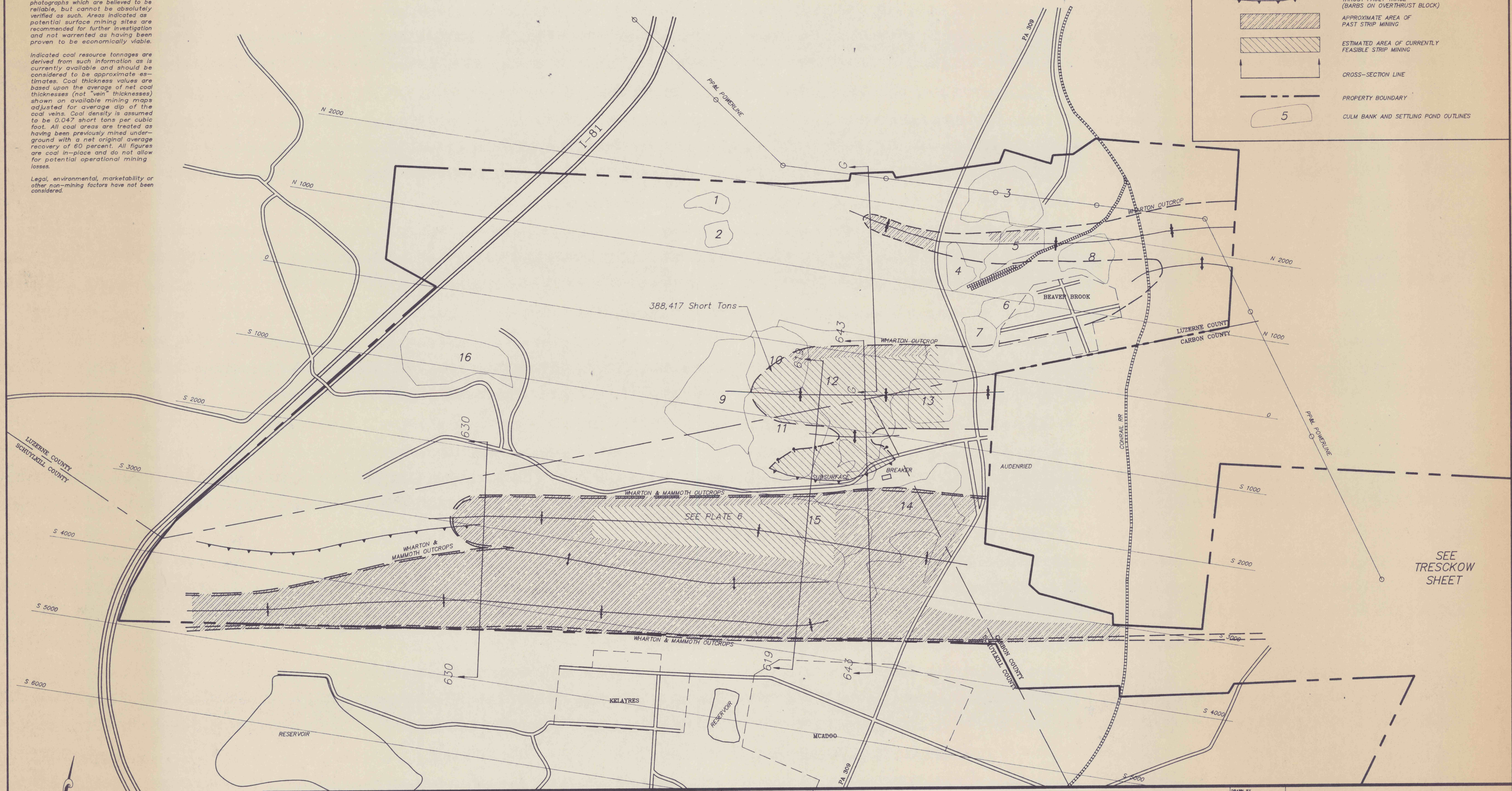

SEE TRESCKOW SHEET

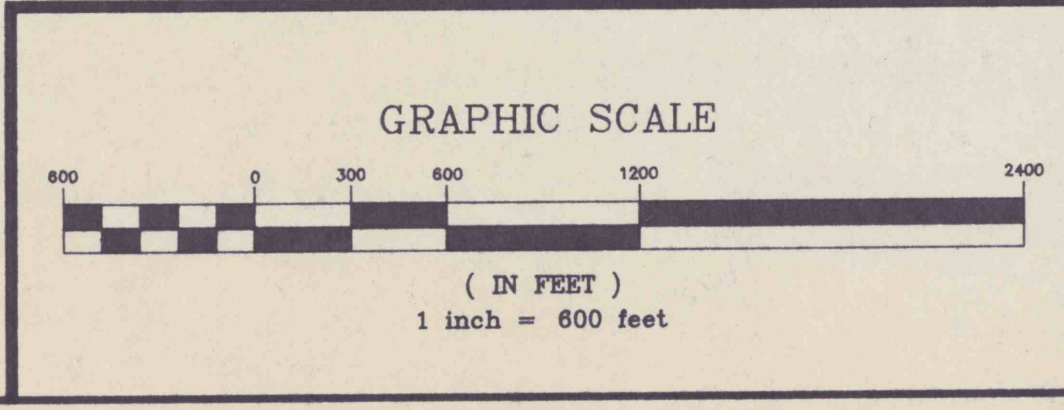

NO.	DATE	REVISION DESCRIPTION	BY

**DRAFT COPY**  
 Prepared by  
 William E. Edmunds  
 Professional Geologist  
 Reg. No. 000117

**TETHYS Consultants, Inc.**  
 Specializing in Earth and Environmental Sciences  
 Suite 234, Building 3, 2001 N. Front Street  
 Harrisburg, PA 17102  
 717-BED-ROCK      717-233-7625

DRAWN BY	SRL
APPROVED BY	WEE
DATE	06/30/94
SCALE	1"=600'
CONTOUR	N/A
PROJECT NO.	T-1193
DRAWING NO.	T-1193-005

**PLATE 5**  
**COAL RESOURCES OF THE**  
**HONEY BROOK-BEAVER BROOK PROPERTY**  
**WHARTON VEIN & WHERE JOINTLY**  
**MINEABLE, MAMMOTH & WHARTON VEINS**  
**BELTRAMI ENTERPRISES, INC.**  
**LUZERNE, CARBON, & SCHUYLKILL COUNTIES**  
**PENNSYLVANIA**