

37-L
568

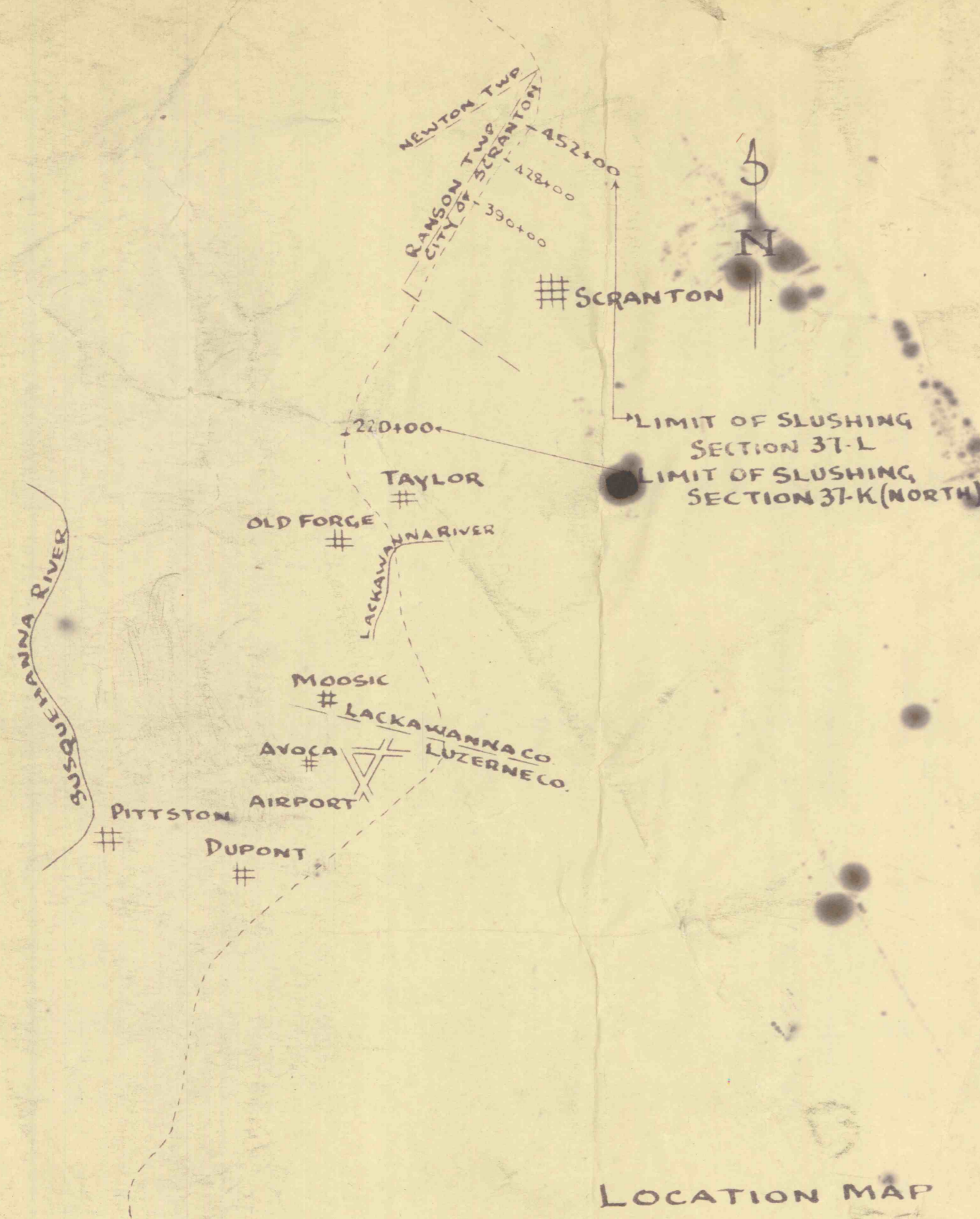

SECTION 37-K(NORTH) ← SECTION 37-L

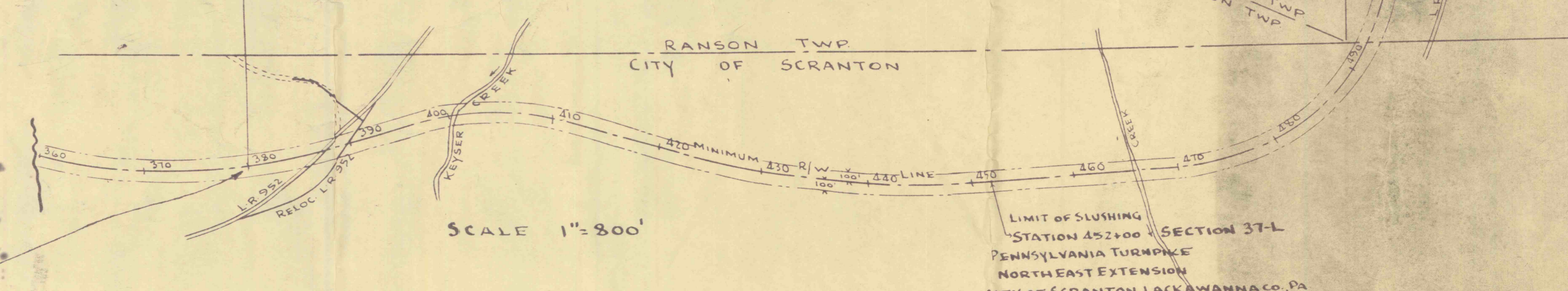

SLUSHING OF MINE VOIDS
 SELECTED SECTIONS OF 37-K(NORTH) & 37-L
 IN LACKAWANNA CO., PA.
 FROM STA. 140+00 TO STA. 390+00
 &
 FROM STA. 428+00 TO STA. 452+00
 SCALE VARIOUS

LIMIT OF SLUSHING
 STATION 452+00 SECTION 37-L
 PENNSYLVANIA TURNPIKE
 NORTHEAST EXTENSION
 CITY OF SCRANTON, LACKAWANNA CO., PA