

Handwritten notes in the top left corner, including "S. H. A." and "1948".

1-B-95

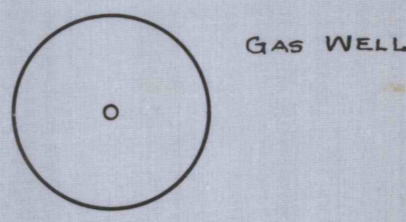

MURDOCK

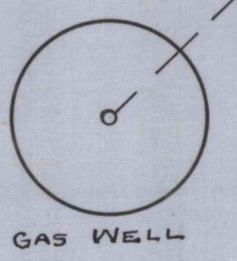
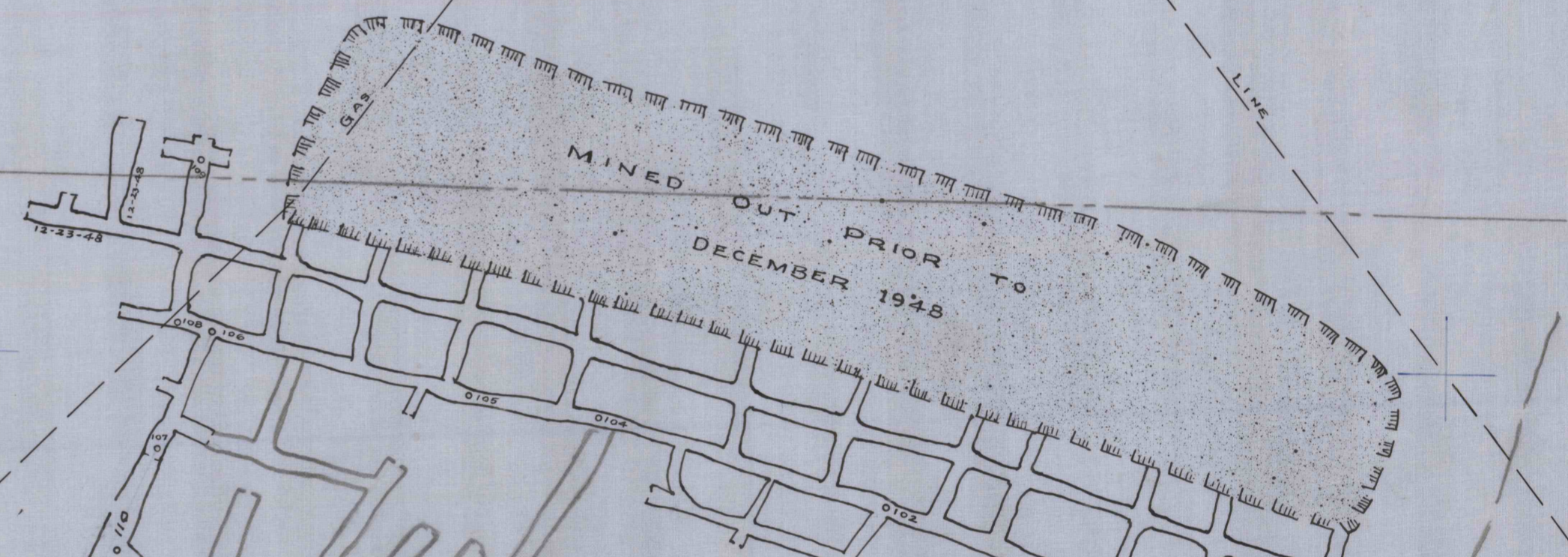
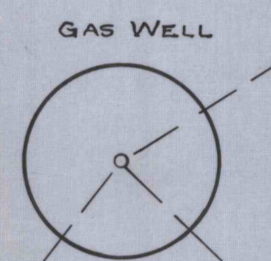

KENNEDY

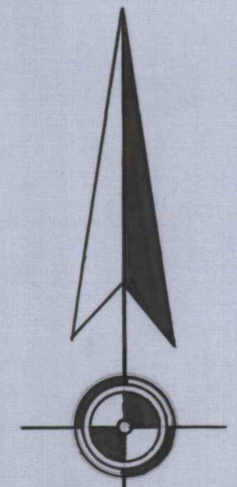

MINE MAP
A. H. KENNEDY & SONS
MINE

PERRY TOWNSHIP JEFFERSON COUNTY
SCALE 1" = 100' DECEMBER, 1948
Walter J. Zimmerman Surveyor Punxsutawney, Pa.

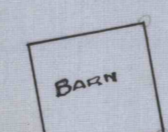
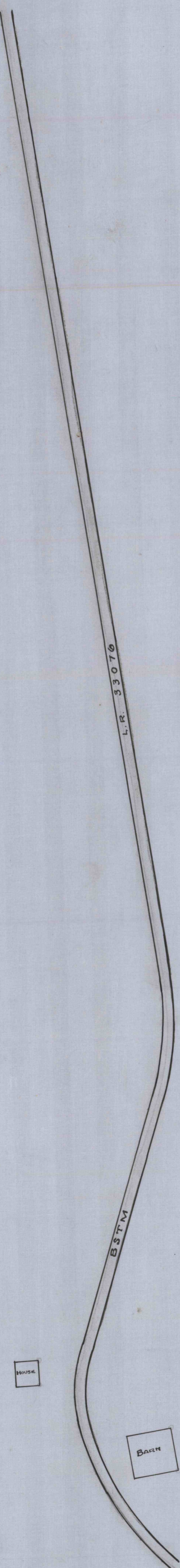

JEF-98