

2-D-49

W. W. SMITH

Reserve

27

27

JOSEPH MITCHELL

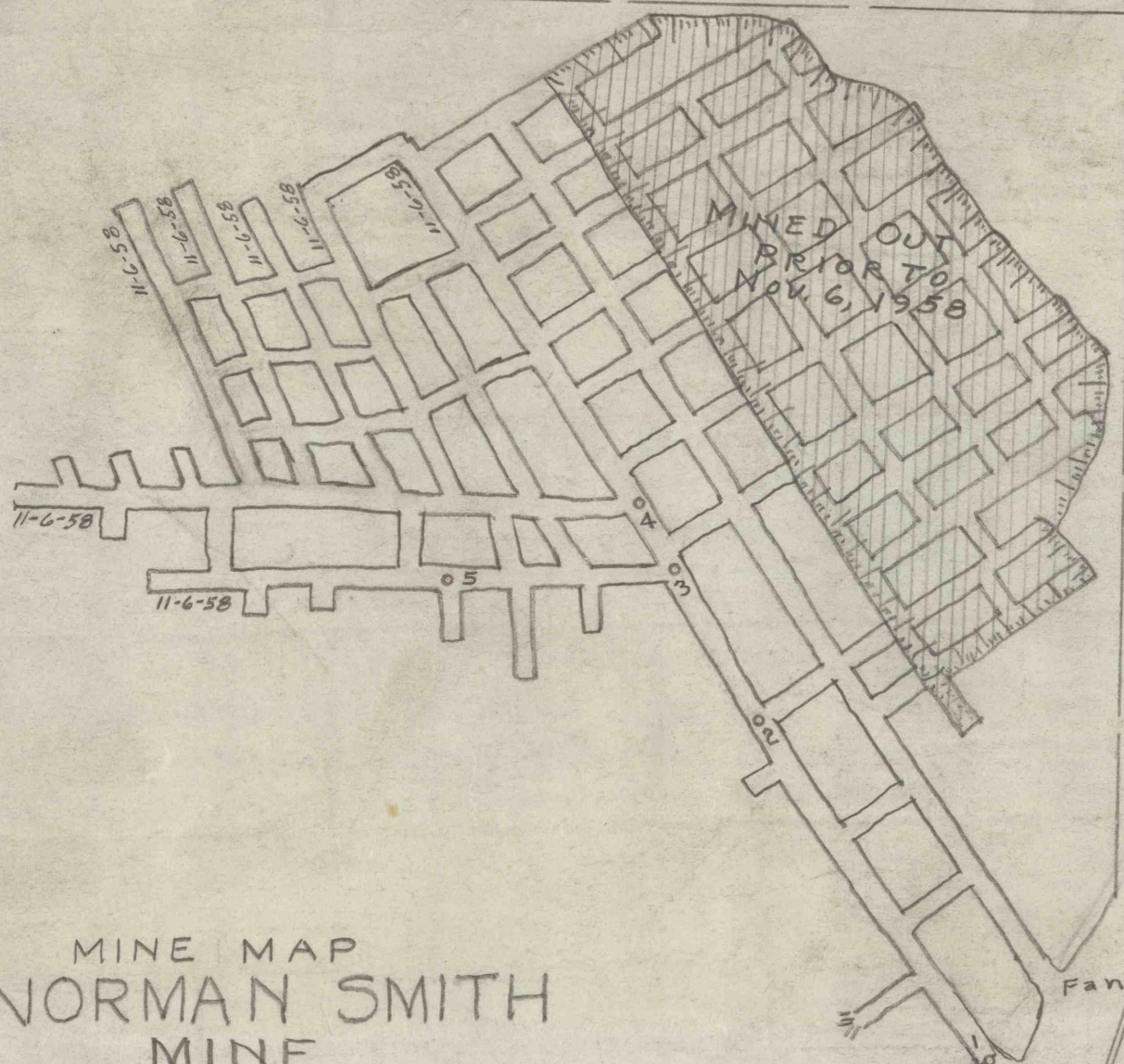

JOHN J. HUMBLE

MINE MAP
 NORMAN SMITH
 MINE

Perry Township, Jefferson County, Pa.
 Scale 1" = 100' Nov. 6, 1958
 Walter J. Zimmerman Surveyor Engineer Punxsutawney, Pa.

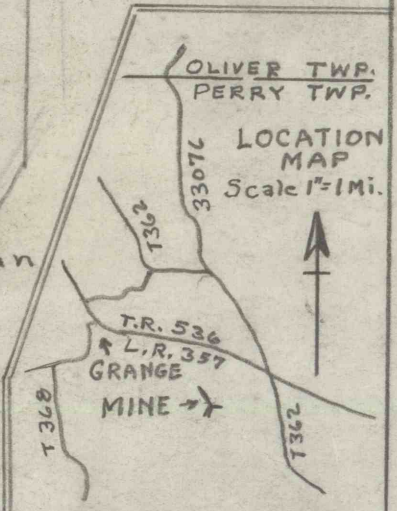

2-D-49

2-D-49

2BE-103