

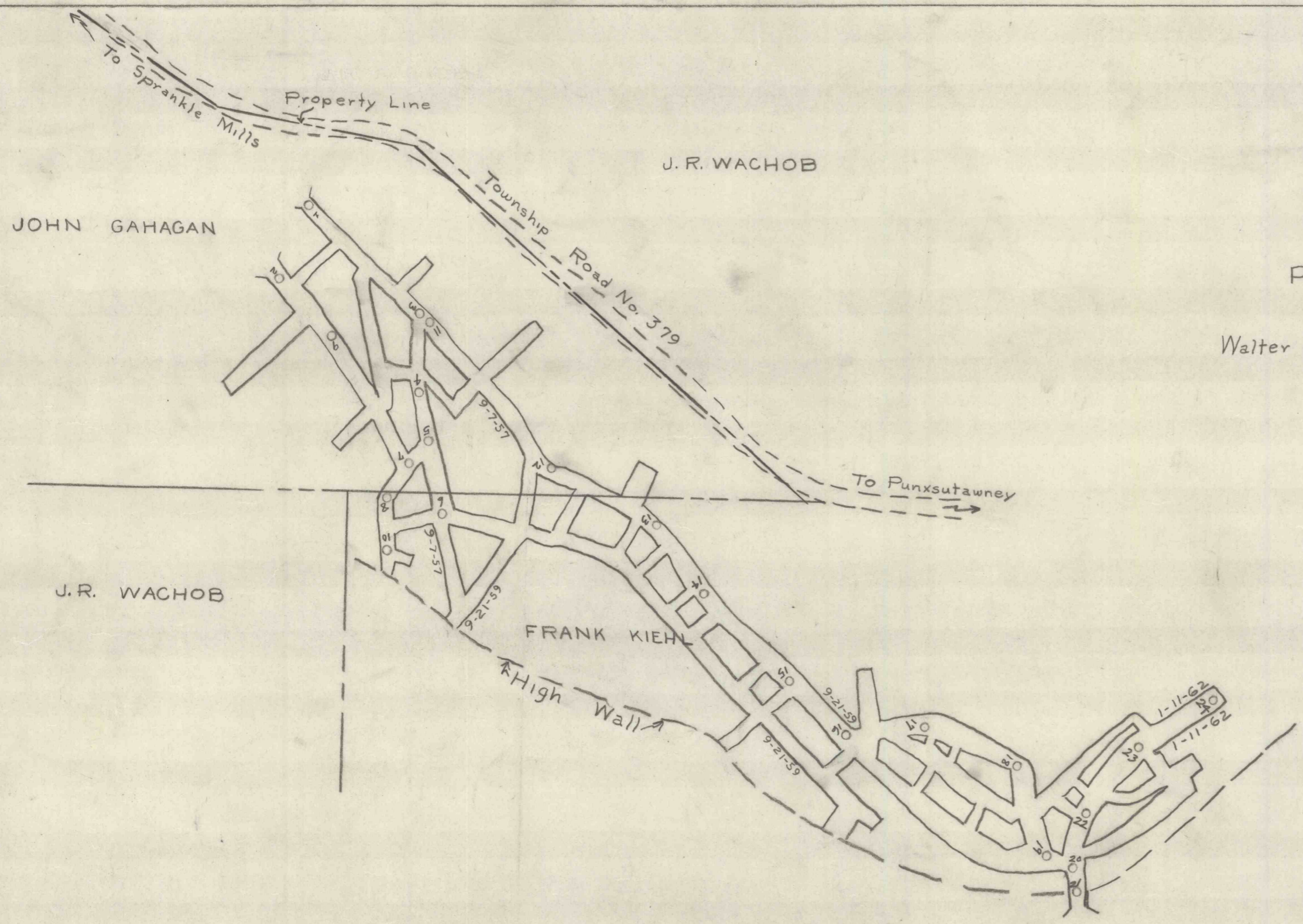

MINE MAP  
HOWARD MILLER  
COAL MINE

Perry Township, Jefferson County, Pa.  
Scale 1"=100' January 19, 1962  
Walter J. Zimmerman-Registered Engineer-Punxsutawney, Pa.

101-748



2-D-15

Date of Surveys  
Oct. 1, 1957  
Sept. 21, 1959  
Jan. 11, 1962

*Howard Miller  
Perry Township, Jefferson County, Pa.*

2-D-15