

HORN.

GRIFFITH.

2000.00 S.

P. 57

SHERMAN.

TIMBLIN & WEBER.

DINGER.

← 50°47'W

517.00'W
153'

512.00'W
187'

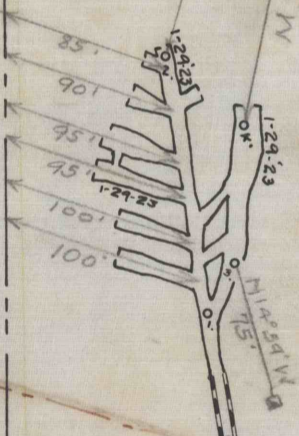

Proposed AIRSHAFT

1000.00 S.

1408' TO COR.

1408' TO COR.

TIMBLIN & WEBER MINE MAP

BANKS TWP. INDIANA CO. PA.

SCALE 1" = 100' FEB. 5, 1923

H.M. KANARR ENGR.

1000.00 S.

Notes: M-26 Pg 25-59

Drawing: 2-B-7

Tracing: 2-B-7

Traverse: L&TB Vol #1

F-26 Pg 25-59