

35

MATCH TO SHEET 4

Subsidence Legend

Previous Six-Month's Mining

Contemplated Mining

Mining Completed

Subsidence Control Plan Boundary

Occupied Dwellings

Unoccupied Structures

SUPPORT AREAS:

No Mining Within

50 Percent Mining Only Within

NOTE: Any Pillar That Straddles A Support Line Will Remain In Place

I, Randall L. Musser, a Professional Land Surveyor in the Commonwealth of Pennsylvania, hereby certify that the surveying and mine mapping conducted by Musser Engineering, Inc. after June 1, 1993, was conducted in accordance with generally accepted surveying standards for the mining industry, and is true and correct to the best of my knowledge and belief. All base map preparation for the mine, and all mine surveying and mapping prior to June 1, 1993, was conducted by and certified by the engineering staff of Valley Coal Company and is not the responsibility of Musser Engineering, Inc.

MATCH TO SHEET 6

ROOMS - SEE FACE SHEET NO. 7

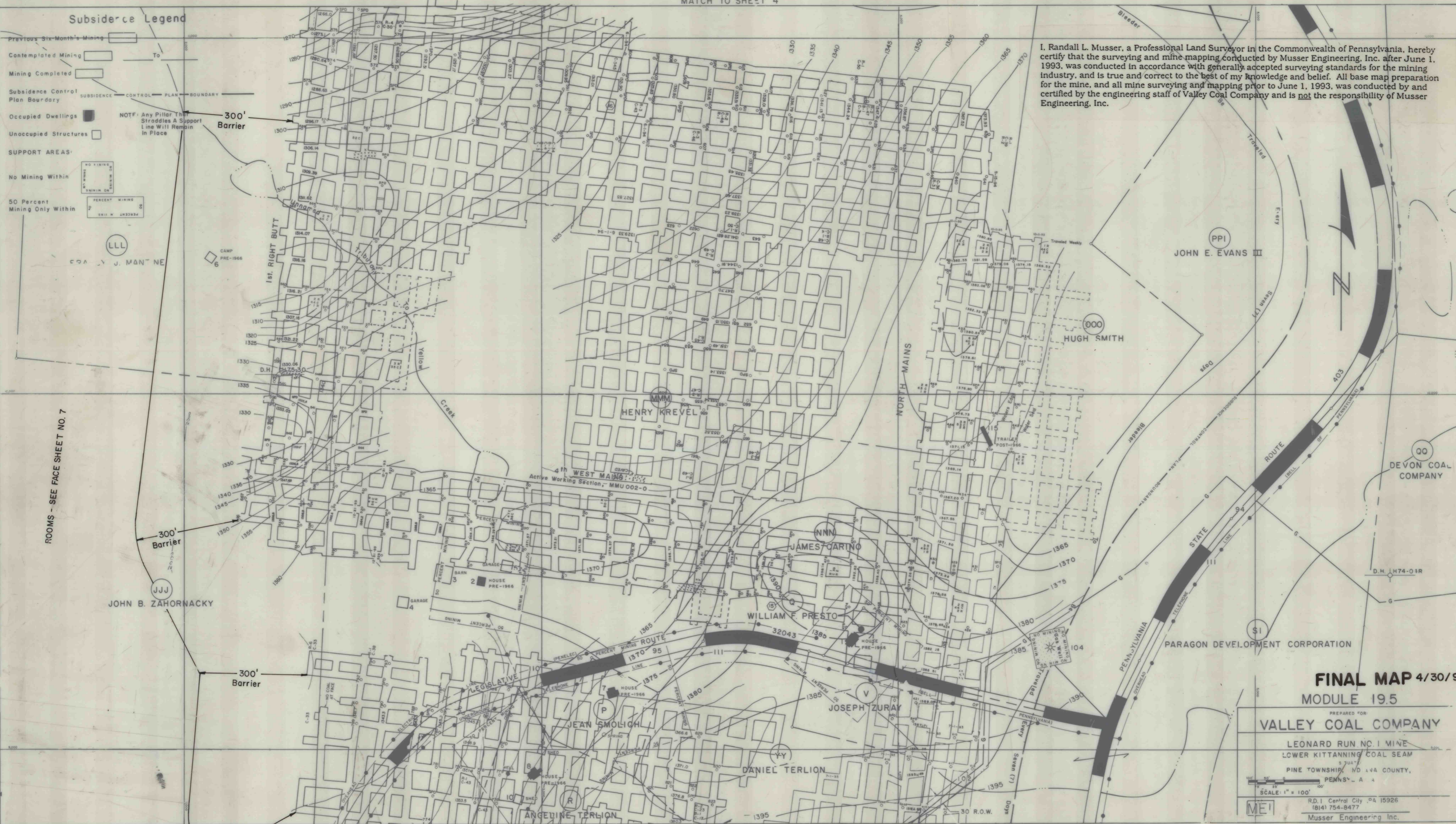

FINAL MAP 4/30/98

MODULE 19.5

PREPARED FOR
VALLEY COAL COMPANY

LEONARD RUN NO. 1 MINE
LOWER KITTANNING COAL SEAM

PINE TOWNSHIP, W. VA. COUNTY,
PENNSYLVANIA

SCALE: 1" = 100'



R.D. 1 Central City, PA 15926
(814) 754-8477

Musser Engineering Inc.

SHEET 3 OF 0

MATCH TO SHEET 2