

MC-7

COAL LANDS OF THE PENN CENTRAL POWER CO.

SITUATE IN

BROAD TOP TOWNSHIP, BEDFORD COUNTY,
AND CARBON TOWNSHIP, HUNTINGDON COUNTY, PA.

SCALE: 1"=400'

JOS. S. SILLIMAN & CO.
ENGINEERS
ALTOONA, PA.

MINE WORKINGS SHOWN TO DATE OF _____

NOTE: - PROPERTY LINES FROM SURVEY, SHOWN THUS: ————

" " " " DEED DESCRIPTION, SHOWN THUS: - - - - -

PROJECTION OF WORKINGS
IN THIS CASE FROM SURVEY
FOR DETERMINATION OF DEVELOPMENT RIGHTS
MAY BE MADE

NOTE: -
FULTON PROJECTIONS SHOWN IN RED.
SPENCER PROJECTIONS SHOWN IN WHITE.

OFFICE COPY

KRY COAL MINING CO.

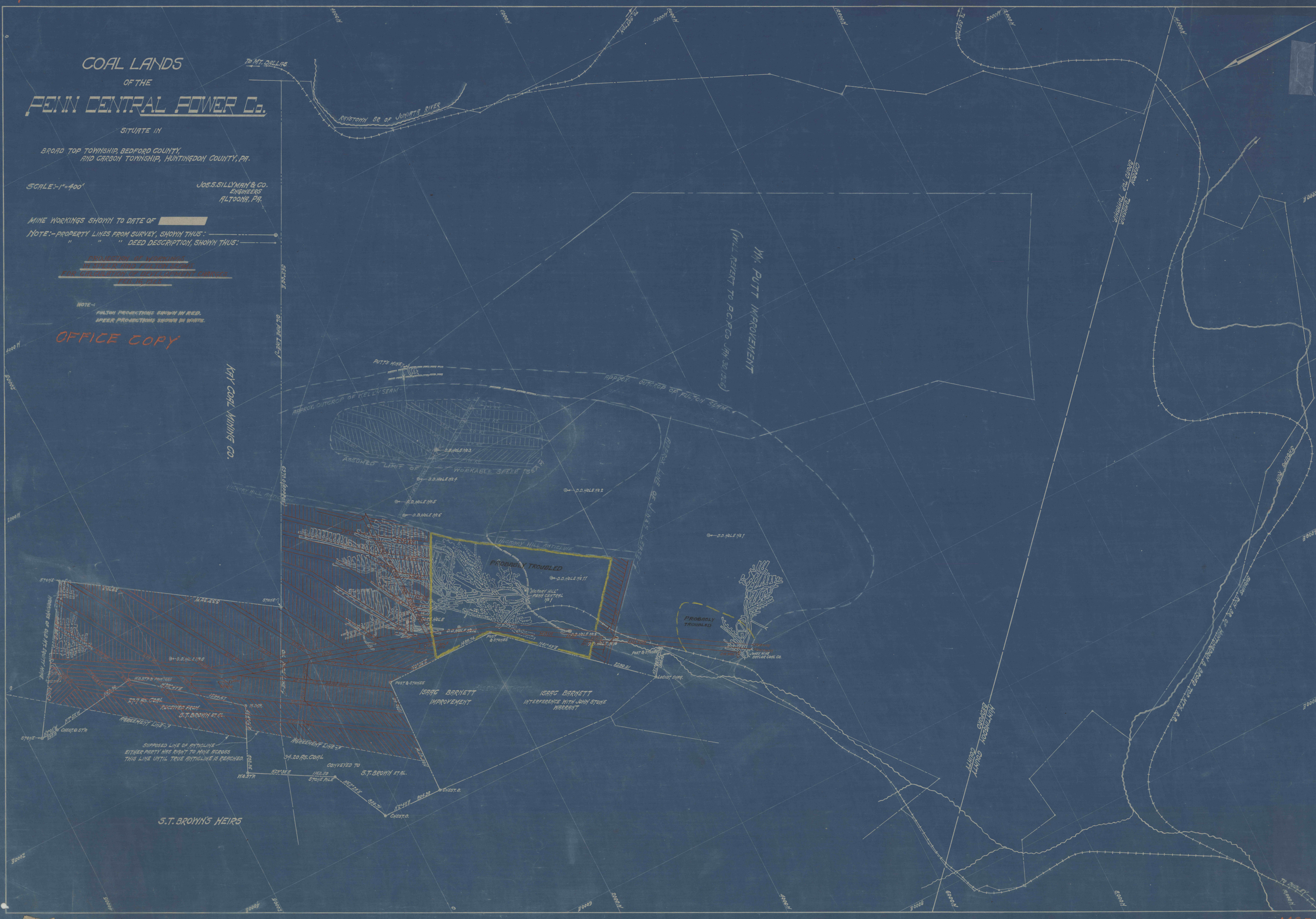

MC-7