

PLAN OF EXISTING MINE SEAL NO 4
SCALE: 1"=50'

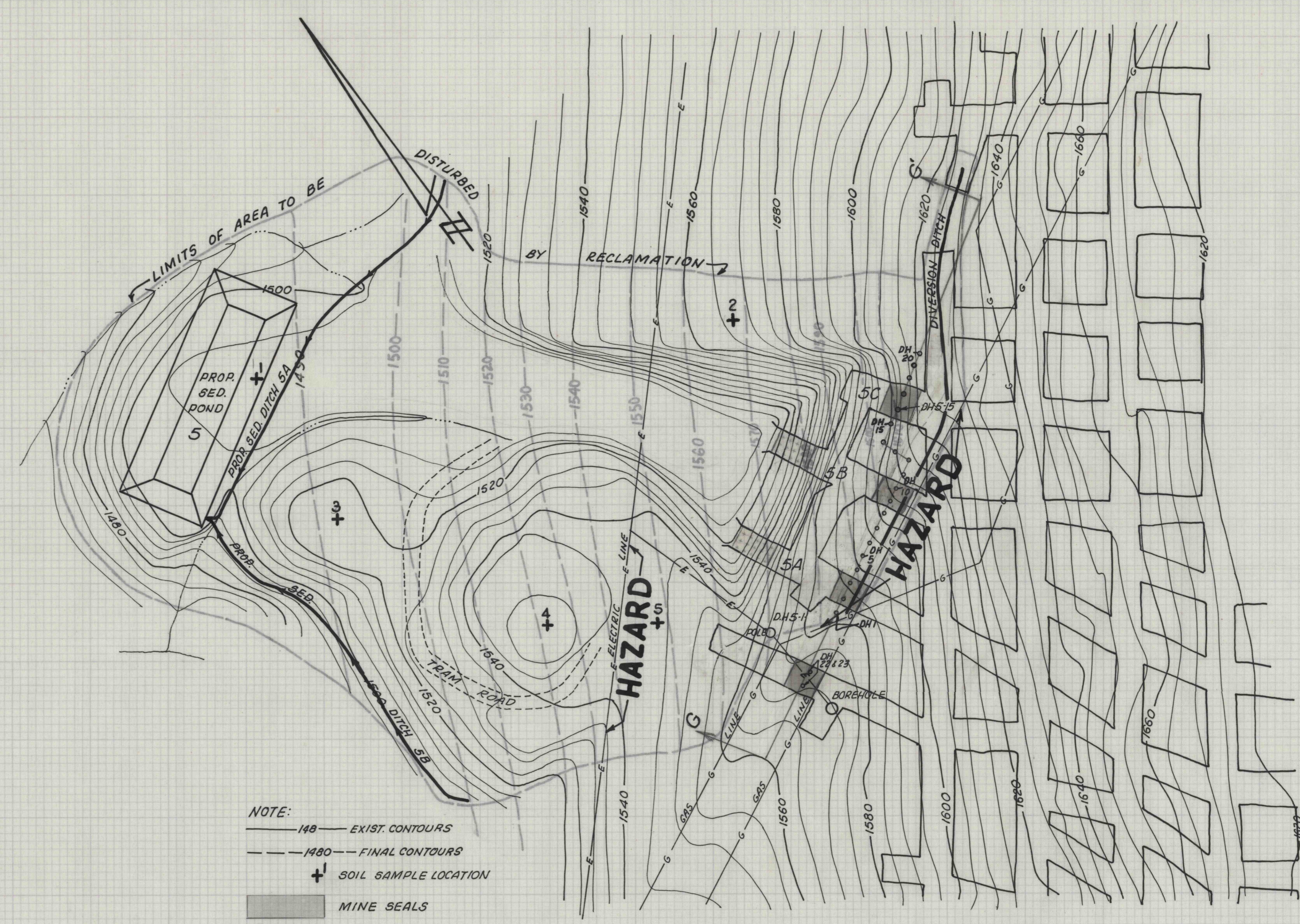

- NOTE:
- 148 — EXIST. CONTOURS
 - 1480 — FINAL CONTOURS
 - + SOIL SAMPLE LOCATION
 - MINE SEALS
 - ▨ CLAY PLUGS

PLAN OF MINE SEAL NO 5
SCALE: 1"=50'

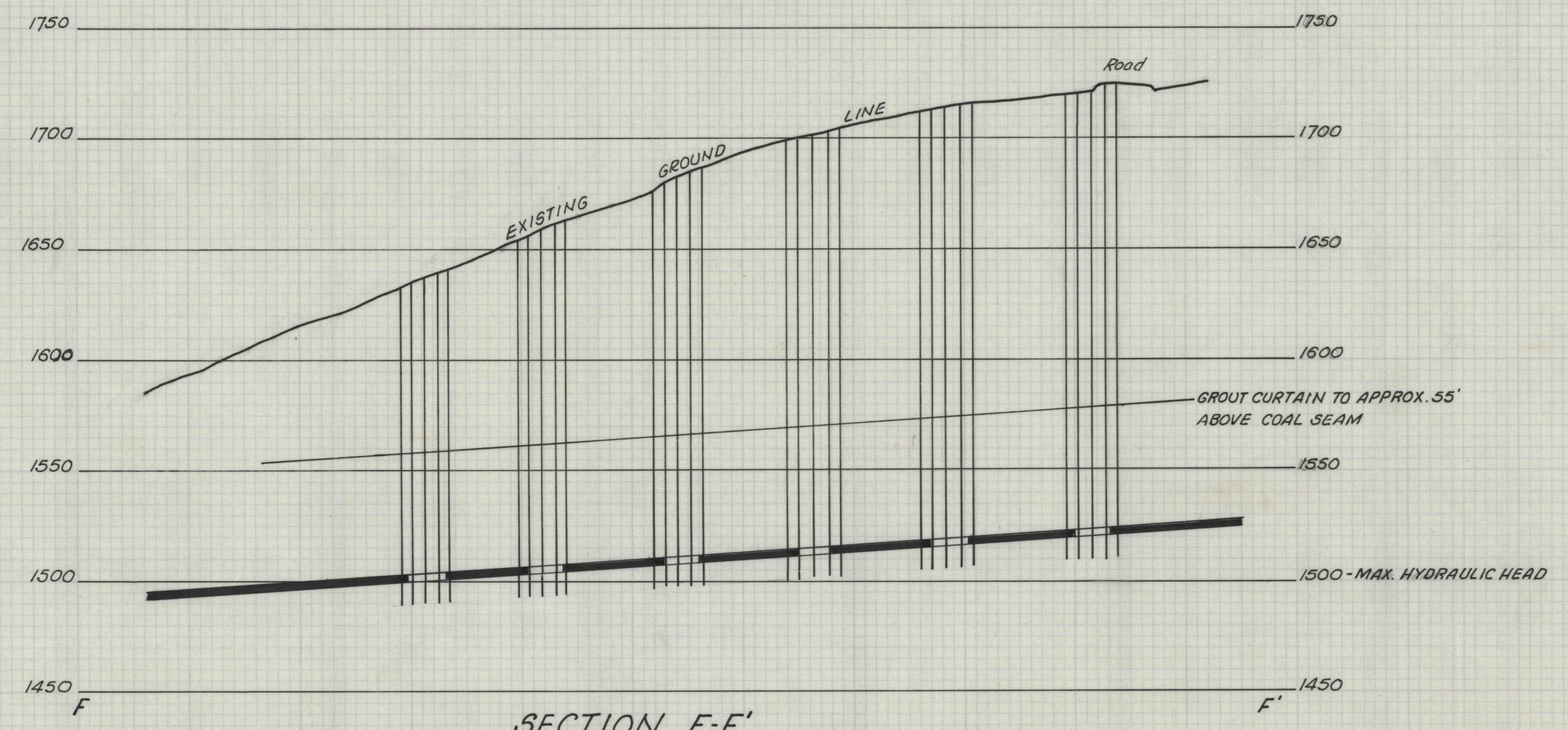

SECTION F-F'
SCALE: 1"=50'

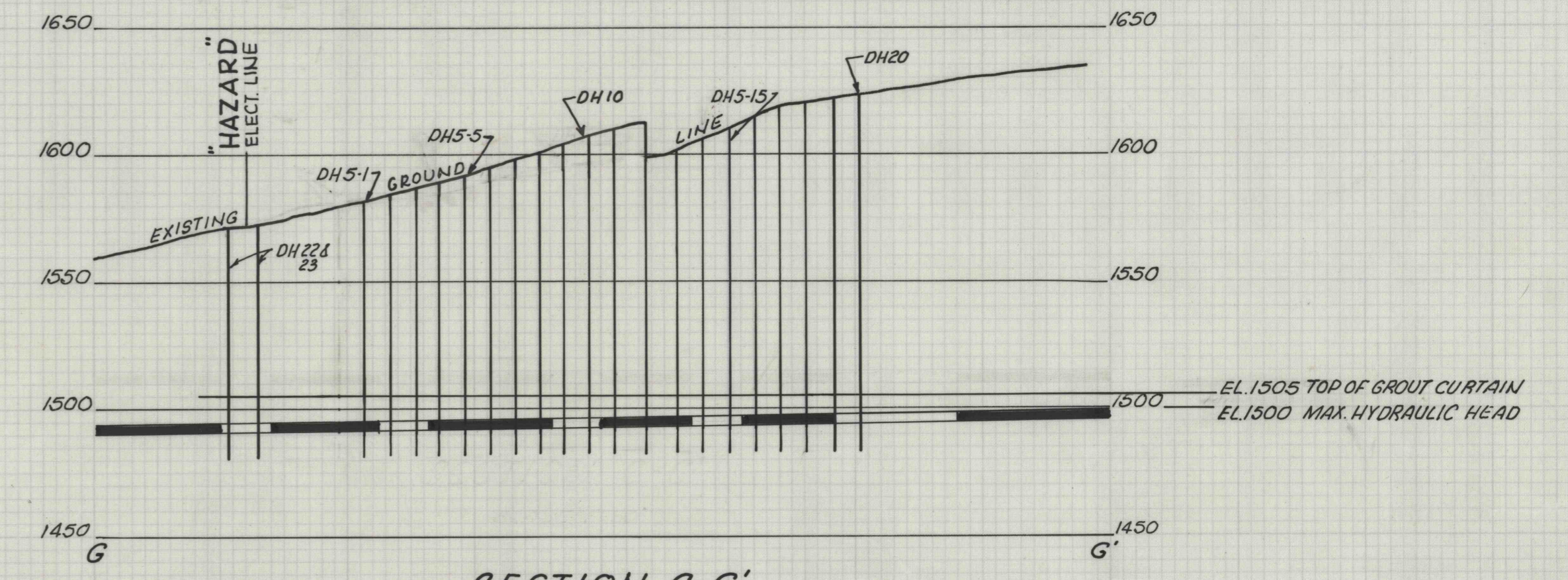

SECTION G-G'
SCALE: 1"=50'

MINE CLOSURE PLAN
FOR
LADY JANE COLLIERIES, INC.
MINE SEAL AREAS 4 & 5
HUSTON TWP, CLEARFIELD CO., PA.

| | | |
|--------|---|----------|
| SCALE | GWIN, DOBSON & FOREMAN, INC. | SHEET NO |
| 1"=50' | CONSULTING ENGINEERS ALTOONA, PENNSYLVANIA | 5 of 12 |