

1: 1516.5  
 2: Shaft 7'6" to top of coal  
 coal 40"  
 eleva 1489.3  
 3: 1533.3  
 4: Shaft 15' top of coal  
 coal 5'6"  
 eleva. 1473.4

5: 1567.9 to to Ridge  
 Ryder  
 28 1/10 ds. coal  
 6: Shaft  
 coal 5'6"  
 eleva. 1471.4  
 7: Shaft 12' top of coal  
 coal 6'  
 eleva. 1489.0

8: Ryder Drift  
 coal 39"  
 eleva. 1496.6  
 9: Drift  
 coal 5'6"  
 10: Heckendorn  
 6 9/10 As coal

11: Heckendorn drift  
 coal 5' to 5'6"  
 eleva. 1460.8  
 12: Fielding Drift  
 eleva. 1484.8  
 coal 37"  
 bone 3"  
 coal 8"

13: 1513.8  
 14: 1491.7  
 15: 1434.5

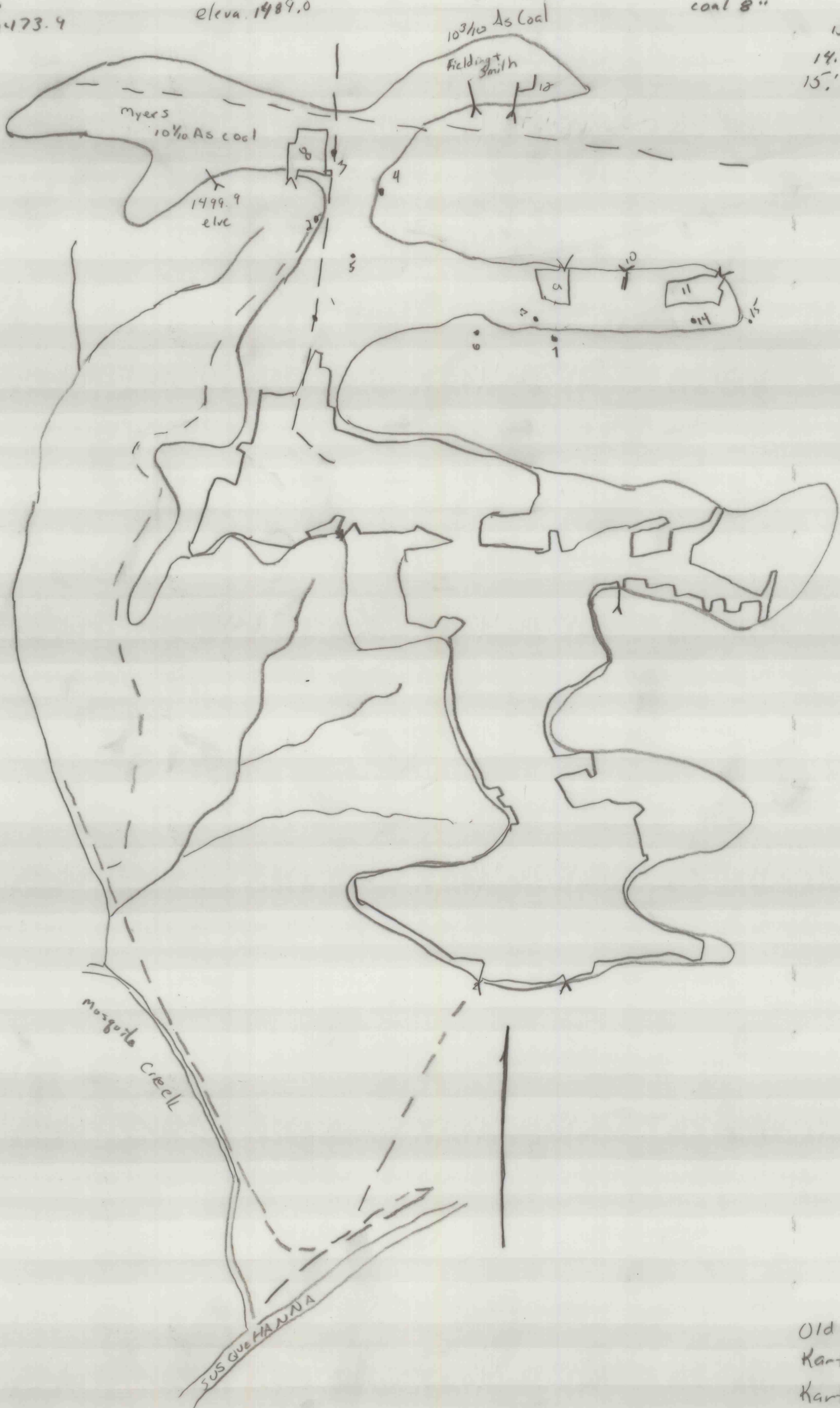

Old workings  
 Karthaus estate  
 Karthaus