

TEST HOLES				
H. No.	Surface Elevation	Bottom of Coal	Water Level	
1	1493.7	1526.7	1561.7	
1A	1620.7	1526.7	1531.8	
2A	1591.5	1526.8	1488.3	
3A	1605.9	1524.1	1502.8	
4A	1629.3	1523.9	1522.8	
14	1614.0	1554.0	1520.0	
15	1627.7	1556.2	1518.7	
16	1630.3	1551.3	1518.7	
17	1611.2	1553.2	1512.2	
18	1632.4	1540.9	Dry	
19	1624.2	1541.2	Not Noted	
20	1600.1	1556.1	1534.1	1506.6
21	1601.1	1556.6	1533.1	1498.1
22	1612.1	1536.1	Not Noted	
23	1603.5	1523.5	1509.0	
24	1606.6	1520.6	1496.6	
25	1614.9	1529.4	1493.9	
26	1618.8	1553.1	1528.1	
27	1627.9	1530.2	1507.9	
28	1598.9	None	1591.7	
29	1598.8	None	Dry	
197	1609.7	1521.7	1485.7	
198	1611.3	1523.8	1489.8	
199	1617.5	1517.5	1491.5	
201	1590.7	1569.7	1525.7	1488.7
202	1576.3	1574.3	1527.3	1490.8
203	1596.8	1556.7	1521.7	1486.7
204	1593.7	1558.7	1523.7	1494.7
205	1596.1	1550.1	1530.6	1493.1
206	1596.0	1558.0	1533.0	1495.0
207	1596.7	1557.7	1528.7	1502.7
208	1617.0	1566.3	1543.3	1511.3
209	1645.4	1569.4	1549.4	1516.4
210	1605.4	1578.0	1548.0	1517.4
211	1595.2	1559.2	1525.7	1494.7
212	1609.9	1588.9	1534.4	1514.4
213	1613.3	1574.3	1548.3	1509.3
215	1575.5	1525.5	1496.5	1508.5
201	1561.7	1533.7	1497.7	1504.2
202	1534.9	1506.9	Dry	

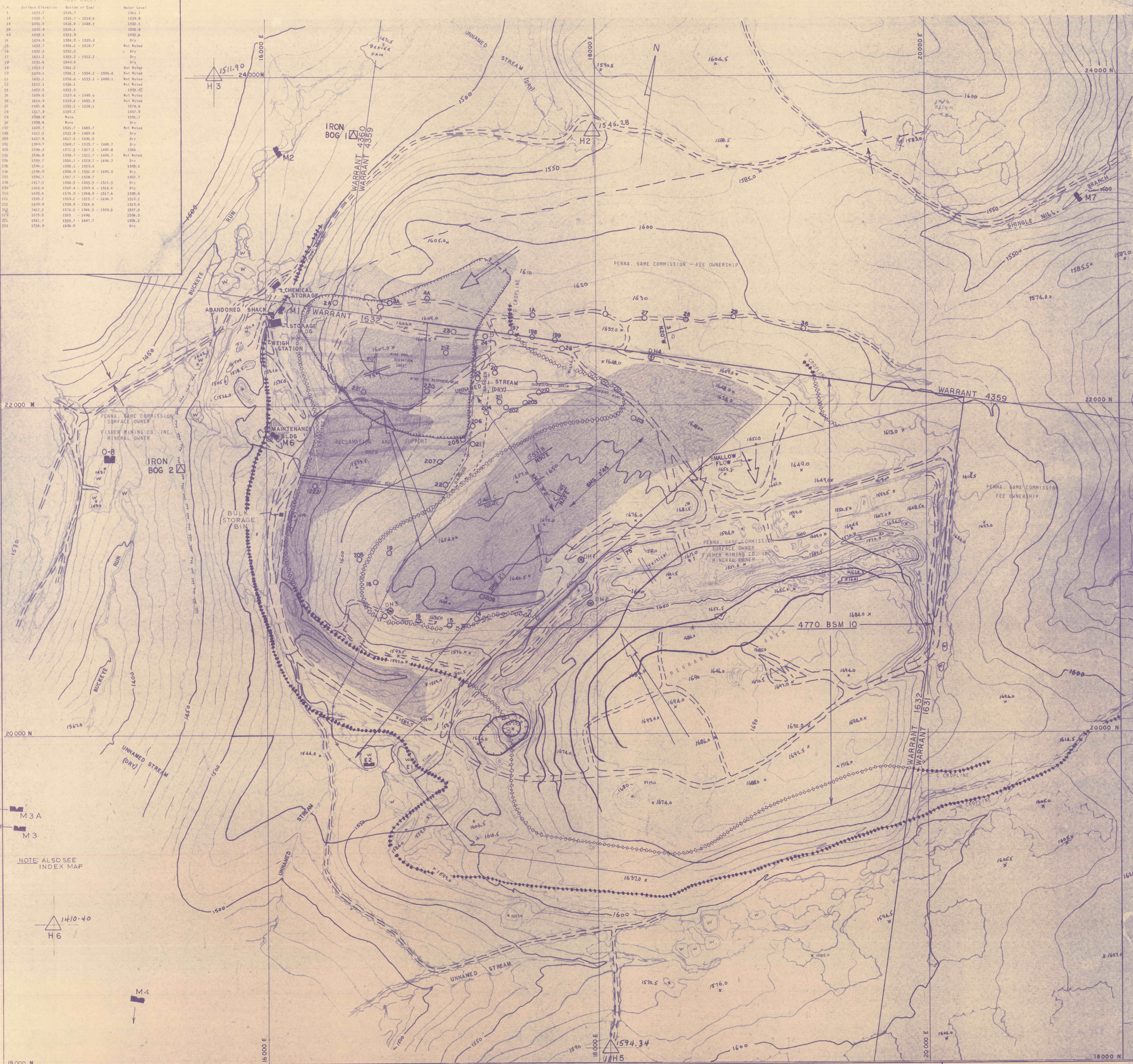

REVISIONS

NOTES

LEGEND

PROPOSED PERMIT	EXISTING PERMIT 4265010	EXISTING PERMIT 4770850	EXISTING MAIL ROADS	SLOPE MEASUREMENT	ESTIMATED LIMIT OF DEEP MINE POOL	TEST HOLE	STRIKE AND DIP	KITTANING (I) CROPLINE	MIDDLE KITTANING (C) CROPLINE	LOWER FREEPORT (D) CROPLINE	COAL (STRIPPED OUT)	GROUND WATER FLOW	PRIVATE MELL (FISHER)	MONITORING POINT (Also See Index Map)	OVERBORO ANALYSIS TEST HOLES	PROPOSED PERMIT SUPPORT AREA	IRON BOGS	FLOWS ABOVE COAL	SEEP LINE	UNDERGROUND MINED	SURFACE MINED	JOINT	751
-----------------	-------------------------	-------------------------	---------------------	-------------------	-----------------------------------	-----------	----------------	------------------------	-------------------------------	-----------------------------	---------------------	-------------------	-----------------------	---------------------------------------	------------------------------	------------------------------	-----------	------------------	-----------	-------------------	---------------	-------	-----

EXHIBIT 6.2 ENVIRONMENTAL RESOURCES MAP
 FISHER MINING CO., INC.
 PINE TOWNSHIP, LYCOMING COUNTY, PENNSYLVANIA
 SCALE 1" = 200 FEET CONTOUR INTERVAL = 10 FEET
 PREPARED BY
 BOYER KANTZ AND ASSOCIATES
 EDWIN F. KOPPE, GEOLOGIST
 MAY 1984