

W.G. MOORE & SON, INC.

SITUATE

RUSH TOWNSHIP, CENTRE CO., PA.

SCALE: 1" = 200' AUGUST 1978

GWIN, DOBSON & FOREMAN, INC.
CONSULTING ENGINEERS
ALTOONA, PENNSYLVANIA

LEGEND

- PROPERTY LINE
- FAULT
- 1750 STRUCTURE CONTOURS
- MK OUTCROP OR EXTENT OF MIDDLE KITTANNING SEAM
- 75' DEPTH OF COVER IN FEET
- CANNEL COAL AREA
- ⊙ DRILL HOLE
- 32" RESERVE HEIGHT

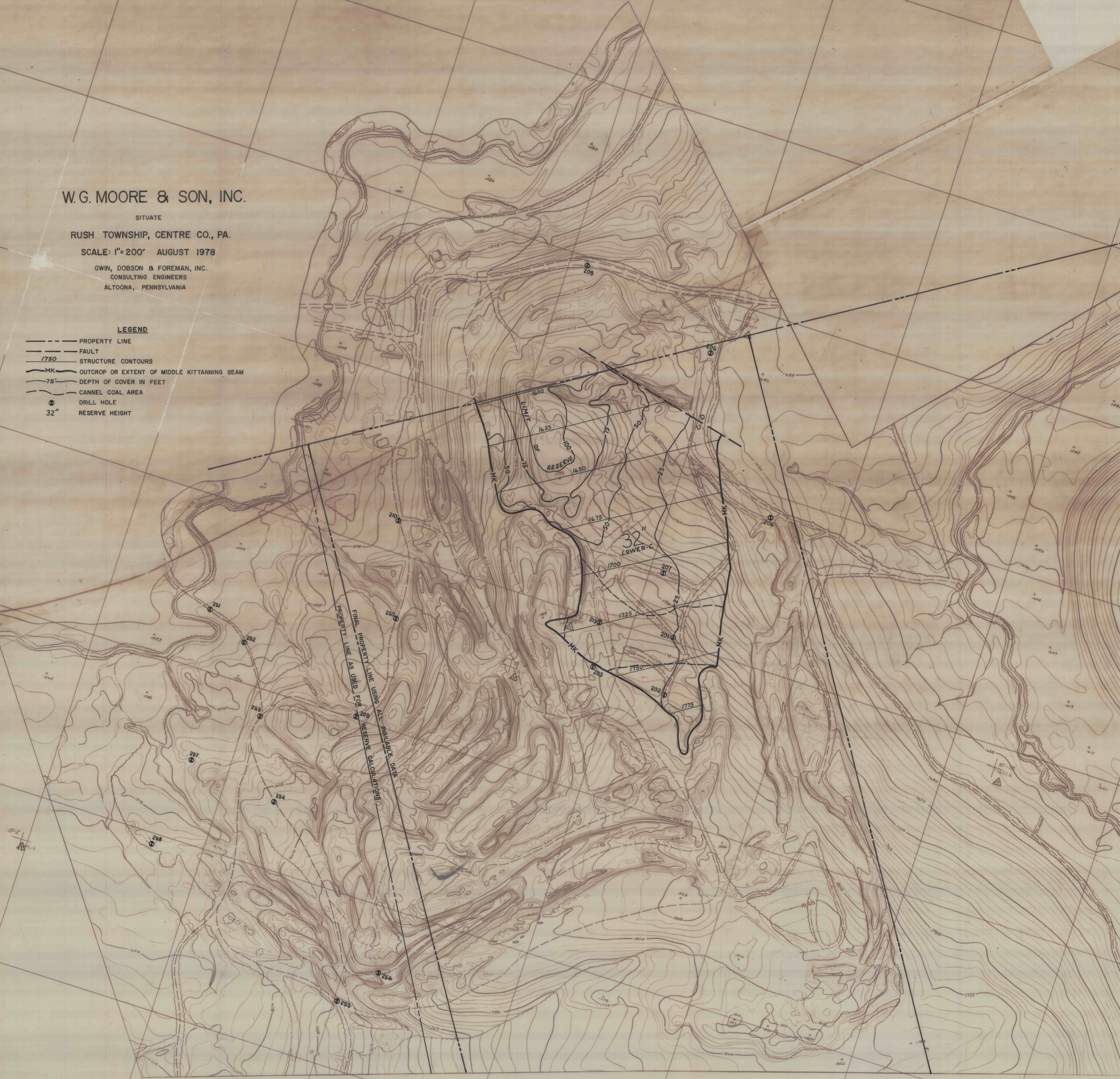

FINAL PROPERTY LINE USING ALL AVAILABLE DATA
PROPERTY LINE AS USED FOR RESERVE CALCULATIONS

LIMIT OF RESERVE

32" LOWER-C

5-2