

SAMPLING POINTS; BACKGROUND & MONITORING

NO	DESCRIPTION	FLOW (gpm)	pH	SURF. EL.
1	BARCOCK CREEK	150	3.5	2390
2	SEEP	10	6.0	2390
3	"	25	3.8	2375
4	DRILL HOLE	10	5.0	2441
5	DRILL HOLE	-	5.1	2465
6	MINE DISCHARGE	20	3.25	2562
7	SEEP	5	5.0	2570
8	"	10	5.1	2570
9	"	20	3.5	2560
10	"	5	3.5	2550
11	EPHEMERAL STREAM	75	5.4	2425
12	STRIP MINE DISCHARGE	190	3.5	2635
13	PAINT CREEK	50	3.65	2695
14	STRIP MINE DISCHARGE	25	3.4	2660
15	"	50	4.1	2410
16	PAINT CREEK	150	4.0	2500
17	UNNAMED TRIB. OF PAINT CREEK	100	4.15	2595
18	PAINT CREEK	250	3.7	2590
19	EPHEMERAL STREAM	250	3.7	2540
20	PAINT CREEK	250	3.7	2540
21	"	500	3.65	2515
22	"	-	3.4	2080
23	UNNAMED TRIB. OF BARCOCK CREEK	500	4.3	2150
24	BARCOCK CREEK	-	4.1	2120
25	"	-	4.0	2090
26	SEEP	7-10	-	2240
27	"	3-4	-	2270
28	"	10-15	-	2310
29	"	4	-	2260
30	"	2-3	-	2250
31	"	10-15	-	2180
32	STREAM	5	-	2695
33	PAINT CREEK	-	<4.0	1940

- LEGEND**
- STRIP MINED AREAS
 - DEEP MINED AREAS
 - DRILL HOLES
 - SAMPLING POINTS
 - PROP SEDIMENTATION PONDS
 - PROP TREATMENT FACILITIES
 - SLOPE MEASUREMENTS
 - DIRECTION OF GROUNDWATER FLOW
 - STRIKE & DIP
 - SEDIMENTATION DITCH
 - DIVERSION DITCHES

NOTE:
 All Areas To Be Affected By Mining Will Be Restored To AOC, And Will Be Returned To Premining Land Use With The Exception Of Strip Mine Which Will Be Returned To Forestland.
 All Ponds, Ditches & Haul Roads Will Be Removed Following Bond Release.
 Vegetative Mixes Will Be As Outlined On Page 10 And Will Be Consistent With Premining Land Use.
 Drainage Patterns

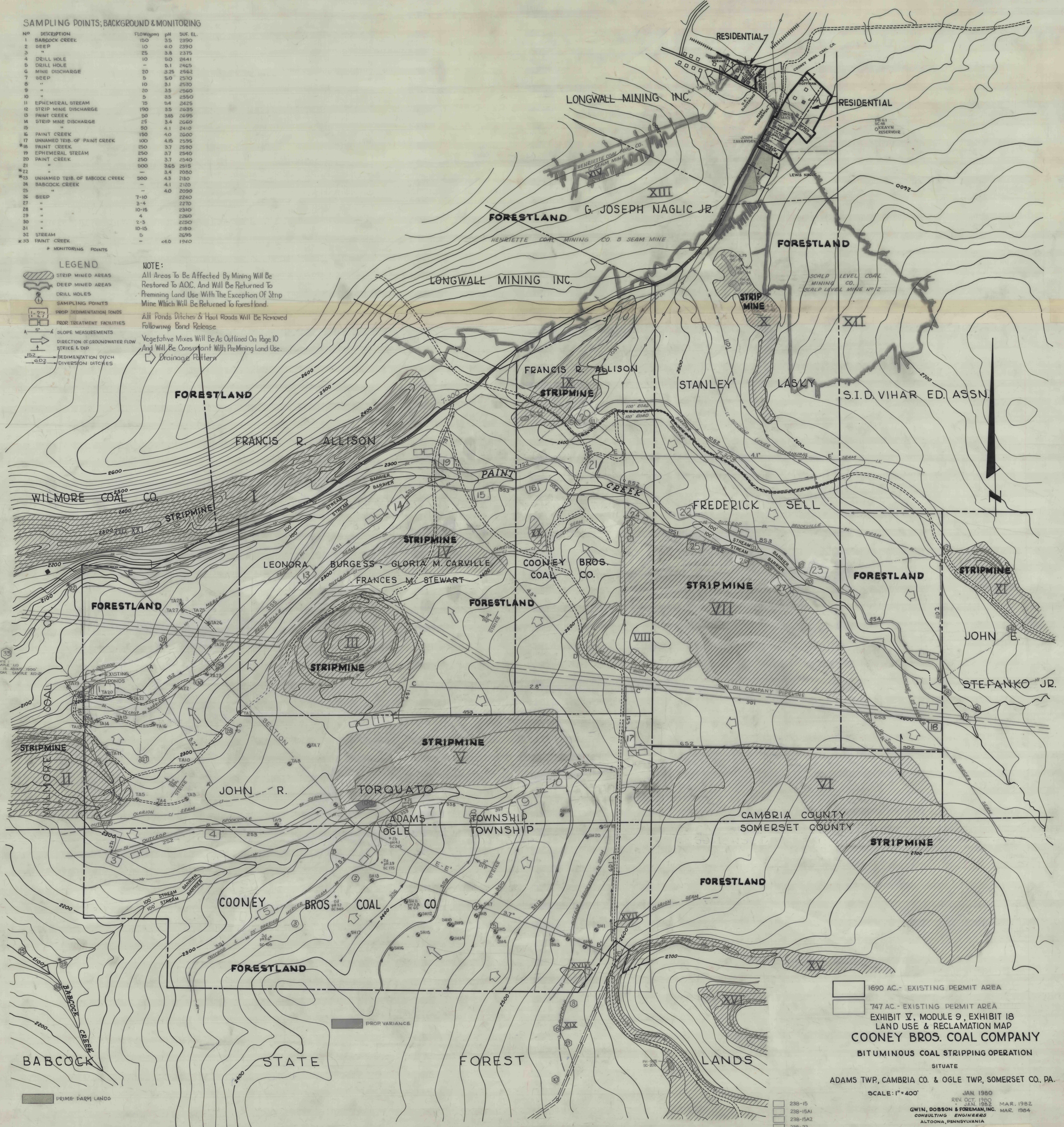

1690 AC. - EXISTING PERMIT AREA
 747 AC. - EXISTING PERMIT AREA
 EXHIBIT V, MODULE 9, EXHIBIT 18
LAND USE & RECLAMATION MAP
COONEY BROS. COAL COMPANY
 BITUMINOUS COAL STRIPPING OPERATION
 SITUATE
 ADAMS TWP, CAMBRIA CO. & OGLE TWP, SOMERSET CO., PA.
 SCALE: 1" = 400'

JAN. 1980
 REV. OCT. 1980
 JAN. 1982
 MAR. 1984
GWIN, DOBSON & FOREMAN, INC.
 CONSULTING ENGINEERS
 ALTOONA, PENNSYLVANIA