

GENERAL MAP of the MC FADDEN COAL LANDS

IN
Black Lick and Jackson Townships

Cambria County, Penna.

Surveyed by C. R. Claghorn

Scale: $\frac{1}{2}$ 800ft = 1inch

To accompany report
E. V. D'INVILLIERS
August 1892 Geologist and Mining Engineer

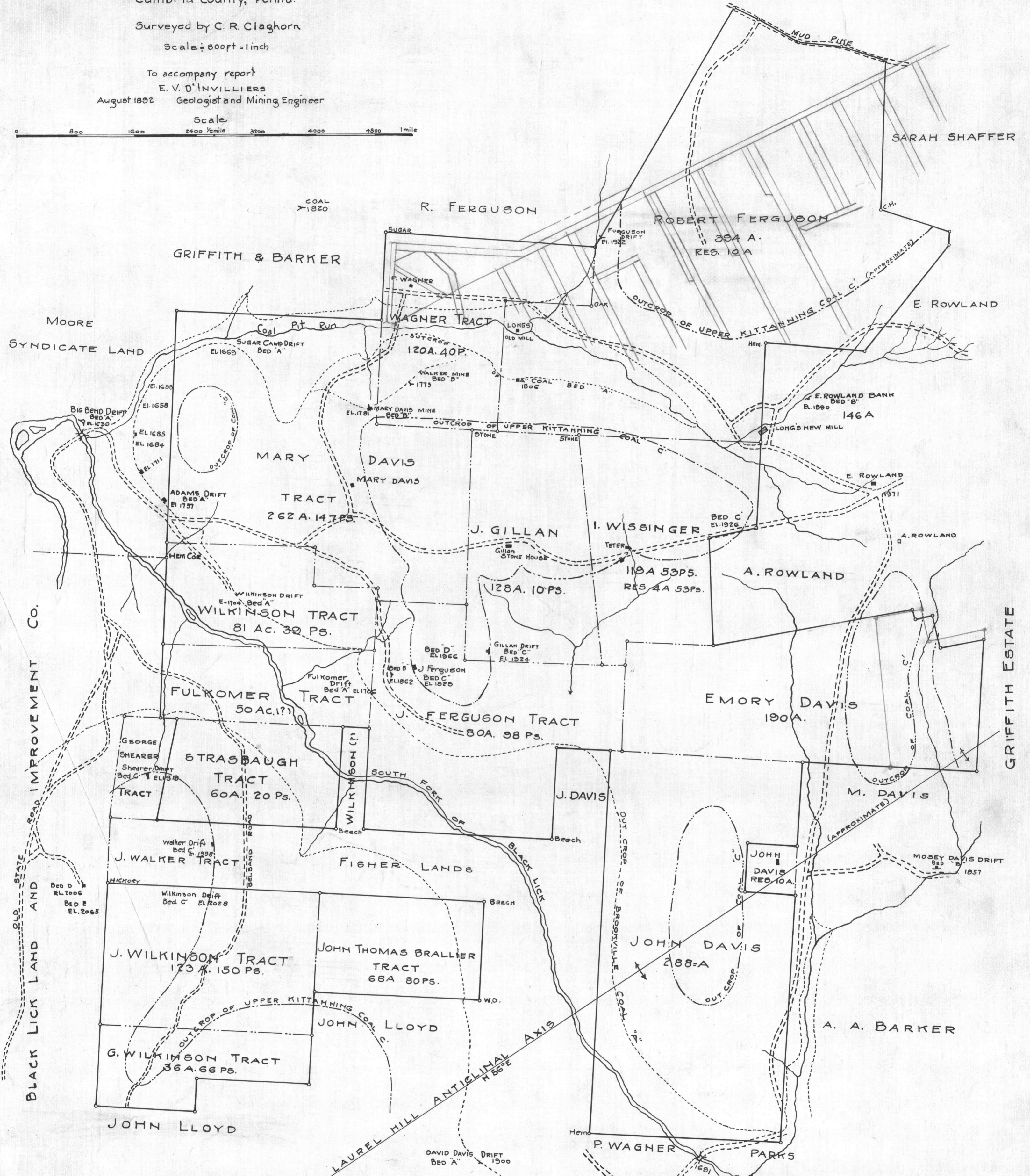

LEGEND

AREA OF BROOKVILLE COAL BED "B"	
" " " " UPPER KITTANNING "C"	
PROPERTY OWNED IN FEE SIMPL	
" " " " " " MINERAL RIGHT	
COAL OPENINGS	
ROADS	