

WILMORE COAL CO.

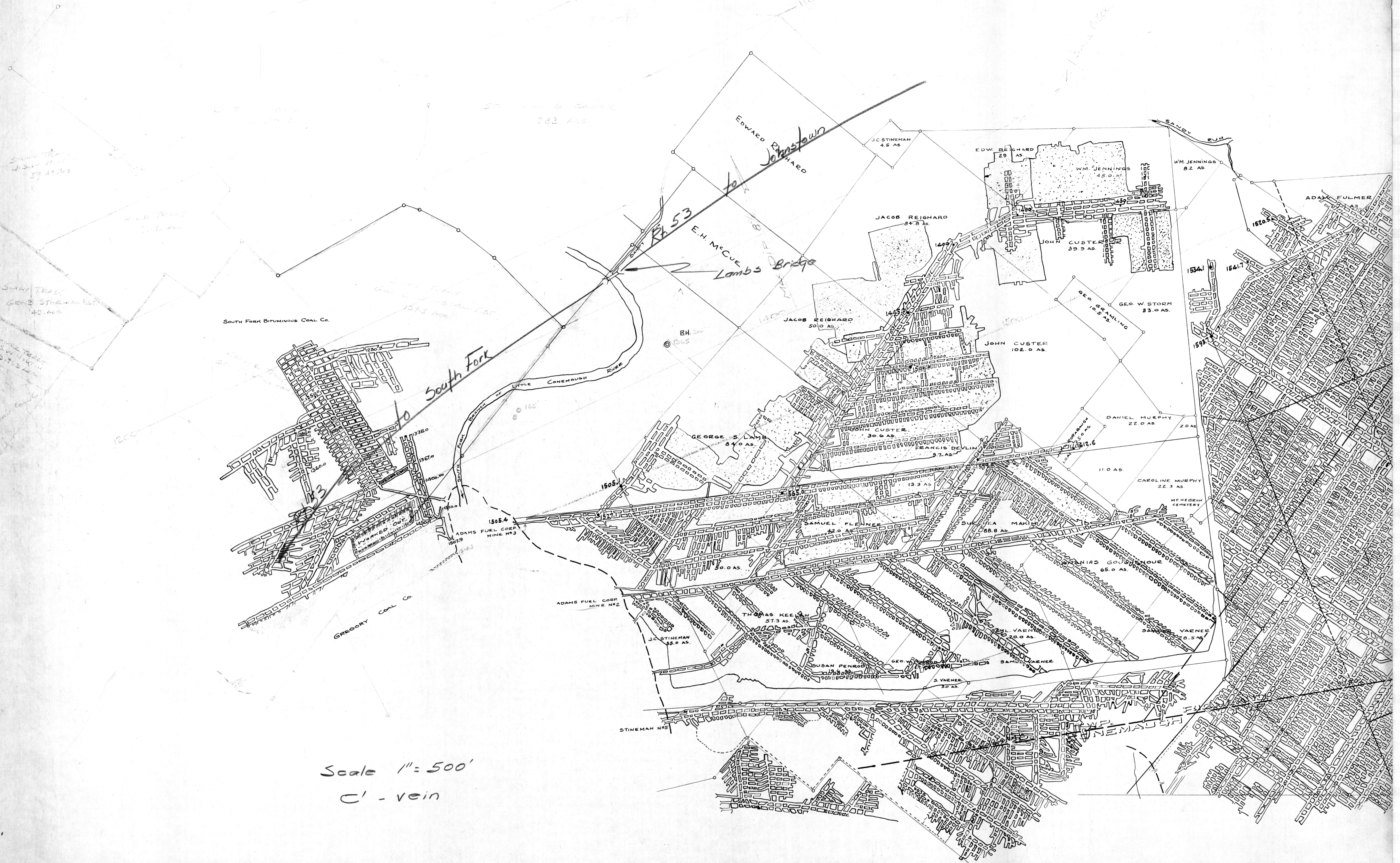

Small Tract
J. Stineman
49.49 AS

Small Tract
GEO. STINEMAN
40. AS

South Fork Bituminous Coal Co.

Scale 1" = 500'
C' - vein

to South Fork

Edward Reighard
Johnstons

E.H. McCue
Lamb's Bridge

JACOB REIGHARD
84.3 AS

EDW. REIGHARD
29 AS

WM JENNINGS
45.0 AS

WM JENNINGS
8.2 AS

ADAM FULMER

JACOB REIGHARD
50.0 AS

JOHN CUSTER
102.0 AS

GEO. W. STORM
33.0 AS

DANIEL MURPHY
22.0 AS

CAROLINE MURPHY
22.3 AS

GEORGE S. LAMB
84.0 AS

JOHN CUSTER
30.6 AS

FRANCIS DEVLIN
9.7 AS

ADAMS FUEL CORP.
MINE #3

ADAMS FUEL CORP.
MINE #2

GREGORY COAL CO.

J. STINEMAN
23.0 AS

THOMAS KEE
57.3 AS

SAMUEL FLENNER
32.0 AS

S. VARNER
32.0 AS

ANIAS GOLDBOURG
65.0 AS

VAENES
28.5 AS

J. STINEMAN
23.0 AS

S. VARNER
32.0 AS

SAMUEL FLENNER
32.0 AS

S. VARNER
32.0 AS

ANIAS GOLDBOURG
65.0 AS

VAENES
28.5 AS