

- WATER SOURCES**
- EVAN L. JONES --- None
 - BERTHA VINGLASS --- City
 - JOSEPH JANCOSKI --- None
 - BLAIR COUNTY --- None
 - JERRY WILLIAMSON --- None
 - CLARA BRADLEY --- None
 - GRACE ASHBURN --- None
 - BENNINGTON CEMETARY --- None
 - FRANCIS McTAVISH --- None
 - JAMES CONWAY --- City
 - RANDY LUKE --- None
 - DEPARTMENT OF THE INTERIOR (U.S.A.) --- None
 - MARY PILARZ --- City
 - ROBERT ERCLIANI --- City
 - FRANK SALPINO --- City
 - LEREY JONES --- City
 - BERNARD McINTOSH --- City
 - EDWARD NAGLE --- None
 - ALAN PITTSINGER --- Well
 - FRANK KRATZER --- Well
 - JOHN McTAVISH --- None
 - THOMAS MANDICHAK --- Well
 - JAMES MARUCA --- None

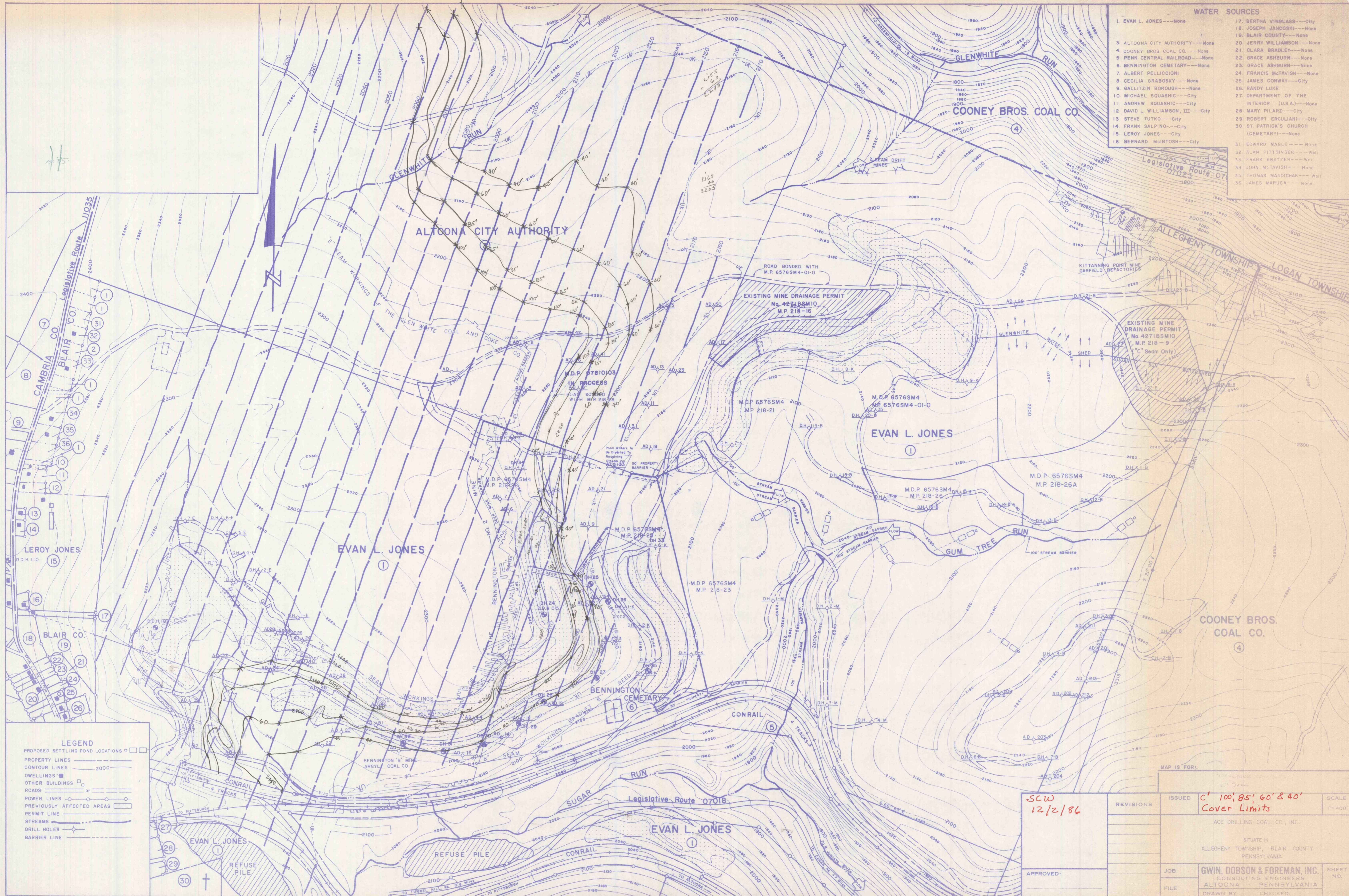

LEGEND

- PROPOSED SETTLING POND LOCATIONS □ □
- PROPERTY LINES ———
- CONTOUR LINES ——— 2000
- DWELLINGS ■
- OTHER BUILDINGS □
- ROADS ———
- POWER LINES ———
- PREVIOUSLY AFFECTED AREAS ———
- PERMIT LINE ———
- STREAMS ———
- DRILL HOLES ○
- BARRIER LINE ———

APPROVED:	SCW	ISSUED	C' 100', 85', 60' & 40'	SCALE
	12/2/86		Cover Limits	1" = 400'
		REVISIONS		
			ACE DRILLING COAL CO., INC.	
			SITUATE IN ALLEGHENY TOWNSHIP, BLAIR COUNTY, PENNSYLVANIA	
		JOB	GWIN, DOBSON & FOREMAN, INC.	SHEET NO.
		FILE	CONSULTING ENGINEERS ALTOONA, PENNSYLVANIA	
			DRAWN BY: CHECKED:	