

**WATER SOURCES**

- |                                     |  |
|-------------------------------------|--|
| 1. EVAN L. JONES---None             | 17. BERTHA VINGLASS---City                     |
| 3. ALTOONA CITY AUTHORITY---None    | 18. JOSEPH JANCOSKI---None                     |
| 4. COONEY BROS. COAL CO.---None     | 19. BLAIR COUNTY---None                        |
| 5. PENN CENTRAL RAILROAD---None     | 20. JERRY WILLIAMSON---None                    |
| 6. BENNINGTON CEMETARY---None       | 21. CLARA BRADLEY---None                       |
| 7. ALBERT PELLICIONI                | 22. GRACE ASHBURN---None                       |
| 8. CECILIA GRABOSKY---None          | 23. GRACE ASHBURN---None                       |
| 9. GALLITZIN BOROUGH---None         | 24. FRANCIS McTAVISH---None                    |
| 10. MICHAEL SQUASHIC---City         | 25. JAMES CONWAY---City                        |
| 11. ANDREW SQUASHIC---City          | 26. RANDY LUKE                                 |
| 12. DAVID L. WILLIAMSON, III---City | 27. DEPARTMENT OF THE INTERIOR (U.S.A.)---None |
| 13. STEVE TUTKO---City              | 28. MARY PILARZ---City                         |
| 14. FRANK SALPINO---City            | 29. ROBERT ERULIANI---City                     |
| 15. LEROY JONES---City              | 30. ST. PATRICK'S CHURCH (CEMETARY)---None     |
| 16. BERNARD McINTOSH---City         | 31. EDWARD NAGLE---None                        |
|                                     | 32. ALAN PITTSINGER---Well                     |
|                                     | 33. FRANK KRATZER---Well                       |
|                                     | 34. JOHN McTAVISH---None                       |
|                                     | 35. THOMAS MANDICHAK---Well                    |
|                                     | 36. JAMES MARUCA---None                        |

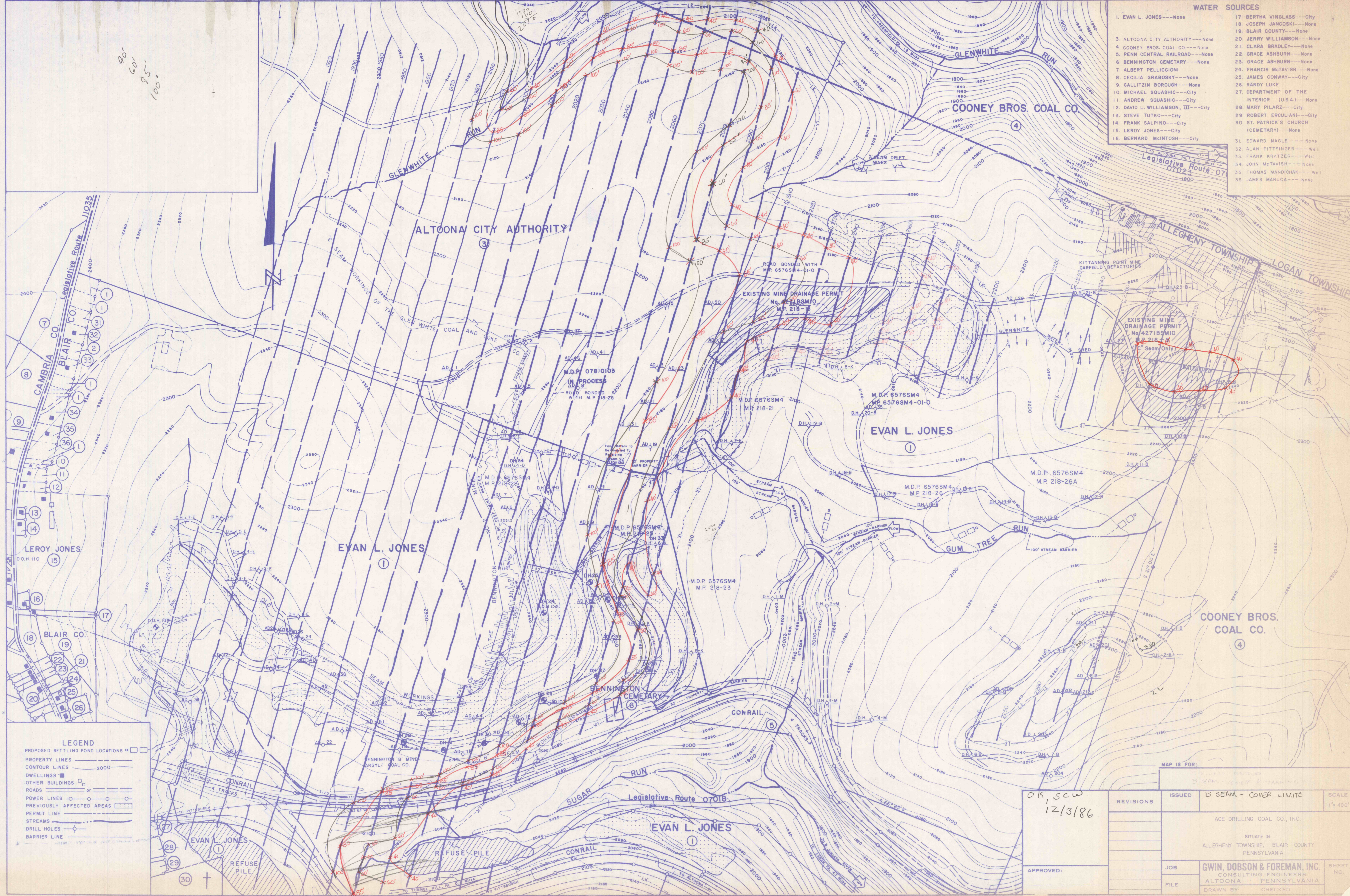

90'  
60'  
95'  
100'

**LEGEND**

- PROPOSED SETTLING POND LOCATIONS □
- PROPERTY LINES ———
- CONTOUR LINES ——— 2000
- DWELLINGS ■
- OTHER BUILDINGS □
- ROADS ——— or ———
- POWER LINES ———
- PREVIOUSLY AFFECTED AREAS [Hatched Box]
- PERMIT LINE ———
- STREAMS ———
- DRILL HOLES ○
- BARRIER LINE ———

OK, scw  
12/3/86

MAP IS FOR:		ISSUED	B SEAM - COVER LIMITS	SCALE
				1" = 400'
		ACE DRILLING COAL CO., INC.		
		SITUATE IN ALLEGHENY TOWNSHIP, BLAIR COUNTY, PENNSYLVANIA		
APPROVED:	JOB	GWIN, DOBSON & FOREMAN, INC.		
	FILE	CONSULTING ENGINEERS, ALTOONA, PENNSYLVANIA		
		DRAWN BY _____ CHECKED BY _____		
		SHEET NO. _____		