

WATER SOURCES

- | | |
|-------------------------------------|--|
| 1. EVAN L. JONES---None | 17. BERTHA VINGLASS---City |
| 2. ALTOONA CITY AUTHORITY---None | 18. JOSEPH JANCOSKI---None |
| 3. COONEY BROS. COAL CO.---None | 19. BLAIR COUNTY---None |
| 4. PENN CENTRAL RAILROAD---None | 20. JERRY WILLIAMSON---None |
| 5. BENNINGTON CEMETARY---None | 21. CLARA BRADLEY---None |
| 6. ALBERT PELLICIONI | 22. GRACE ASHBURN---None |
| 7. CECILIA GRABOSKY---None | 23. GRACE ASHBURN---None |
| 8. GALLITZIN BOROUGH---None | 24. FRANCIS McTAVISH---None |
| 9. MICHAEL SQUASHIC---City | 25. JAMES CONWAY---City |
| 10. ANDREW SQUASHIC---City | 26. RANDY LUKE |
| 11. DAVID L. WILLIAMSON, III---City | 27. DEPARTMENT OF THE INTERIOR (U.S.A.)---None |
| 12. STEVE TUTKO---City | 28. MARY PILARZ---City |
| 13. FRANK SALPINO---City | 29. ROBERT ERGULIANI---City |
| 14. LEROY JONES---City | 30. ST. PATRICK'S CHURCH (CEMETARY)---None |
| 15. BERNARD McINTOSH---City | 31. EDWARD NAGLE---None |
| | 32. ALAN PITTSINGER---Well |
| | 33. FRANK KRATZER---Well |
| | 34. JOHN McTAVISH---None |
| | 35. THOMAS MANDICHAK---Well |
| | 36. JAMES MARUCA---None |

*Steve, Add the contours
In between the ones
shown. That is 2010,
2030, 2040, 2070.
ETC.!*

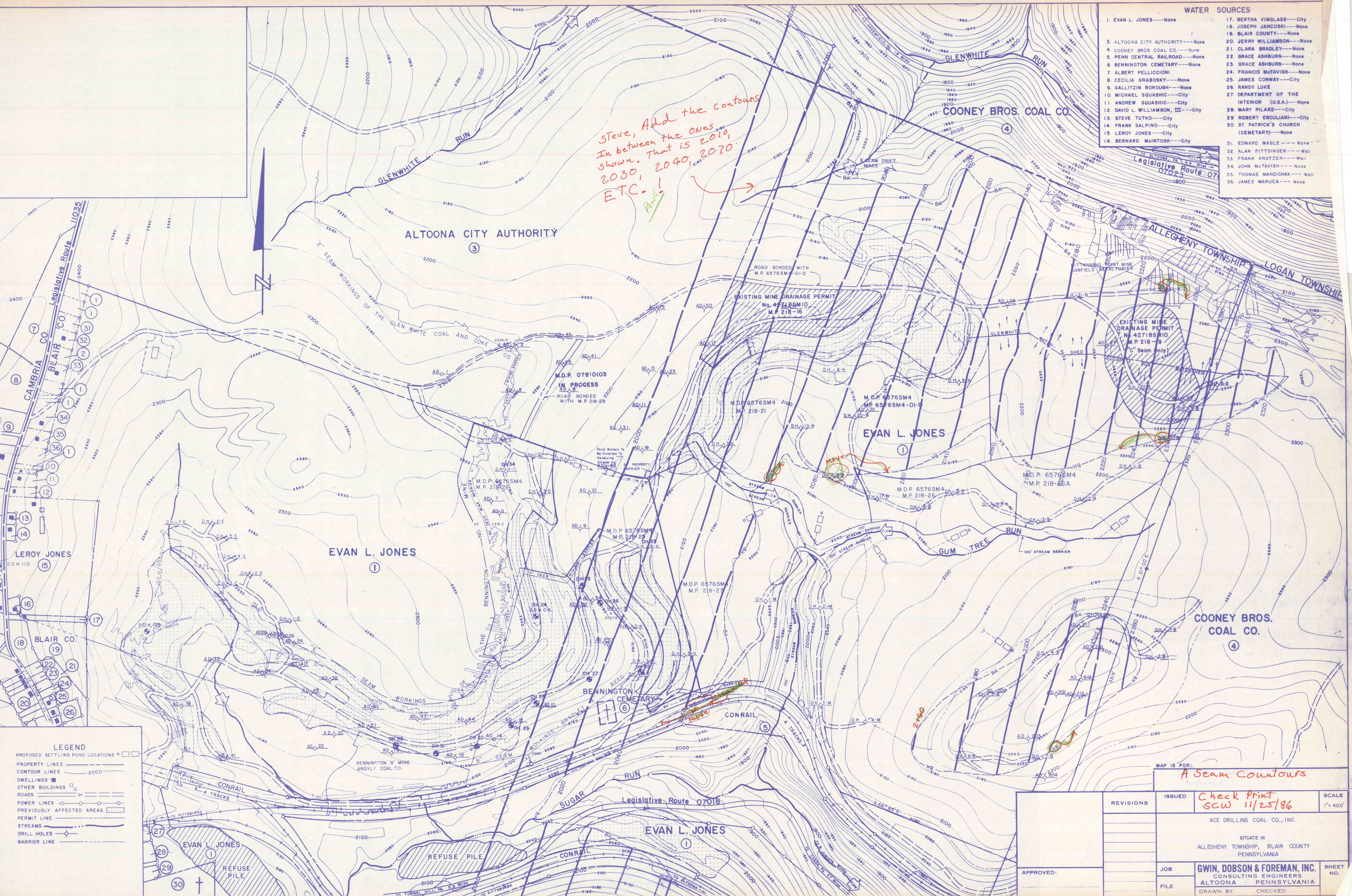

LEGEND

- PROPOSED SETTLING POND LOCATIONS □
- PROPERTY LINES ———
- CONTOUR LINES 2000 ———
- DWELLINGS ■
- OTHER BUILDINGS □
- ROADS ——— or ———
- POWER LINES ———
- PREVIOUSLY AFFECTED AREAS [Hatched Box]
- PERMIT LINE ———
- STREAMS ———
- DRILL HOLES ○
- BARRIER LINE - - - - -

MAP IS FOR:
A Seam Countours

REVISIONS	ISSUED	SCALE
	Check Print SCW 11/25/86	1" = 400'
ACE DRILLING COAL CO., INC.		
SITUATE IN ALLEGHENY TOWNSHIP, BLAIR COUNTY PENNSYLVANIA		
JOB	FILE	SHEET NO.
GWIN, DOBSON & FOREMAN, INC. CONSULTING ENGINEERS ALTOONA - PENNSYLVANIA		
DRAWN BY: CHECKED:		

APPROVED: