

Structural
M.H.
Cover (MH)

WATER SOURCES

- | | |
|---------------------------------------|--|
| 1. EVAN L. JONES --- None | 17. BERTHA VINGLASS --- City |
| 2. ALTOONA CITY AUTHORITY --- None | 18. JOSEPH JANCOSKI --- None |
| 3. ALTOONA CITY AUTHORITY --- None | 19. BLAIR COUNTY --- None |
| 4. COONEY BROS. COAL CO. --- None | 20. JERRY WILLIAMSON --- None |
| 5. PENN. CENTRAL RAILROAD --- None | 21. CLARA BRADLEY --- None |
| 6. BENNINGTON CEMETARY --- None | 22. GRACE ASHBURN --- None |
| 7. ALBERT PELLICIONI --- None | 23. GRACE ASHBURN --- None |
| 8. CECILIA GRABOSKY --- None | 24. FRANCIS McTAVISH --- None |
| 9. GALLITZIN BOROUGH --- None | 25. JAMES CONWAY --- City |
| 10. MICHAEL SQUASHIC --- City | 26. RANDY LUKE |
| 11. ANDREW SQUASHIC --- City | 27. DEPARTMENT OF THE INTERIOR (U.S.A.) --- None |
| 12. DAVID L. WILLIAMSON, III --- City | 28. MARY PILARZ --- City |
| 13. STEVE TUTKO --- City | 29. ROBERT ERCULIANI --- City |
| 14. FRANK SALPINO --- City | 30. ST. PATRICK'S CHURCH (CEMETARY) --- None |
| 15. LEROY JONES --- City | 31. EDWARD NAGLE --- None |
| 16. BERNARD McINTOSH --- City | 32. ALAN PITTSINGER --- Well |
| | 33. FRANK KRATZER --- Well |
| | 34. JOHN McTAVISH --- None |
| | 35. THOMAS MANDICHAK --- Well |
| | 36. JAMES MARUCA --- None |

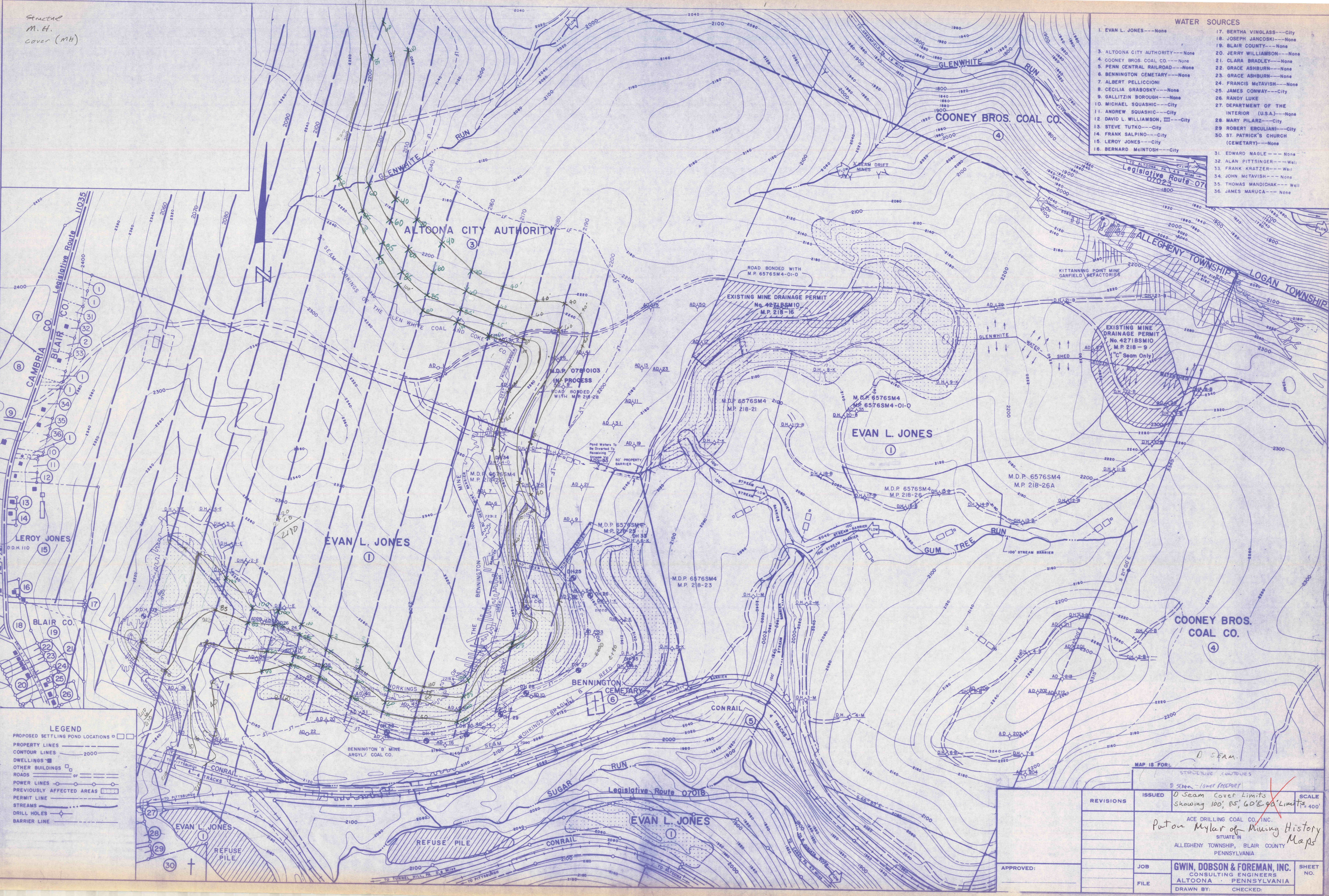

LEGEND

- PROPOSED SETTLING POND LOCATIONS □ □
- PROPERTY LINES ———
- CONTOUR LINES ——— 2000
- DWELLINGS ■
- OTHER BUILDINGS □
- ROADS ——— or ———
- POWER LINES ———
- PREVIOUSLY AFFECTED AREAS □ □ □ □
- PERMIT LINE ———
- STREAMS ———
- DRILL HOLES ○
- BARRIER LINE ———

MAP IS FOR: *D SEAM*

ISSUED	STRUCTURE CONTOURS	SCALE
REVISED	<i>D SEAM - LOWER FREEPORT</i>	1" SEAM COVER LIMITS
	Showing 100', 85', 60' & 40' Limits	400'
ACE DRILLING COAL CO., INC. <i>Put on Mylar of Mining History Maps</i> SITUATE IN ALLEGHENY TOWNSHIP, BLAIR COUNTY PENNSYLVANIA		
JOB	GWIN, DOBSON & FOREMAN, INC.	SHEET NO.
FILE	CONSULTING ENGINEERS ALTOONA - PENNSYLVANIA	
	DRAWN BY: _____ CHECKED: _____	

APPROVED: _____