

WATER SOURCES

1. EVAN L. JONES	None	17. BERTHA VINGLASS	City
2. ALTOONA CITY AUTHORITY	None	18. JOSEPH JANCOSKI	None
3. COONEY BROS. COAL CO.	None	19. BLAIR COUNTY	None
4. PENN CENTRAL RAILROAD	None	20. JERRY WILLIAMSON	None
5. BENNINGTON CEMETARY	None	21. CLARA BRADLEY	None
6. ALBERT PELLICIONI	None	22. GRACE ASHBURN	None
7. CECILIA GRABOSKY	None	23. GRACE ASHBURN	None
8. GALLITZIN BOROUGH	None	24. FRANCIS McTAVISH	None
9. MICHAEL SQUASHIC	City	25. JAMES CONWAY	City
10. ANDREW SQUASHIC	City	26. RANDY LUKE	None
11. DAVID L. WILLIAMSON, III	City	27. DEPARTMENT OF THE INTERIOR (U.S.A.)	None
12. STEVE TUTKO	City	28. MARY PILARZ	City
13. FRANK SALPINO	City	29. ROBERT ERGULIANI	City
14. LEROY JONES	City	30. ST. PATRICK'S CHURCH (CEMETARY)	None
15. BERNARD MCINTOSH	City	31. EDWARD NAGLE	None
		32. ALAN PITTSINGER	Well
		33. FRANK KRATZER	Well
		34. JOHN McTAVISH	None
		35. THOMAS MANDICHAK	Well
		36. JAMES MARUCA	None

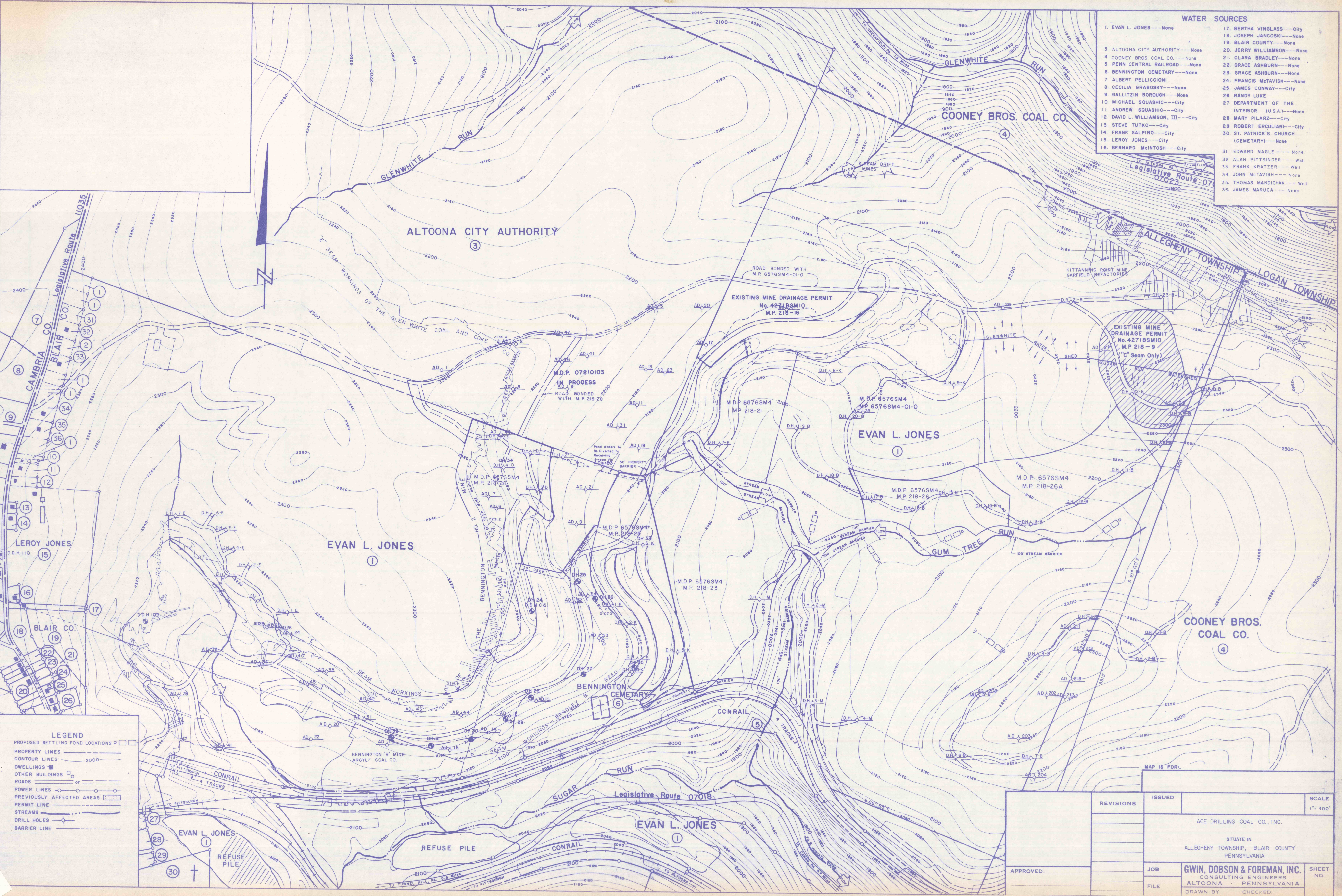

LEGEND

- PROPOSED SETTLING POND LOCATIONS □
- PROPERTY LINES —
- CONTOUR LINES — 2000
- DWELLINGS ■
- OTHER BUILDINGS □
- ROADS — or —
- POWER LINES —
- PREVIOUSLY AFFECTED AREAS [hatched]
- PERMIT LINE —
- STREAMS —
- DRILL HOLES ○
- BARRIER LINE - - -

MAP IS FOR:

REVISIONS	ISSUED	SCALE
		1" = 400'
ACE DRILLING COAL CO., INC.		
SITUATE IN ALLEGHENY TOWNSHIP, BLAIR COUNTY PENNSYLVANIA		
APPROVED:	JOB	GWIN, DOBSON & FOREMAN, INC. CONSULTING ENGINEERS ALTOONA, PENNSYLVANIA
	FILE	
		SHEET NO.
		DRAWN BY: CHECKED: