

- WATER SOURCES**
- 1. EVAN L. JONES---None
 - 2. ALTOONA CITY AUTHORITY---None
 - 3. ALTOONA CITY AUTHORITY---None
 - 4. COONEY BROS COAL CO.---None
 - 5. PENN CENTRAL RAILROAD---None
 - 6. BENNY TON CEMENTARY---None
 - 7. BENNY TON CEMENTARY---None
 - 8. CECILIA GRADSKY---None
 - 9. SALLIZIN BOROUSH---None
 - 10. MICHAEL SQUASHIC---City
 - 11. ANDREW SQUASHIC---City
 - 12. DAVID L. WILLIAMSON, III---City
 - 13. STEVE TUTKO---City
 - 14. LEROY JONES---City
 - 15. LEROY JONES---City
 - 16. BERNARD MCINTOSH---City
 - 17. BERTHA VINILAS---City
 - 18. BLAIR COUNTY---None
 - 19. JERRY WILLIAMSON---None
 - 20. JERRY WILLIAMSON---None
 - 21. CLARA BRADLEY---None
 - 22. GRACE ASHURN---None
 - 23. GRACE ASHURN---None
 - 24. FRANCIS McAVISH---None
 - 25. FRANCIS McAVISH---None
 - 26. RANDY LUCK---None
 - 27. DEPARTMENT OF THE INTERIOR (U.S.A.)---None
 - 28. MARY PILAREZ---City
 - 29. ROBERT ERGOLIANT---City
 - 30. ST PATRICK'S CHURCH (CEMETARY)---None
 - 31. EDWARD NABLE---None
 - 32. ALAN FITZINGER---Well
 - 33. JOHN FITZINGER---Well
 - 34. JOHN FITZINGER---Well
 - 35. THOMAS MANDICHAK---None
 - 36. JAMES MARUCA---None

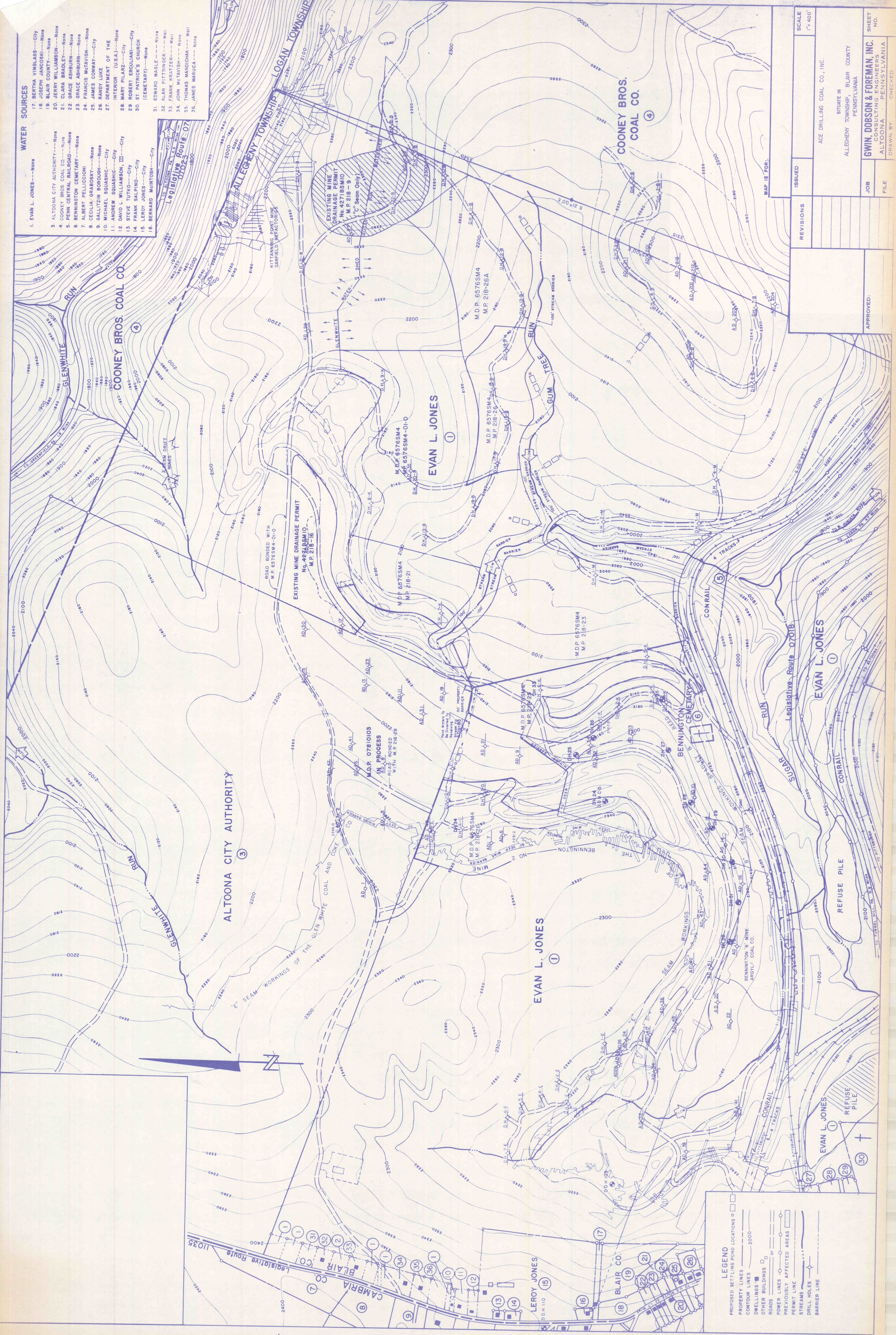

ISSUED	REVISIONS	SCALE
		1" = 400'
STATE IN ALLEGHENY TOWNSHIP, BLAIR COUNTY, PENNSYLVANIA ACE DRILLING COAL CO., INC. GWIN, DOBSON & FOREMAN, INC. CONSULTING ENGINEERS ALTOONA, PENNSYLVANIA		
JOB	FILE	SHEET NO.

APPROVED:

LEGEND

- PROPOSED BETTLING POND LOCATIONS
- PROPERTY LINES
- TOWNSHIP LINES
- OTHER BUILDINGS
- ROADS
- POWER LINES
- PREVIOUSLY AFFECTED AREAS
- PERMIT LINE
- STREAMS
- DRAINAGE HOLES
- BARRIER LINE