

2000 10 20 30 40 50 60 70 80 90 100 110 120 130 140 150 160 170 180 190 200 210 220 230 240 250

COLOR	PERMIT	ACREAGE AFFECTED	RESTORED/DELETED	PLANTED	PERMIT REMAINING	Ac. UNDER BOND	BONDS

- TOTAL PERMIT
- STRIPPED
- TO BE AFFECTED
- COMPLETION
- TOPSOIL
- DELETION
- TO BE MINED
- UPPER FREEPORT
- LOWER FREEPORT
- LOWER KITTANNING
- BROOKVILLE
- MERCER
- BROOKVILLE & MERCER
- BROOKVILLE & LOWER KITTANNING
- INCIDENTAL ACREAGE

WATER SOURCES

1. EVAN L. JONES---None	17. BERTHA VINGLASS---City
2. ALTOONA CITY AUTHORITY---None	18. JOSEPH JANCOSKI---None
3. ALTOONA CITY AUTHORITY---None	19. BLAIR COUNTY---None
4. COONEY BROS COAL CO---None	20. JERRY WILLIAMSON---None
5. PENN CENTRAL RAILROAD---None	21. CLARA BRADLEY---None
6. BENNINGTON CEMETARY---None	22. GRACE ASHBURN---None
7. ALBERT PELLICIONI	23. GRACE ASHBURN---None
8. CECILIA GRABOSKY---None	24. FRANCIS McTAVISH---None
9. GALLITZIN BOROUGH---None	25. JAMES CONWAY---City
10. MICHAEL SQUASHIC---City	26. RANDY LUKE
11. ANDREW SQUASHIC---City	27. DEPARTMENT OF THE INTERIOR (U.S.A.)---None
12. DAVID L. WILLIAMSON, III---City	28. MARY PILARZ---City
13. STEVE TUTKO---City	29. ROBERT ERCULIANI---City
14. FRANK SALPINO---City	30. ST. PATRICK'S CHURCH (CEMATERY)---None
15. LEROY JONES---City	31. EDWARD NABLE---None
16. BERNARD MCINTOSH---City	32. ALAN PITTSINGER---Well
	33. FRANK KRATZER---Well
	34. JOHN McTAVISH---None
	35. THOMAS MANDICHAK---Well
	36. JAMES MARUCA---None

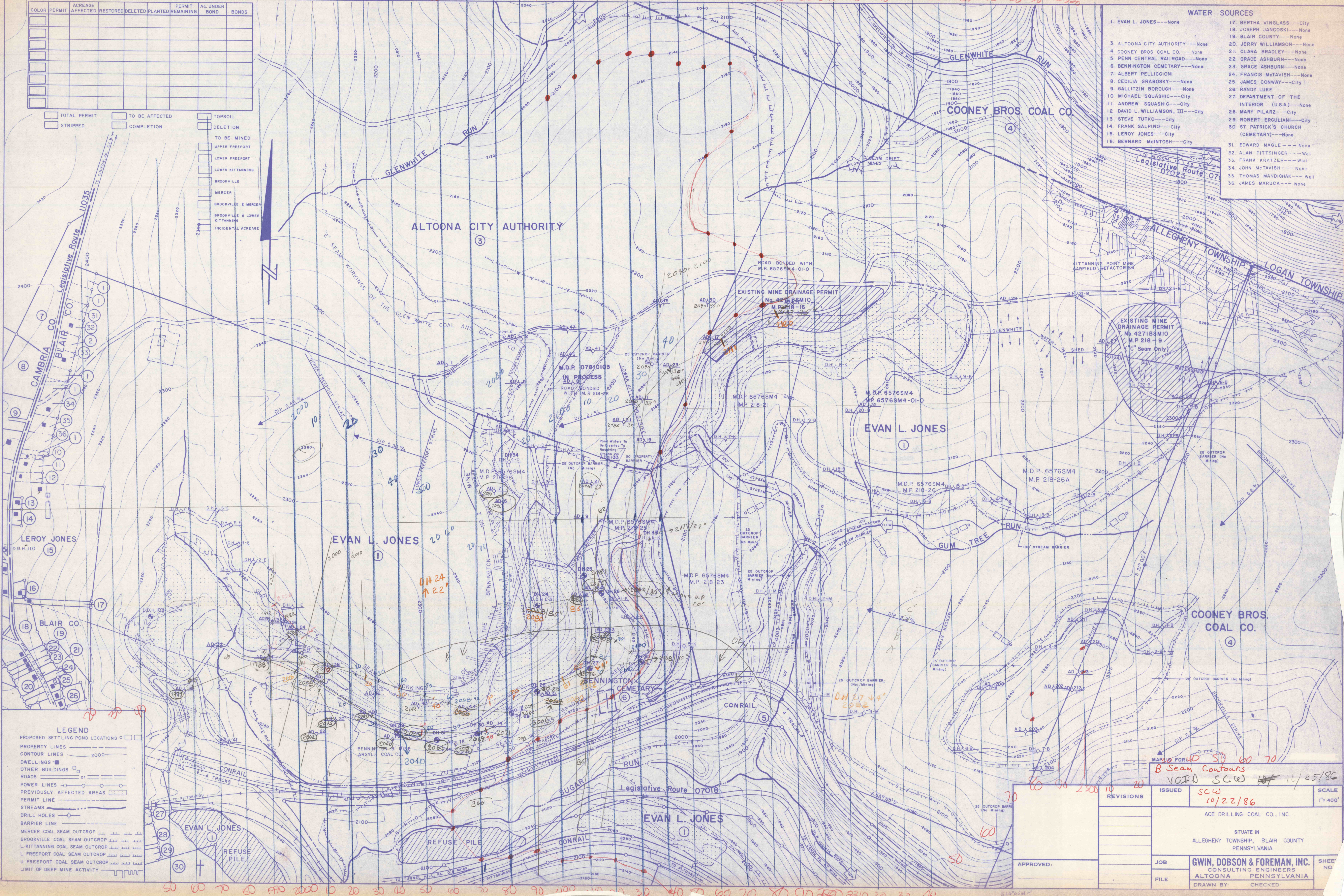

LEGEND

- PROPOSED SETTLING POND LOCATIONS
- PROPERTY LINES
- CONTOUR LINES 2000
- DWELLINGS
- OTHER BUILDINGS
- ROADS
- POWER LINES
- PREVIOUSLY AFFECTED AREAS
- PERMIT LINE
- STREAMS
- DRILL HOLES
- BARRIER LINE
- MERCER COAL SEAM OUTCROP
- BROOKVILLE COAL SEAM OUTCROP
- L. KITTANNING COAL SEAM OUTCROP
- F. FREEPORT COAL SEAM OUTCROP
- U. FREEPORT COAL SEAM OUTCROP
- LIMIT OF DEEP MINE ACTIVITY

MAPS FOR 50 50 60 70

B Seam Contours

VOFA SCW 11/25/86

REVISIONS	ISSUED	SCALE
	SCW	1"=400'
	10/22/86	

ACE DRILLING COAL CO., INC.

SITUATE IN ALLEGHENY TOWNSHIP, BLAIR COUNTY, PENNSYLVANIA

GWIN, DOBSON & FOREMAN, INC.
CONSULTING ENGINEERS
ALTOONA, PENNSYLVANIA

DRAWN BY: _____ CHECKED: _____

50 60 70 80 90 100 110 120 130 140 150 160 170 180 190 200 210 220 230 240 250