

WATER SOURCES

- | | |
|-------------------------------------|--|
| 1. EVAN L. JONES---None | 17. BERTHA VINGLASS---City |
| 3. ALTOONA CITY AUTHORITY---None | 18. JOSEPH JANCOSKI---None |
| 4. COONEY BROS. COAL CO.---None | 19. BLAIR COUNTY---None |
| 5. PENN CENTRAL RAILROAD---None | 20. JERRY WILLIAMSON---None |
| 6. BENNINGTON CEMETARY---None | 21. CLARA BRADLEY---None |
| 7. ALBERT PELLICIONI | 22. GRACE ASHBURN---None |
| 8. CECILIA GRABOSKY---None | 23. GRACE ASHBURN---None |
| 9. GALLITZIN BOROUGH---None | 24. FRANCIS McTAVISH---None |
| 10. MICHAEL SQUASHIC---City | 25. JAMES CONWAY---City |
| 11. ANDREW SQUASHIC---City | 26. RANDY LUKE |
| 12. DAVID L. WILLIAMSON, III---City | 27. DEPARTMENT OF THE INTERIOR (U.S.A.)---None |
| 13. STEVE TUTKO---City | 28. MARY PILARZ---City |
| 14. FRANK SALPINO---City | 29. ROBERT ERGULIANI---City |
| 15. LEROY JONES---City | 30. ST. PATRICK'S CHURCH (CEMETARY)---None |
| 16. BERNARD McINTOSH---City | 31. EDWARD NAGLE---None |
| | 32. ALAN PITTSINGER---Well |
| | 33. FRANK KRATZER---Well |
| | 34. JOHN McTAVISH---None |
| | 35. THOMAS MANDICHAK---Well |
| | 36. JAMES MARUCA---None |

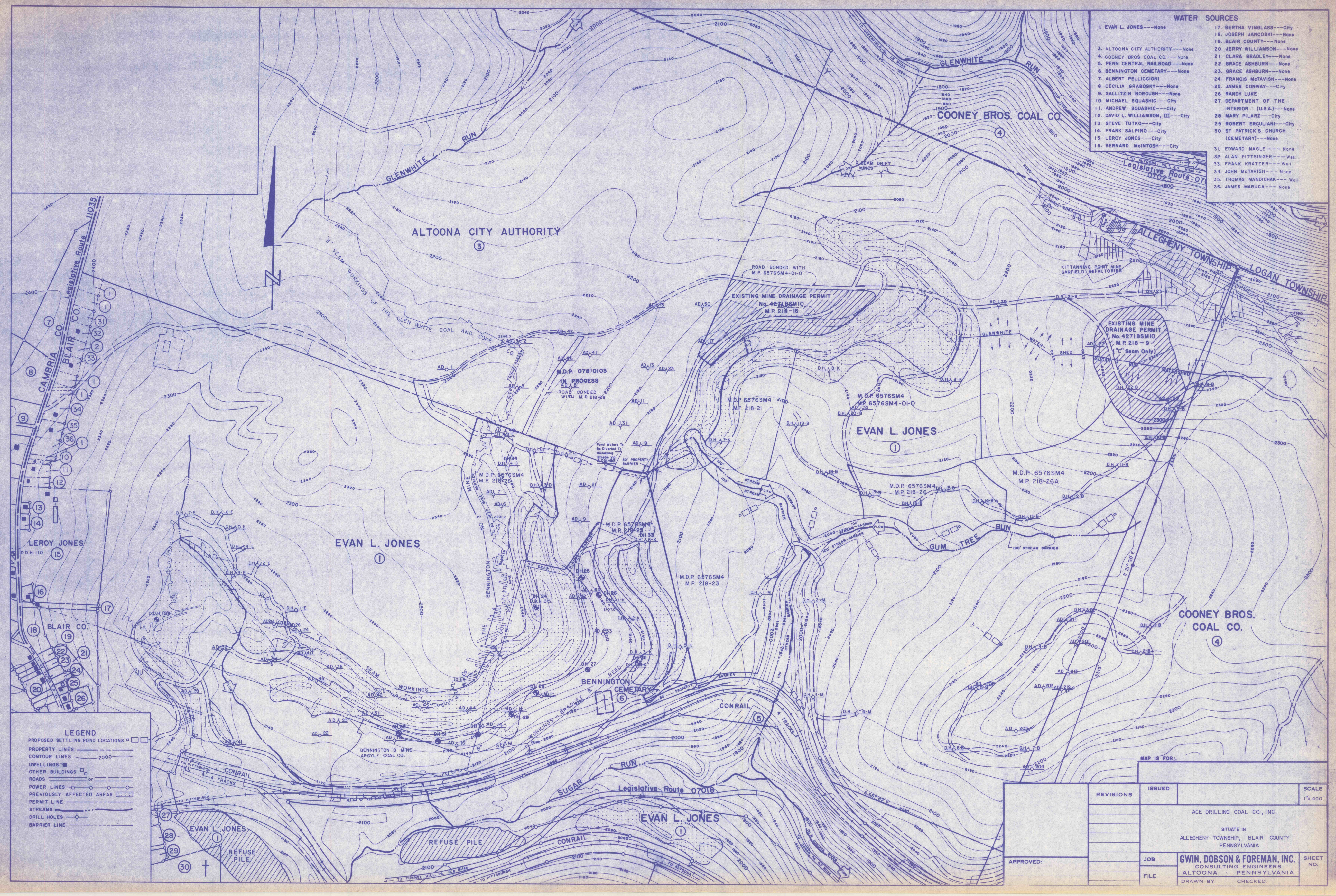

LEGEND

- PROPOSED SETTLING POND LOCATIONS □
- PROPERTY LINES ———
- CONTOUR LINES 2000
- DWELLINGS ■
- OTHER BUILDINGS □
- ROADS ———
- POWER LINES ———
- PREVIOUSLY AFFECTED AREAS [Hatched]
- PERMIT LINE ———
- STREAMS ———
- DRILL HOLES ○
- BARRIER LINE ———

REVISIONS	ISSUED	SCALE
		1" = 400'
ACE DRILLING COAL CO., INC.		
SITUATE IN ALLEGHENY TOWNSHIP, BLAIR COUNTY, PENNSYLVANIA		
JOB	GWIN, DOBSON & FOREMAN, INC. CONSULTING ENGINEERS ALTOONA, PENNSYLVANIA	
FILE	DRAWN BY: _____ CHECKED: _____	

APPROVED: _____

- 1
- 2
- 3
- 4
- 5
- 6
- 7
- 8
- 9
- 10
- 11
- 12
- 13
- 14
- 15
- 16
- 17
- 18
- 19
- 20
- 21
- 22
- 23
- 24
- 25
- 26
- 27
- 28
- 29
- 30