

MAP OF PROPERTY OF THE TAYLOR & McCOY COAL & COKE CO.

GALLITZIN TOWNSHIP, CAMBRIA CO., PA.

SCALE: 1" = 400'

W.A. SILLIMAN
MINING ENGINEER.

ALTOONA, PA.

'E' SEAM MINE WORKINGS SHOWN TO DATE OF FEB. 10, 1936. - REVISED TO JAN. 20, 1938

- ALL MINERAL AND SURFACE OWNED IN FEE — — RED
- ALL MINERAL OWNED IN FEE - SURFACE NOT OWNED — — PURPLE
- ALL MINERAL EXCEPT 'B' SEAM OWNED IN FEE - SURFACE OWNED — — WHITE
- ALL MINERAL EXCEPT 'B' SEAM OWNED IN FEE - SURFACE NOT OWNED — — GREEN
- 'B' SEAM OWNED IN FEE, 'E' SEAM LEASED — — YELLOW
- 'E' SEAM ONLY LEASED — — BROWN

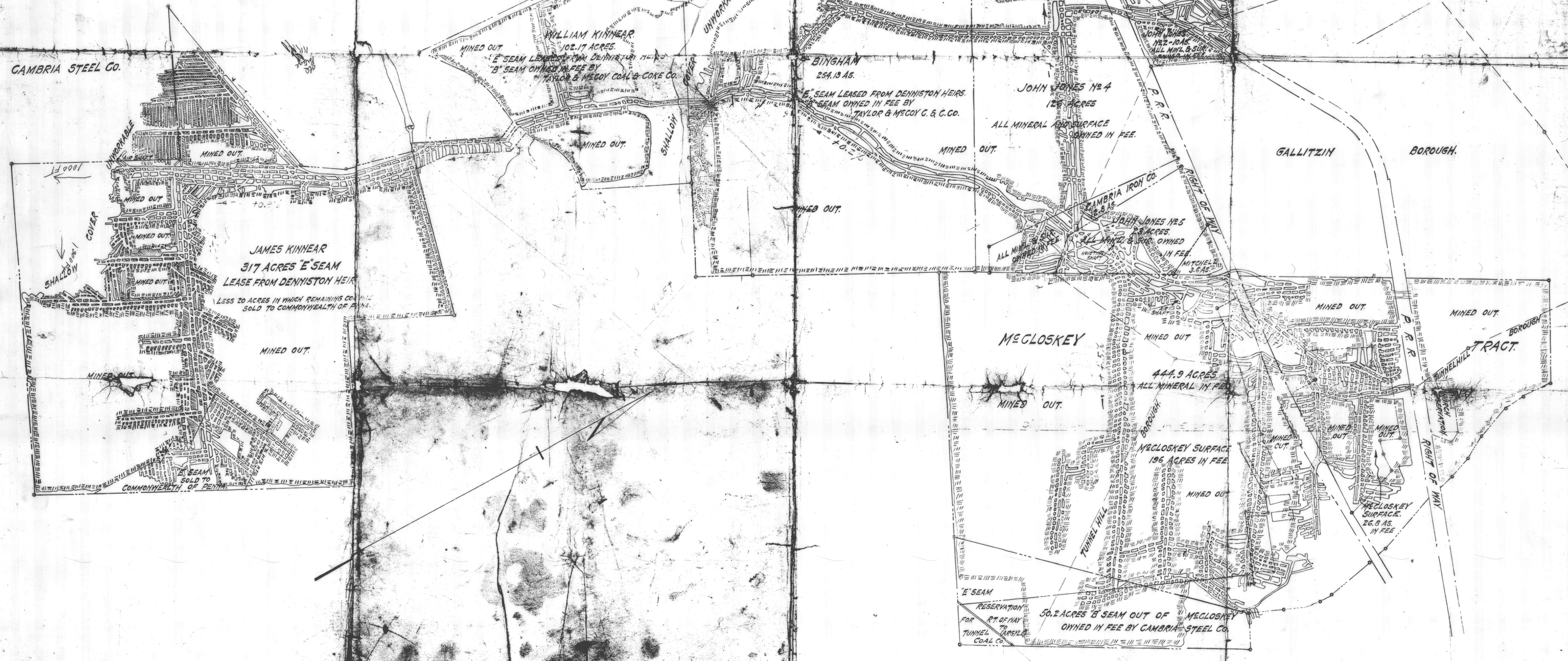

SURFACE LAND SOLD BY
RECEIVERS OF TAYLOR & McCOY C. & C. CO.
TO ALBERTO PELLICCHI
SCALE: 1" = 400'
JULY 1938
SILLIMAN & WESTLEY
ENGRS.

25 FT FROM BIRTH
FANWAY LEAST DEPENDS TOP GRADE