

LEASEHOLDS AND OWNERSHIPS
OF THE
SONMAN SHAFT COAL CO.
IN THE
E OR UPPER FREEPORT SEAM.
PORTAGE AND SUMMERHILL TOWNSHIPS, CAMBRIA COUNTY, PA.
SCALE 1"=400'
WORKINGS SHOWN TO 1/2" LEVEL

W.A. SULLIVAN
ENGINEER
ALTOONA, PA.

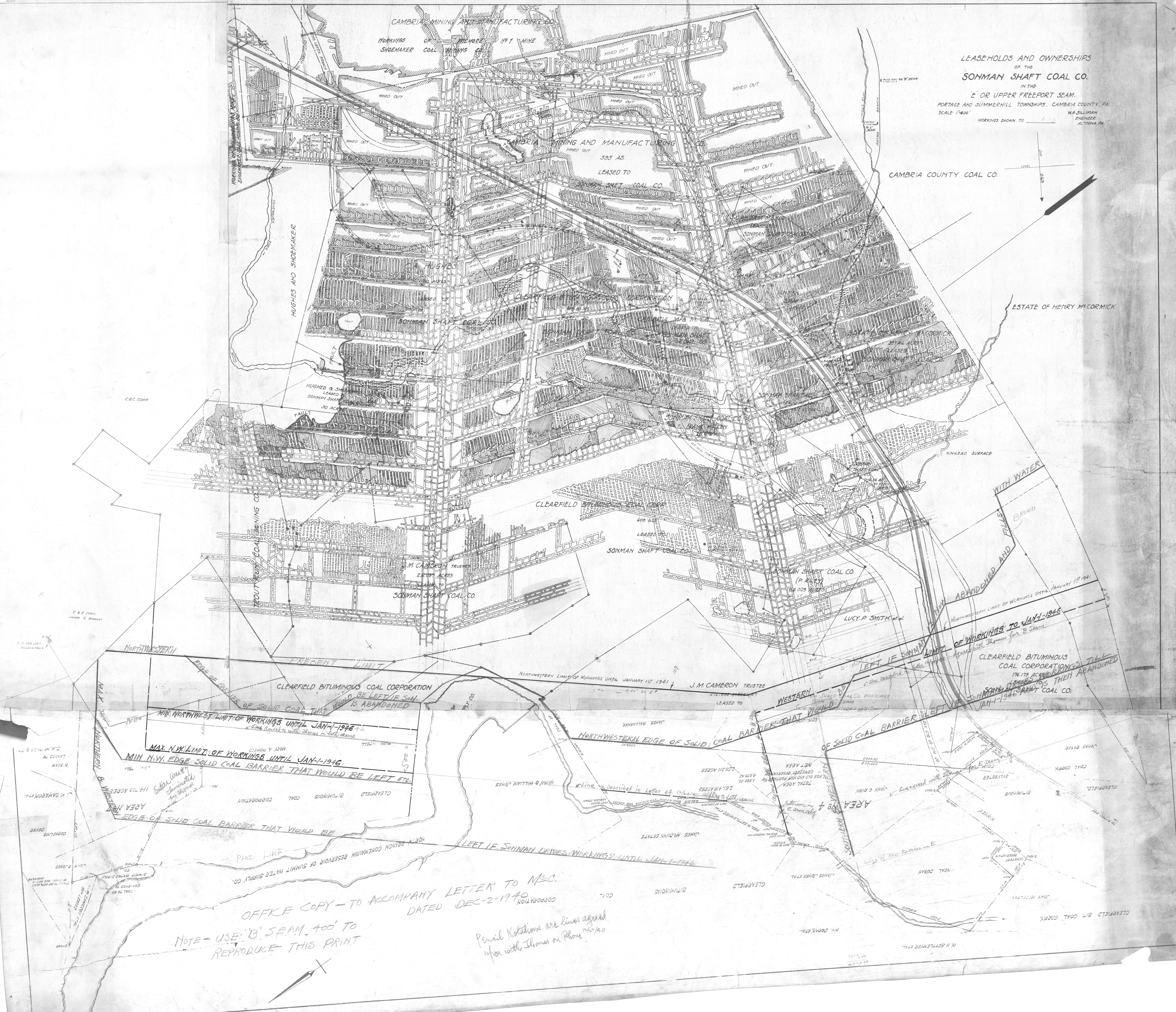

OFFICE COPY - TO ACCOMPANY LETTER TO M.C.C.
DATED DEC-2-1940

NOTE - USE 'B' SEAM 400' TO REPRODUCE THIS PRINT

Pencil Notations are lines agreed upon with Thomas on phone 12-14-40

