

PUBLIC & PRIVATE WATER SUPPLIES

NO.	NAME	SOURCE	FLOW(gpm)	pH	S.C.	ELEV.
10	H. SEMELBERGER	SPRING	0-10	6.5	95	1900
11	H. SEMELBERGER	WELL	NO OVERFLOW	7.0	420	1900
12	H. RAMSEY HOUSE & TRAILER ON ORCHARDVALE FARMS SERVED BY SPRING LOCATED APPROXIMATELY 1700' TO THE SOUTH.					

NOTE: ALL OTHER HOUSES WITHIN 1000' OF PROPOSED PERMIT AREA SERVED BY PUBLIC WATER FROM PATTON BOROUGH WATER AUTHORITY.

COMPLETED AREAS: NOV. 1984

	STAGE I	STAGE I & II	STAGE III DELETED	TOTAL
MINING 0'-85'	26.3	9.7	14.5	50.5
SUPPORT	4.2	2.2	13.2	19.6
TOTAL	30.5	11.9	28.7	70.1

12.0 AC. - MINING 0'-85' H/W @ \$3,000/AC.
 4.5 AC. - SUPPORT @ \$1,000/AC.

No 1	PROPERTY OWNERS				TOTAL
	HUGH H. SEMELBERGER	HUGH H. SEMELBERGER & RICHARD C. MURRAY	THEODORE P. DEPTO	FIREMENS ASSOC. OF CAMBRIA CO.	
MINING AREA	2.9	7.8	1.8	-	12.5
SUPPORT AREA	1.7	3.1	1.6	2.6	9.0
TOTAL	4.6	10.9	3.4	2.6	21.5

No 2	PROPERTY OWNERS				TOTAL
	HUGH H. SEMELBERGER & RICHARD C. MURRAY	LEONA & HERMAN Mc NULTY	LEO J. KARLHEIM	FIREMENS ASSOC. OF CAMBRIA CO.	
MINING AREA	23.5	-	-	2.5	26.0
SUPPORT AREA	5.1	-	-	1.0	6.1
TOTAL	28.6	-	-	3.5	32.1

MINING PERMIT/BONDING STATUS

M.P. NO	PER. AC.	AC. TO BE MINED	BOND STATUS	TOTAL BOND
01-0	21.5	12.5	ACTIVE	\$46,500
02-0	32.1	26.0	ACTIVE	\$84,100

PROPERTY OWNER	MINING AREA 0'-85' H/W	SUPPORT AREA
HUGH H. SEMELBERGER	2.9 Ac.	1.7 Ac.
HUGH H. SEMELBERGER & RICHARD C. MURRAY	31.3 Ac.	8.2 Ac.
FIREMENS ASSOC. OF CAMBRIA CO.	2.5 Ac.	3.6 Ac.
THEODORE P. DEPTO	1.8 Ac.	1.6 Ac.
TOTAL	38.5 Ac.	15.1 Ac.
	53.6 Ac.	

PROPERTY OWNERS

- 1 MONTREVELLE E. WEAKLAND
- 2 FIRMAN BAILEY
- 3 JAMES D. LITZINGER
- 4 PAUL PARANISH
- 5 ADAM G. TUREK
- 6 MICHAEL A. YEAGER
- 7 JOSEPH B. SCHIRF
- 8 JACK W. SMITH, HRS.
- 9 DONALD D. SMITH
- 10 SADIE LENGLET
- 11 FRANK L. URBAIN
- 12 EDWARD J. DELARRE
- 13 CHARLES BONIN JR.
- 14 REGINALD H. YEAGER
- 15 HENRY G. CIHAN
- 16 EDWIN WARFIELD
- 17 MICHAEL T. ROBUCK
- 18 WILLIAM F. YEAGER
- 19 ELIZABETH A. SMOLKO
- 20 EMILY ANDERSON
- 21 BOBBY METRO
- 22 MARCELAIN ROPP
- 23 ELSIE HERMAN
- 24 ROBERT F. MILLER
- 25 EARROLL M. BURLEY
- 26 THEODORE GALUSCHIK
- 27 PAUL K. MILLER
- 28 GEORGE ROMAN
- 29 JAMES BAILEY
- 30 JOHN G. CHABY, HRS.
- 31 EDWARD FISANICK
- 32 RICHARD E. BURKEY
- 33 HELEN BOBBY
- 34 RALPH L. PANALI
- 35 THOMAS ZUPON
- 36 LEO J. MC COMBIE
- 37 WILLIAM R. ROPP
- 38 FIREMENS ASSOC. OF CAMBRIA CO.

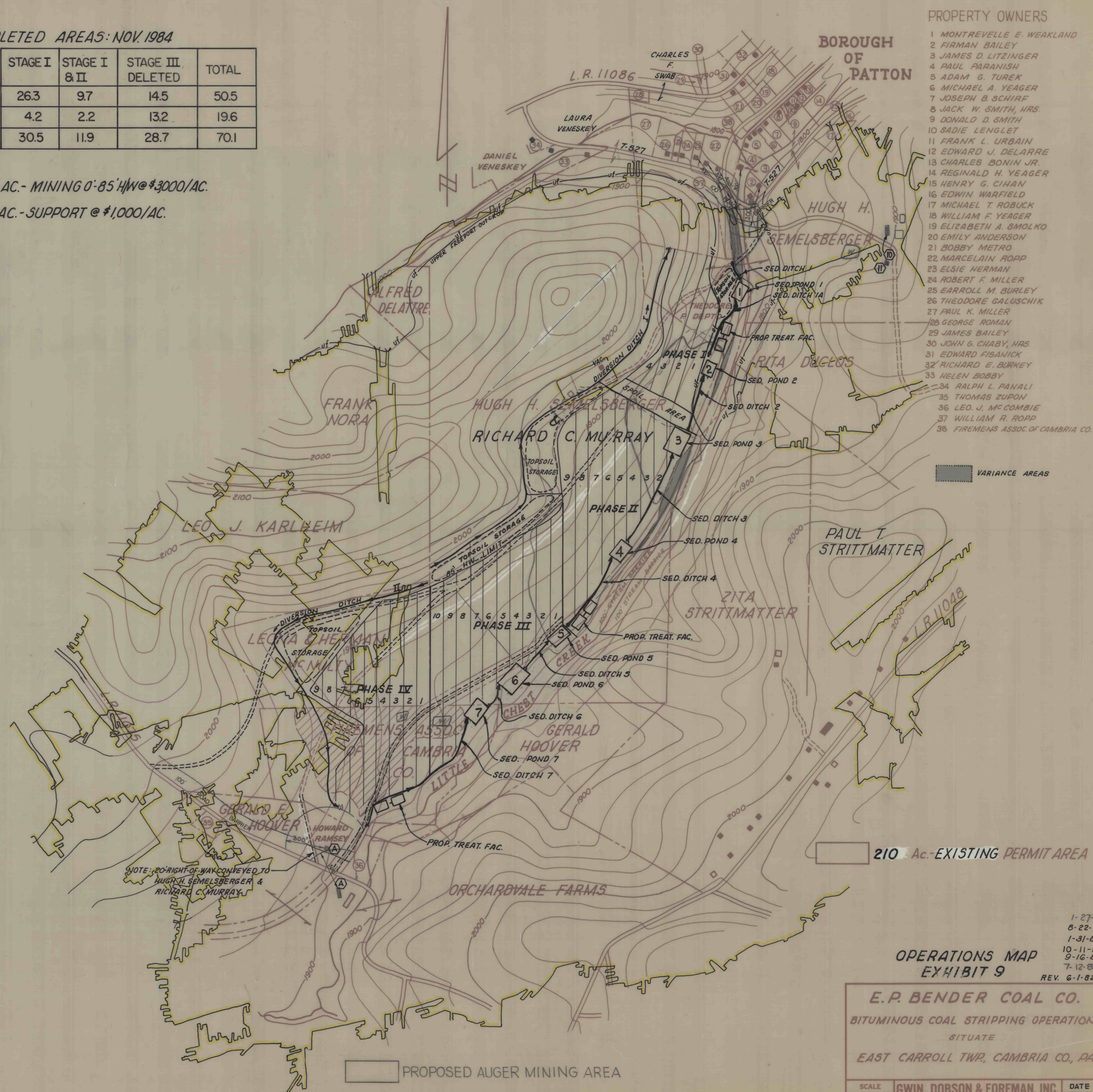

OPERATIONS MAP EXHIBIT 9
 REV. 6-1-82

E.P. BENDER COAL CO.
 BITUMINOUS COAL STRIPPING OPERATION
 SITUATE
 EAST CARROLL TWP., CAMBRIA CO., PA.

SCALE	GWIN, DOBSON & FOREMAN, INC. CONSULTING ENGINEERS ALTOONA - PENNSYLVANIA	DATE	FEB. 1982
-------	--	------	-----------

1-27-84
 8-22-83
 1-31-83
 10-11-82
 9-16-82
 7-12-82