

Fairview Twp., Chicora Quad.

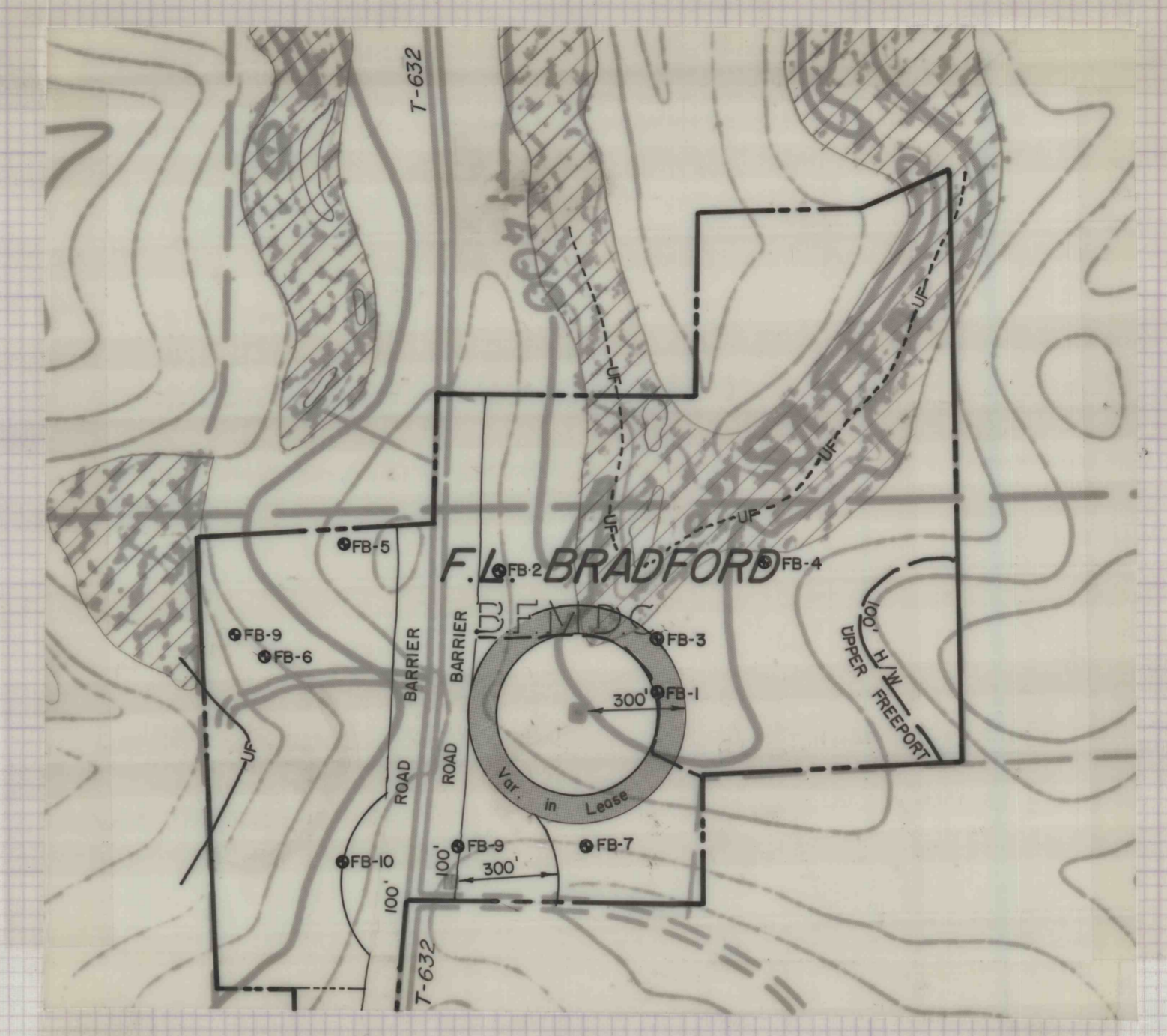

Parker & Fairview Twps., Parker Quad.

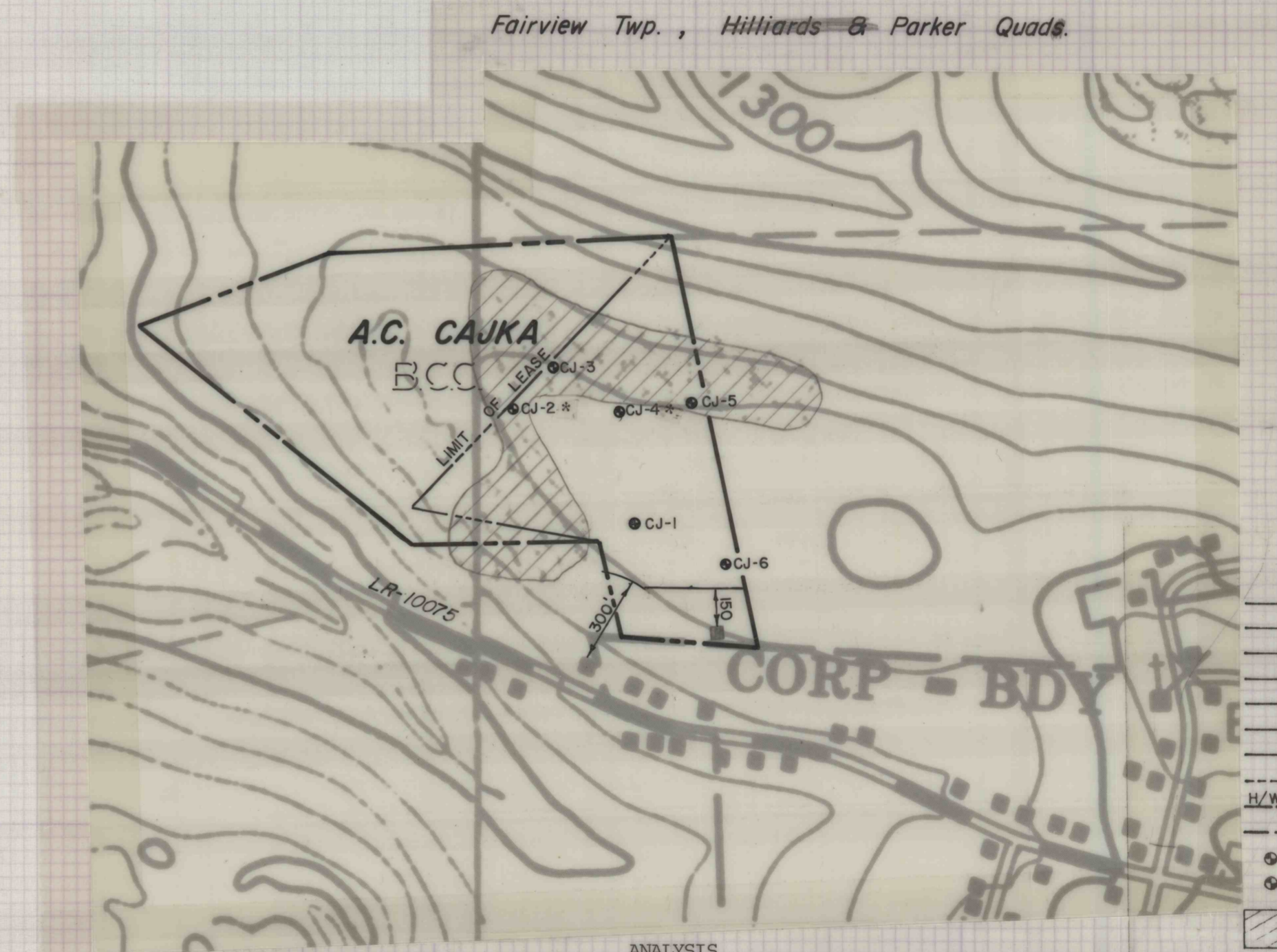
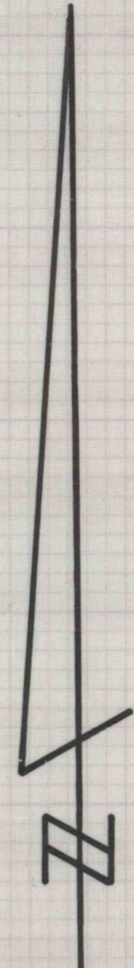

Fairview Twp., Hilliards & Parker Quads.

ANALYSIS

Hole	Seam	Ash	Sul	BTU
CJ-2	UF	7.66	3.78	13,208
CJ-4	UF	8.68	4.76	12,949

LEGEND

- UF UPPER FREEPORT OUTCROP
- LF LOWER FREEPORT OUTCROP
- UK UPPER KITTANNING OUTCROP
- MK MIDDLE KITTANNING OUTCROP
- LK LOWER KITTANNING OUTCROP
- UCL UPPER CLARION OUTCROP
- LCL LOWER CLARION OUTCROP
- UF - - - COAL AT BASE OF EXISTING HIGHWALL
- H/W HIGHWALL LIMITS USED FOR RESERVE
- LIMIT OF MINEABLE COAL
- JB-1 DRILL HOLE
- JB-1\* DRILL HOLE WITH ANALYSIS
- ▨ STRIP MINED AREA
- BARRIER AREA INCLUDED IN RESERVE
- B.F.M.D.C. PROPERTY CONTROLLED BY BLACK FOX MINING & DEVELOPMENT CORP
- B.C.C. PROPERTY CONTROLLED BY BRACKEN CONSTRUCTION COMPANY

MAP OF  
COAL PROPERTIES  
SITUATE  
BUTLER COUNTY PENNSYLVANIA  
FOR  
BLUE LINE COAL CO.

SCALE	GWIN, DOBSON & FOREMAN, INC.	SHEET NO.
1"=400'	CONSULTING ENGINEERS ALTOONA, PENNSYLVANIA	B