

MAP OF
COAL PROPERTIES
BUTLER COUNTY PENNSYLVANIA
FOR
BLUE LINE COAL CO.
GWIN, DOBSON & FOREMAN, INC. SHEET NO. 13
SCALE 1"=400'
CONSULTING ENGINEERS
ALTOONA, PENNSYLVANIA

LEGEND

- U-F — UPPER FREEPORT OUTCROP
- L-F — LOWER FREEPORT OUTCROP
- LK — UPPER KITTAUNING OUTCROP
- MK — MIDDLE KITTAUNING OUTCROP
- LK — LOWER KITTAUNING OUTCROP
- UK — UPPER CLARION OUTCROP
- UK — LOWER CLARION OUTCROP
- LCL — COAL AT BASE OF EXISTING HIGHWALL
- H/W — HIGHWALL LIMITS USED FOR RESERVE
- — — — — LIMIT OF MINABLE COAL
- JB-1 — DRILL HOLE WITH ANALYSIS
- JB-1 — DRILL HOLE
- ▨ — STRIP MINED AREA
- — BARRIER AREA INCLUDED IN RESERVE

B.F.M.D.C. PROPERTY CONTROLLED BY BLACK FOX MINING & DEVELOPMENT CORP.
B.C.C. BRACKEN CONSTRUCTION COMPANY

MP #	Acres	Notes
289-15	27.34	MP # 3078SM19A - Farrington Mine
289-18	29.90	
289-18A1	59.78	
289-18A2	25.00	
289-18A3	43.00	
289-23	25.00	
289-23A1	4.40	
289-23A2	19.00	
289-23A3	7.00	
289-23A4	12.50	
289-23A5	6.00	
289-25	25.00	
289-25A1	48.00	
289-33	22.00	
289-34	24.00	
289-15	27.34	MP # 3078SM19 - Michaels Mine
289-18	29.90	
289-18A1	59.78	
289-18A2	25.00	
289-18A3	43.00	
289-23	25.00	
289-23A1	4.40	
289-23A2	19.00	
289-23A3	7.00	
289-23A4	12.50	
289-23A5	6.00	
289-25	25.00	
289-25A1	48.00	
289-33	22.00	
289-34	24.00	
289-22	27.00	MP # 3078SM19 - Michaels Mine
289-22A1	18.25	
289-22A2	7.90	
289-22A3	17.30	
289-22A4	164.75	Affected Area - LF To be mined
289-22	27.00	MP # 3078SM19 - Michaels Mine

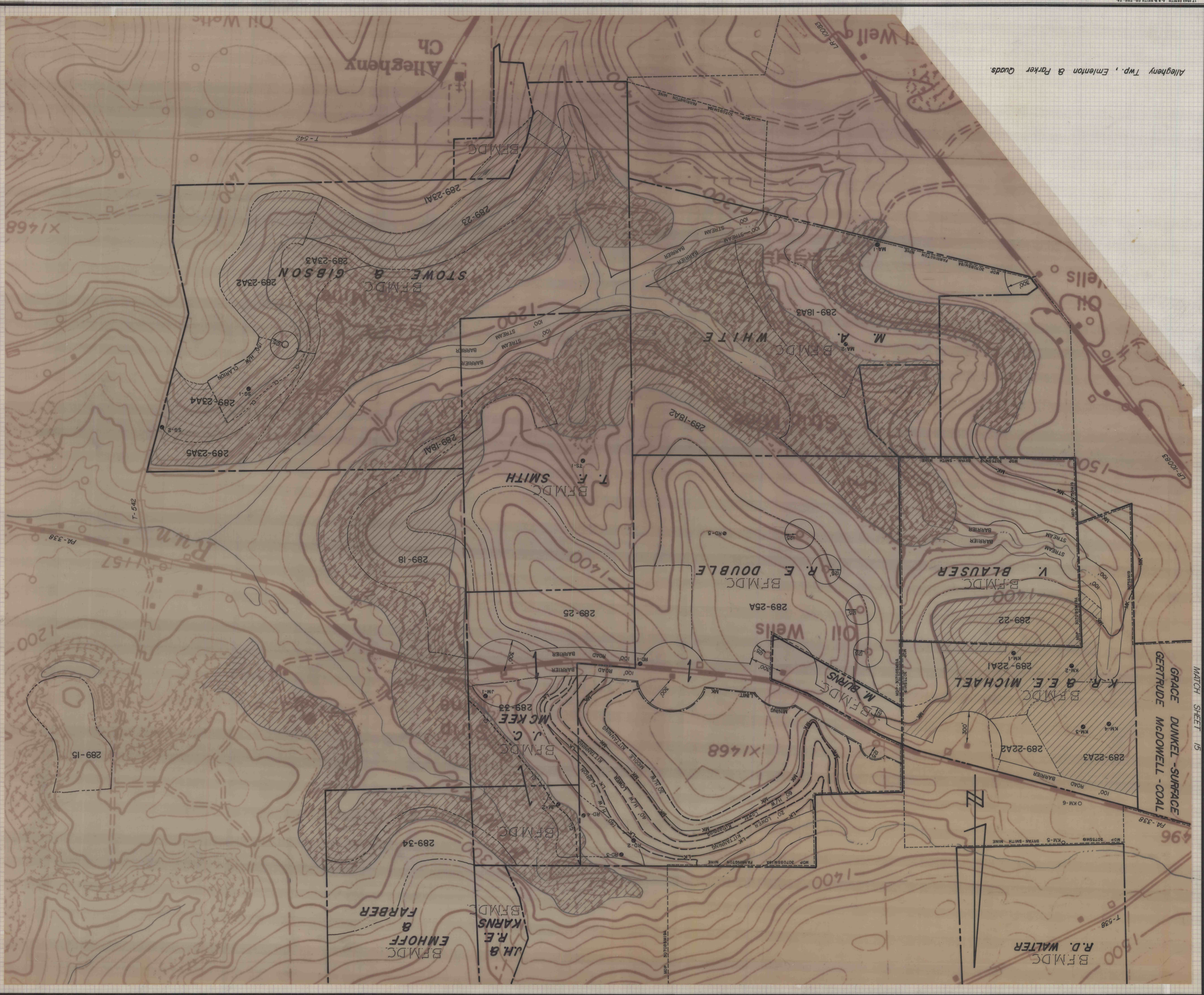

Allegheny Twp., Emlenton & Forker Quads.

MATCH SHEET 15
GRACE DUNKEL - SURFACE
GERTRUDE McDOWELL - COAL

MATCH SHEET 14