

MAP SHOWING MINING OPERATIONS

OF THE

EVERETT-BAXTON CO.

IN THE BARNETT SEAM

BROAD TOP TOWNSHIP, BEDFORD COUNTY, PA.

SCALE: 1"=100'

W.A. SILLIMAN
MINING ENGINEER
ALTOONA, PA.

OPERATED BY KEARNEY COAL CO., WILDAY GRACE - PROP.
1935 TO 1944



N2000

N1000

0

1000

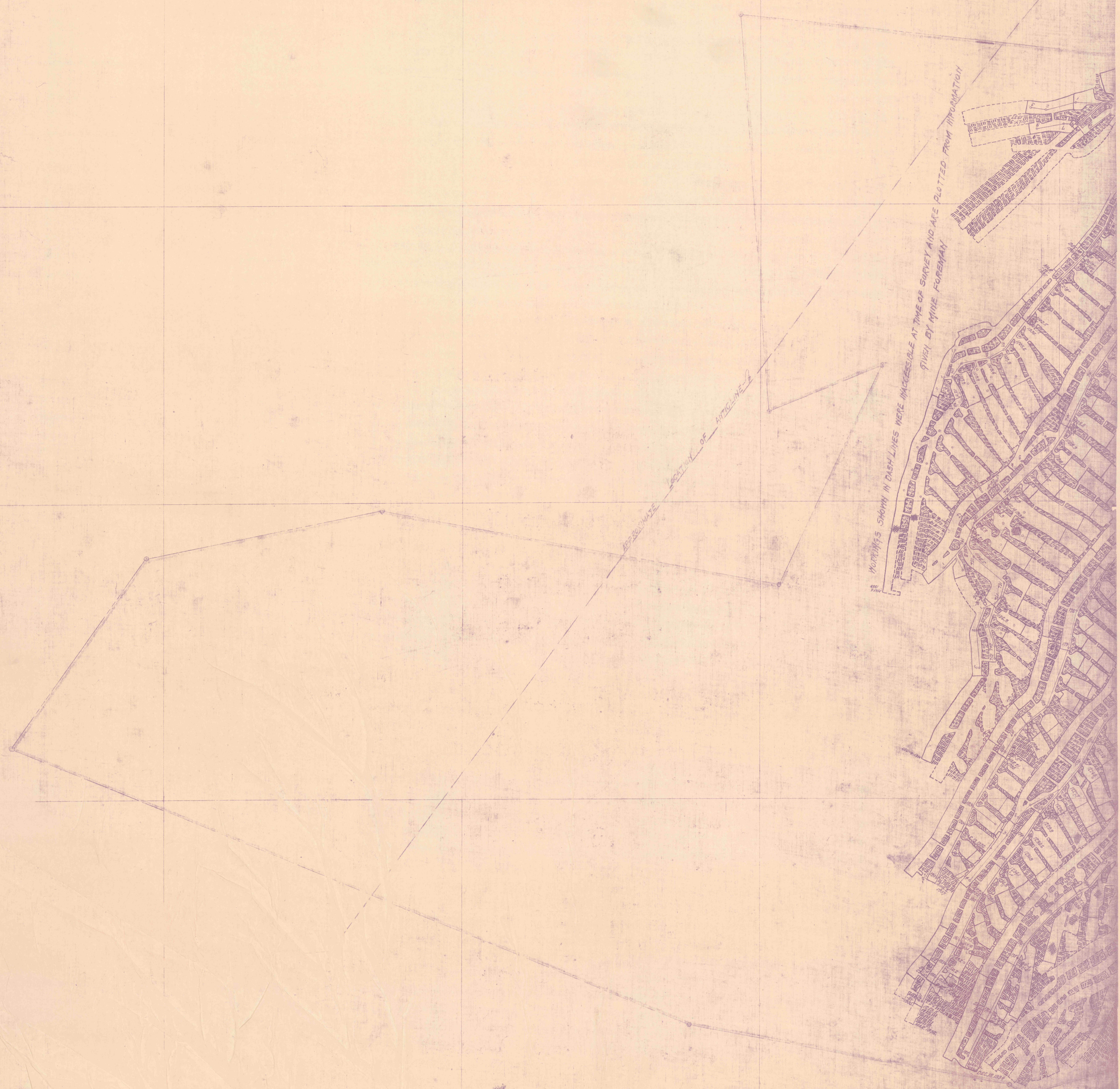

APPROXIMATE BOUNDARY OF MINELINES

WORKINGS SHOWN IN DASH LINES WERE INACCESSIBLE AT TIME OF SURVEY AND ARE PLOTTED FROM INFORMATION GIVEN BY MINE FOREMAN W.A. SILLIMAN