

There are no topographical or Sanitary features in an area of 300' radius from the Well.

STONY HOLLOW WATER WORKS

MRS. CHARLES D. PROSSER, OWNER
SIX MILE RUN, BEDFORD COUNTY, PA.

SUPPLYING WATER TO DOMESTIC CONSUMERS IN COALDALE BORO.

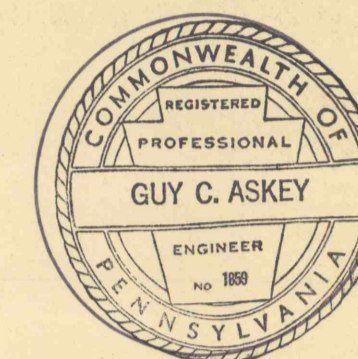

INFORMATION ON THIS MAP IS SUPPLEMENTAL TO THE REPORT AND APPLICATION FOR A PERMIT FOR THE USE OF WATER FROM WELL No. 1.

NOV. 15-1963

Guy C. Askey, P.E.
Bedford, Pa.

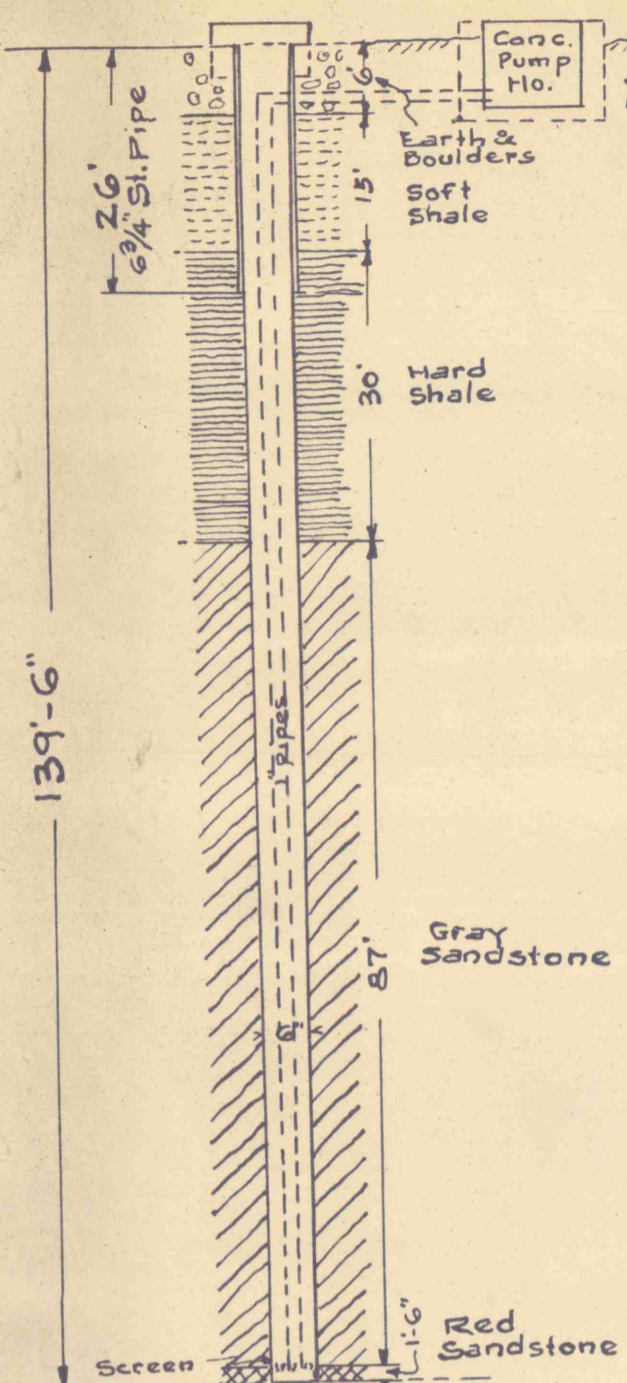

WELL No. 1
Scale: 1" = 20'

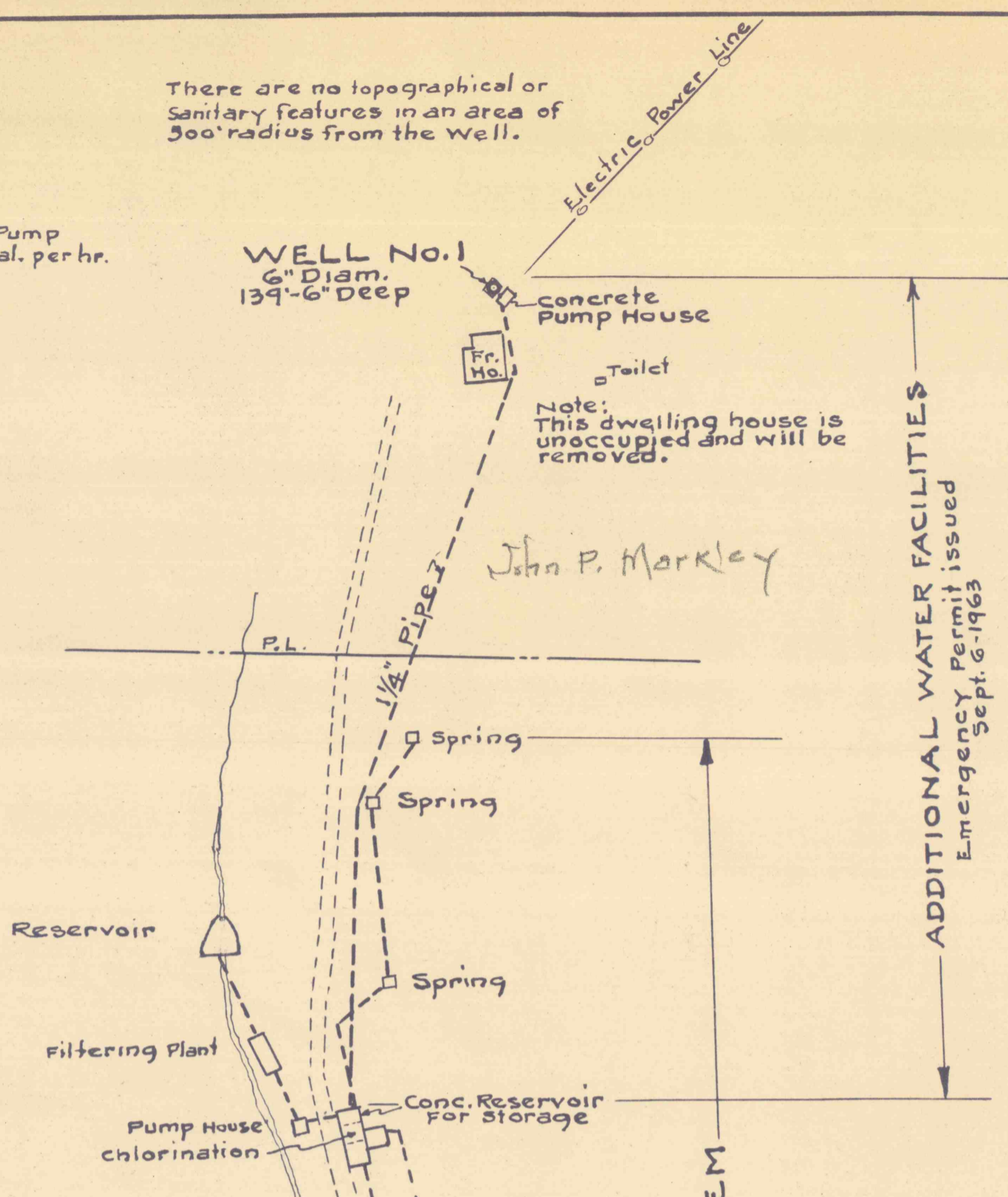

EXISTING WATER SYSTEM
Permit issued Aug. 10-1951

ADDITIONAL WATER FACILITIES
Emergency Permit issued Sept. 6-1963

John P. Markley

Note: This dwelling house is unoccupied and will be removed.

Note: Information for location of water mains, valves and connections in Coaldale Boro were obtained from an old map furnished by Mrs. C. D. Prosser.

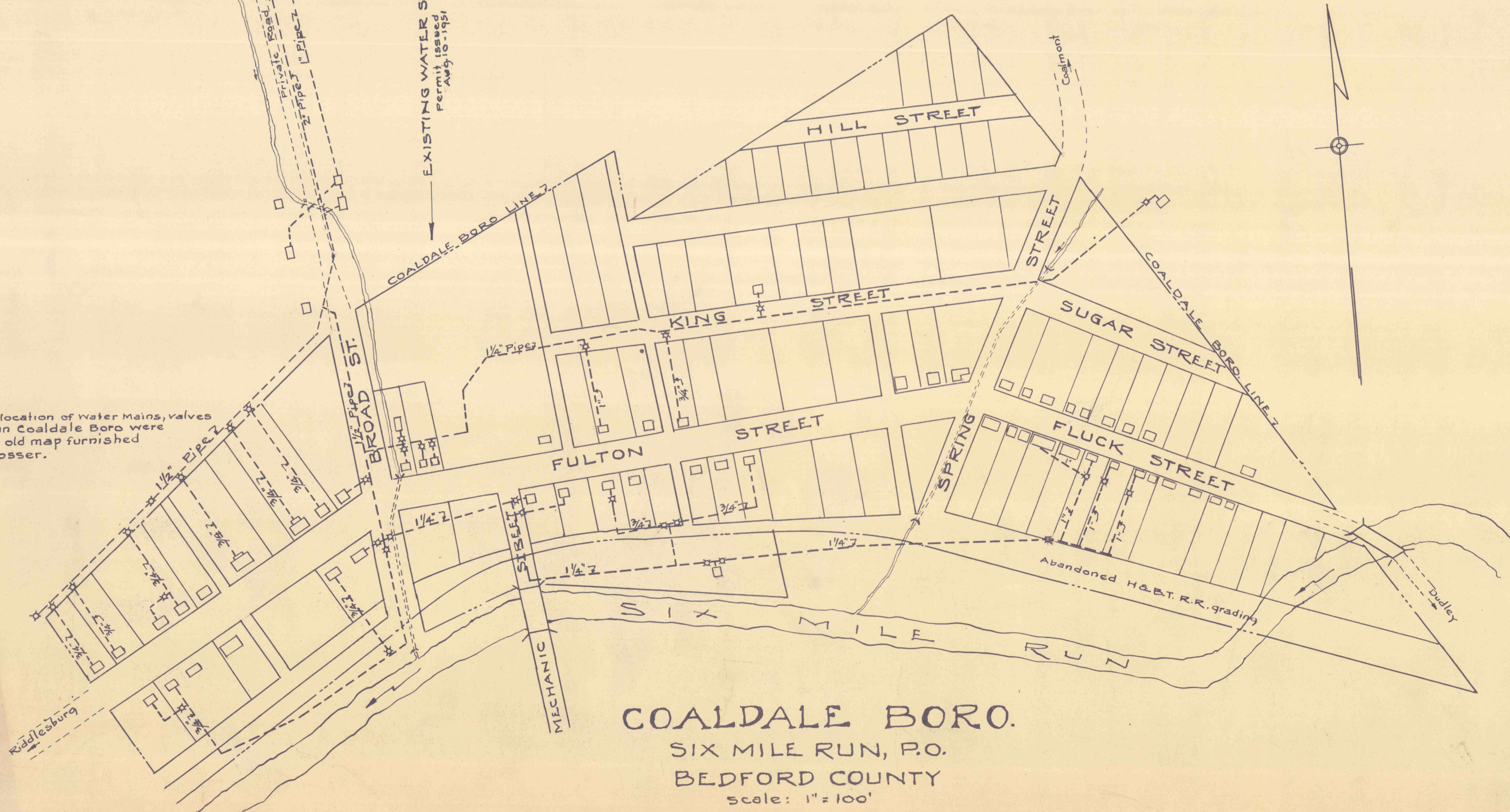

COALDALE BORO.
SIX MILE RUN, P.O.
BEDFORD COUNTY
Scale: 1" = 100'